

What Makes Up the Georgia Council of Media Organizations?

Georgia Association for Instructional Technology, Inc.

The **Georgia Association for Instructional Technology, Inc. (GAIT)** is open to all who are interested in improving education through the use of media and technology. The membership is diverse and includes public school educators, corporate trainers, vocational instructors, college media directors, university professors, library/media specialists, commercial vendors and many, many more. All unite in activities designed to expand and diversify information and communications technology to improve instruction through the systematic development, utilization and management of learning resources including people, processes and technology.

GAIT is the Georgia affiliate of the international Association for Educational Communications and Technology (AECT) [www.aect.org] Being a member of GAIT plugs one into a network of colleagues who provide one another with informal information exchange and who join together to work on various committees and activities. Because GAIT is a diverse organization, members may often interact with others outside their own work setting who share common interests in teaching, learning and technology.

GAIT Membership Benefits

GAIT Co-Sponsors (with GaCOMO) an annual joint professional development conference. The organization participates in the annual Georgia Library Legislative Day at the State Capitol; co-Sponsors, with the Georgia Library Media Association (GLMA), the Georgia Library Media Specialist of the Year Award; and co-Sponsors, with the Georgia Library Association (GLA), the Georgia Student Media Festival. Georgia annually has a large number of winners in AECT's International Student Media Festival (ISMF) which is hosted as part of the annual AECT Convention. [www.ismf.net/]

GAIT members keep current with association news and information through the **GAIT Web Connection**, an online news-letter, and GAIT website. (<http://www.gait-inc.org>)

2011 Officers

President: Sonja Fox, Gwinnett County Schools
President Elect: Pam Kelly, Fulton County Schools
Secretary: Dr. Dianne Dees, Valdosta State University
Treasurer: Leslie Wantland, Henry County Schools, Stockbridge
Past President: Melissa Underwood

Georgia Library Association

The **Georgia Library Association** is an umbrella organization encompassing members from public, school, academic, and special libraries, including professional and paraprofessional staff, public library trustees and friends of libraries. GLA was founded in 1897 for the purpose of promoting public library funding, establishing a library training program in the state, and setting up a state commission to oversee the library interests of the state. Its current focus lies along similar lines, with attention to legislative, financial, technological, and library training issues and advocacy for libraries of all types being among its chief concerns. With membership approaching 1000, GLA makes a significant impression on legislators, particularly since it represents all of the library interests in Georgia. The Georgia Library Day and the state's participation in the ALA National Library Legislation Day are major activities of the association. GLA has memberships in, is affiliated with, or sponsors the following professional organizations: the American Library Association (ALA); American Association of School Librarians (AASL); Association of College and Research Libraries (ACRL); Council of Library Administration and Management Association (LAMA); Public Library Association (PLA); Freedom to Read Foundation (FTRF); Southeastern Library Association (SELA); and Georgia Association of Media Assistants (GAMA). It can draw upon considerable resources to facilitate workshops and other training programs for librarians, media specialists, and paraprofessionals. GLA awards two scholarships annually to students enrolled in a program leading to a Master's Degree in library/information science. Noteworthy achievements of members and "lay" persons in the advancement of and advocacy for Georgia's libraries are recognized through the association's awards program. In over 100 years of existence, GLA has been instrumental in the growth of Georgia's libraries, and will continue to throughout the twenty-first century. (<http://gla.georgialibraries.org>)

2011 Officers

President: Carolyn Fuller, Henry County Public Library System
1st Vice-President/Elect: Elizabeth Bagley, Director, McCain Library System, Agnes Scott College
2nd Vice-President: Kim Eccles, Associate Director, Monroe F. Swiley, Jr. Library, Mercer University Atlanta
Secretary: Debbie Holmes, Director, Gould Memorial Library System, College of Coastal Georgia
Treasurer: Cathy Jeffrey, Associate Dean of Libraries, Clayton State University

Georgia Library Media Association, Inc.

The **Georgia Library Media Association** dates back to 1930 when the Department of School Libraries of the Georgia Education Association was formed. In 1947 the Children's and Young People's Section of GLA and the Georgia Education Association joined together to foster library services to schools and children, and this union continued until 1970, when the Georgia Library Media Department (GLMD) of the Georgia Association of Education (GAE) was formed. In 1975 the Georgia Educational Media Association and the Georgia Library Media Department merged as GLMD, and in 1988 the organization separated from the GAE and reorganized as the current GLMA. It became incorporated in 1993, and continues as the largest professional organization serving school library media professionals in Georgia. Our members are dedicated to the advancement and empowerment of school library media specialists and to promote the nine literacy standards for student learning as stated in Information Power Building Partnerships for Learning by ALA. GLMA a state affiliate of the American Association of School Librarians (AASL), a division of the American Library Association and GLMA, Inc. is affiliated with the Georgia Association of Educators (GAE).

What does GLMA do for our members?

- GLMA represents your interest in an active liaison and advisory role with other state library organizations and with national and regional professional organizations.
- GLMA supports your professional development by keeping you in touch with current trends and issues in the profession.
- GLMA gives school media specialists a voice in the Georgia legislature and the State Board of Education through the Governmental Relations Committee, and through networking of GLMA members.
- GLMA maintains a web site and publishes an online newsletter to keep our members informed of issues concerning our organization and profession.
- GLMA uses the Georgia Media Listserv to have ongoing discussions on topics of interest to all library media specialists.
- GLMA presents district meetings that provide an opportunity for each member to become involved in the organization by holding office, serving on various committees and being able to present at conferences.
- GLMA participates in an annual conference (GaCOMO) that provides quality programs and outstanding speakers to provide ongoing professional learning experiences for Library Media Specialists.

- GLMA presents the Summer Leadership Conference in which media specialists contribute to updating the documents used by Library Media Specialists throughout the state. It also provides exciting professional learning and networking opportunities.
- GLMA recognizes professional excellence by presenting awards for outstanding service such as the Media Specialist of the Year Award, the Freedom of Information Award, and Mini-Grants.
- GLMA sponsors the state-wide Helen Ruffin Reading Bowl, a successful reading competition that encourages teams of students to engage in award-winning books.
- GLMA supports the Georgia Peach Teen Book Award with the state's public libraries.
- GLMA supports Library Media Specialists who are National Board Certification Candidates.

2011 Officers

President: Betsy Razza, DeKalb County Schools

President-Elect: Karen White, Fulton County Schools

Treasurer: Media Daniels, Atlanta Public Schools

Secretary: Beth Miller, Fulton County Schools

Past President: Valerie Ayer, DeKalb County Schools

A Word of Welcome...

Welcome to Georgia COMO XXIII!!

Thank you for joining the 23rd annual collaboration of the Georgia Association for Instructional Technology, Georgia Library Media Association, and Georgia Library Association. We hope that our annual state conference will provide inspiration and education for our diverse attendees. There is an impressive selection of keynote presentations, peer concurrent sessions, authors, and exhibits for all.

The GaCOMO XXIII Steering Committee invites you to take advantage of the wide variety of activities featured during the conference. Kicking off the conference Wednesday night will be Library Movie Night. We will be showing a free movie, *Storm Center*. Set and produced in the 1950's, the main character, a librarian, is branded a communist when she refuses to remove a book about communism from her library in this anti-McCarthyism film. Free prizes and movie munchies will be provided.

Thursday begins with our Exhibits Only time from 8:00 until 9:00 a.m. Our Opening General Session keynote speaker will be Cliff Landis addressing the topic of how changes in policy, culture and technology are determining the future of libraries. We will have two days of informative and stimulating presentations, organizational award dinners and luncheons, Authors' Reception, and exhibits. Our Closing General Session keynote speaker will be an engaging address from Dr. John Barge, Georgia's Superintendent of Education. The GLA Scholarship Raffle extravaganza will be kicked off with lively demonstrations by Georgia's Book Cart Drill Teams.

Take time to network with old friends and introduce yourself to new ones.

COMO XXIII presents many opportunities to listen, learn, inquire and network that will help you leave Athens with new ideas and strategies to improve your knowledge and spark your enthusiasm.

Betsy Razza, GLMA President, GaCOMO XXIII Chair

Featured Speakers

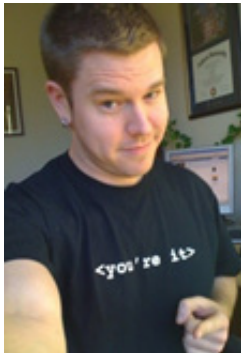

Cliff Landis is the Web Services Librarian at Georgia State University Library in beautiful downtown Atlanta. He is also a researcher, author and speaker on the role of emerging technologies in libraries, social network sites, user-centered service, assessment, and the co-evolution of humanity and technology. Cliff has a diverse range of interests both within and outside of the library field, which help inform his unique perspective on the future of libraries.



Dr. John Barge, Georgia's Superintendent of Education, lives in Floyd County with his wife and two daughters. He has served as a life-long educator in Georgia. In his 20 years in education, Dr. Barge has worked as a high school English teacher, middle school Spanish teacher, assistant principal, principal, and as state Director of Career, Technical and Agriculture Education for the Georgia Department of Education. Dr. Barge has earned three advanced degrees, a master's degree and a specialist's degree from the State University of West Georgia and his doctorate degree in educational leadership from the University of Georgia. He has been recognized as a STAR teacher, as Georgia's Assistant Principal of the Year and as a recipient of the Berry College Alumni Association's Distinguished Achievement Award in 2005.

In January 2011, Dr. Barge was sworn into office as Georgia's 21st State School Superintendent. He is keenly aware of the challenges that Georgia faces as a state and the challenges our students, teachers and local administrators are facing. He is committed to ensuring that the Georgia Department of Education is a service agency that communicates directly with educators in local districts to improve education in Georgia as he seeks to build a strong foundation to benefit our students, teachers and communities.

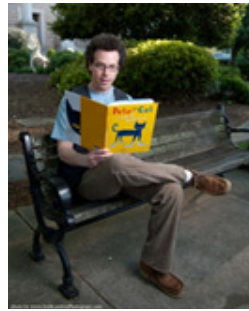

Mr. Eric (Eric Litwin): Eric is a guitar strumming, book writing, harmonica blowing, banjo picking, song singing, five time national award winning, folksy fun type of guy. He is a New York Times Best Selling author of "Pete the Cat, I Love my White Shoes", published by Harper Collins. Mr. Eric is a popular performing artist focusing on participatory music and interactive literacy. He has played at Lincoln Center as well as schools and libraries across the country. Mr. Eric has recorded several award winning children's music CDs. He is the co-creator of The Learning Groove which offers parent and child music classes. Mr. Eric likes cats, music, books and coffee. You can visit him online at www.ericlitwin.com



James Dean is an accomplished artist, the creator of the lovable Pete the Cat and a New York Times Best Selling Artist of Pete the Cat I Love My White Shoes. He graduated from Auburn University with a degree in electrical engineering in 1982. He had always wanted to study art but was afraid that he would not be able to make a living as an artist. While working as an engineer, he began to draw in his spare time. Eventually he left engineering to pursue art. He never dreamed that he would be spending most of his time drawing pictures of a cat. He and his wife, Kim, who is a sculptor, spend their days working as artist. You can visit him online at www.petethecat.com

General Information

Pre-Conference Workshops

There will be two pre-conference tours. "Maps in the UGA Libraries: a Tour of the Collections" will take place 12:30-4 p.m. Participants are to meet at UGA Main Library lobby at 12:30 p.m., and the "Tour of the Digital Library of Georgia." Will be held from 2-3, meeting at UGA Main Library lobby at 2 p.m. Transportation from the Main Library to the Map Library and DLG and back will be provided.

Exhibits

Exhibits are located in the Grand Hall on the lower level of the main building at The Classic Center. Exhibits are open Thursday from 8:00 a.m. – 5:00 p.m. and Friday from 8:00 a.m. – 11:00 a.m. "Exhibits Only" times are scheduled for Thursday, 8:00 – 9:50 a.m., 3:30 – 4:20 p.m., and Friday, 10:00 – 10:50 a.m. Plan to spend some quality time with these vendors. They are extremely important to the success of this conference, and they have a lot to show you! Your badge is required to enter the Exhibits Hall. Guest Badges are available for \$15.00 each at the Registration Desk in the Fire Hall.

General Sessions and Concurrent Sessions

Wednesday's "Library Movie Night" and the Opening and Closing General Sessions will be held in the Athena Ballrooms E & F.. Concurrent Sessions are scheduled in the meeting rooms of the Classic Center. Please refer to the floor plan/map.

Meals and Meal Tickets

All meals are ticketed functions, and no tickets will be sold on site. See Conference Overview for meal times and locations.

Author Reception

A number of noted authors will be available to autograph their books at the Authors Reception on Thursday following the 4th Concurrent Session of Programs. Copies of their books may be available for sale at the time. Guest passes are available for \$15.00 each and will provide admission to the Authors' Reception. The event will be held in the Exhibits (Grand Hall).

Badges

Your Conference Badge is required for admittance at all Conference Sessions and Events. Non-registrants will not be admitted. Guest Badges for Exhibits only and Guest Badges of the Authors' Reception will be sold at the Registration Desk in the Fire Hall.

Information, Messages, Etc.

A message board is provided for your convenience at the Registration Desk. Ask the Desk for note paper and push pins. Announcements of meeting rooms and schedule changes will also be posted here. Check the Board frequently.

GLA Scholarship Raffle Booth Located in the Exhibits (Grand Hall)

The GLA Scholarship Raffle Booth will be in the Exhibit Hall on Thursday from 8:00 a.m. – 5:00 p.m. and Friday from 8:00 a.m. – 1:00 p.m. The Drawing will begin at 1:30 on Friday. Plan to stop by between sessions to view items such as gift baskets, art, etc., and BUY your lucky tickets. To save yourself from printing your name 10 times on raffle tickets, remember to bring adhesive labels with your name and home address on them. Proceeds from this annual raffle support two GLA scholarships for library graduate programs.

Conference Overview

Wednesday October 5

11:30 a.m. - 3:00 p.m.

2:00 p.m. - 7:15 p.m.

5:30 p.m. - 7:00 p.m.

5:30 p.m. - 7:00 p.m.

7:15 p.m. - Until

Thursday, October 6

6:00 a.m. - Until

8:00 a.m. - 4:20 p.m.

8:00 a.m. - 5:00 p.m.

8:00 a.m. - 9:00 a.m.

9:00 a.m. - 9:50 a.m.

10:00 a.m. - 10:50 a.m.

11:00 a.m. - 11:50 a.m.

12:00 p.m. - 1:20 p.m.

1:30 p.m. - 2:20 p.m.

2:30 p.m. - 3:20 p.m.

3:30 p.m. - 4:20 p.m.

4:30 p.m. - 5:20 p.m.

5:30 p.m. - 7:00 p.m.

7:00 p.m. - 9:30 p.m.

7:00 p.m. - 9:30 p.m.

Friday, October 7

8:00 a.m. - 8:50 a.m.

8:00 a.m. - 10:00 a.m.

8:00 a.m. - 11:00 p.m.

9:00 a.m. - 9:50 a.m.

10:00 a.m. - 10:50 a.m.

11:00 a.m. - 11:50 a.m.

12:00 p.m. - 12:50 p.m.

1:00 p.m. - 1:20 p.m.

1:30 p.m. - 2:20 p.m.

GALILEO Lunch and Learn and GALILEO Choice Digital Content UGA
Campus 2500 Daniells Bridge Road, Building 300, Athens, GA

Registration

New Attendees Dutch Treat Dinner and Meeting at Casa Mia, 269 N. Hull
Street, Athens, Georgia

GLA Interest Group Council Dutch-Treat Dinner and Meeting at The Globe
Library Movie Night – Athena Ballroom E & F

Pat Carterette Memorial Run/Walk – Meet in front of The Classic Center

Registration

Exhibits Open

Exhibits Only (Chick-Fil-A Breakfast Items to be sold)

Opening General Session with Cliff Landis - Athena Ballrooms E & F

Concurrent Sessions 1

Concurrent Sessions 2

Luncheons

GLMA/GAIT/GLA School Library K-12 Luncheon (Ticketed Event)

Empire

GLA Academic & Public Library Division Luncheon (Ticketed Event)

Oconee

Concurrent Sessions 3

Concurrent Sessions 4

Exhibits

2nd General Session Eric Litwin & James Dean - Athena Ballrooms E & F

Authors' Reception Exhibits (Grand Hall)

GLA Awards Banquet with Battledecks Competition Preceding (Ticketed
Event Athena Ballrooms E & F

GLMA Business Meeting and Dinner (Ticketed Event) Parthenon 1

GAIT Breakfast (Ticketed Event) Parthenon Room 2

Registration

Exhibits Open

Concurrent Sessions 5

Exhibits Only

Concurrent Sessions 6

State School Superintendent Dr. John Barge Athena Ballrooms E & F

Book Cart Drill Team Demo Athena Ballrooms E & F

GLA Scholarship Raffle Drawing Exhibit Hall (Lunch available for
purchase)



Pre-Conference Workshops & Meetings -- Wednesday

Wednesday, October 5 11:30AM - 3:00PM

Get the Most out of GALILEO: Customizing Your Library Site with GALILEO Links and Tools (E)

Location: GALILEO Offices

Come find out how to better integrate GALILEO and GALILEO tools into your library website, online courses, and library guides.

Presenter(s): Katie Gohn

katie.gohn@usg.edu

Planning a "Getting Started with Genealogy" Class for Your Patrons (E)

Location: GALILEO Offices

Tips on presenting a genealogy class at your library, including planning, development, marketing, and incorporating GALILEO databases

Presenter(s): Karen Minton, Laura Carter

karen.minton@usg.edu

Security on Your Mobile Device (E)

Location: GALILEO Offices

Stan Gatewood, Chief Information Security Office, Information Technology Services, Board of Regents of the University System of Georgia addresses security threats and risk of smart devices.

Presenter(s): Stan Gatewood

deborah.shackelford@usg.edu

Showing Value with GALILEO Statistics (E)

Location: GALILEO Offices

This session will show the inner workings of how GALILEO collects, manages and reports usage statistics. It will also demonstrate different ways to present usage data for accountability purposes.

Presenter(s): Ken Henslee

ken.henslee@usg.edu

What's New In GALILEO? (E)

Location: GALILEO Offices

Come find out what's new in GALILEO.

Presenter(s): Katie Gohn

deborah.shackelford@usg.edu

Your Patrons and GALILEO (E)

Location: GALILEO Offices

Learn strategies for guiding your patrons through GALILEO resources, whether you're helping them with a homework assignment or reference question or presenting a class.

Presenter(s): Karen Minton, Jay Turner

karen.minton@usg.edu

Wednesday, October 5 1:00PM - 4:00PM

GLA Executive Board Meeting and Lunch

Location: Athena H

GLA Executive Board

Wednesday, October 5 2:00PM - 7:15PM

Registration (E)

Location: Fire Hall

Wednesday, October 5 5:30PM - 7:00PM

GLA Interest Group Council Meeting and Dutch-Treat Dinner

Location: The Globe, Downtown, 199 N Lumpkin St

GLA Interest Group Council

New Attendees Dutch-Treat Dinner and Meeting

Location: Casa Mia, 269 N. Hull St.

New Attendees/Assoc. Officers

Wednesday, October 5 7:15PM - 10:00PM

Library Movie Night ("Storm Center") (E)

Location: Athena E/F

Legend: E=Everyone; AL=Academic Librarians; PL= Public Librarians; G = General; IT = Instructional Technologist;
ES = Elementary School Library Media Specialist; MS = Middle School Library Media Specialist; HS = High School Library Media Specialist

Georgia Council of Media Organizations 2011 Conference - Athens, GA

7

Wednesday, October 5, 2011; Pre-Conference Tours, Workshops, Meeting

Room/Time	11:30 am - 12:50 pm	1:00 pm - 1:50 pm	2:00 pm - 3:00 pm	3:00 pm - 3:50 pm	4:00 pm - 4:50 pm	5:30 pm - 7:00 pm	7:15 pm - Until
Fire Hall			Registration (Until 7:15 p.m.)				
Athena Ballroom E							Library Movie Night: "Storm Center"
Athena Ballroom F							
Athena Ballroom H		GLA Executive Board Meeting and Lunch					
GALILEO Offices 2500 Daniells Bridge Rd. Bldg 300	GALILEO: Pre-Conference Sessions - Lunch and Learn "Security on Your Mobile Device" "What's New in GALILEO?" "Your Patrons and GALILEO" "Showing Value with GALILEO Statistics" "Planning a 'Get Started with Genealogy Class'" "Get the Most Out of GALILEO"						
The Globe Downtown Athens (199 N Lumpkin St)						GLA Interest Group Council Dutch-Treat Dinner and Meeting	
Casa Mia (269 N. Hull St.)						New Attendees Dutch-Treat Dinner and Meeting	

We invite you to take part in the Pat Carterette Memorial Run/Walk.

6:00 a.m., Thursday, October 6

Meet in front of The Classic Center.



Georgia Council of Media Organizations 2011 Conference - Athens, GA

Thursday, October 8, 2009 - 7:30 AM - 1:20 PM

Room/Time	8:00 am - 8:50 am	9:00 am - 9:50 am	10:00 am - 10:50 am	11:00 am - 11:50 am	12:00 pm - 1:20 pm
Grand Halls	Exhibits Only (Chick-fil-A breakfast items for sale) and GLA Scholarship Raffle Sales	Exhibits and GLA Scholarship Raffle Sales			
Fire Hall	Registration				
Athena Ballroom E		Opening General Session w/Cliff Landis			
Athena Ballroom F					
Athena Ballroom A				Accounting and Budgeting for the Non-accountant	
Athena Ballroom B			Georgia Student Media Festival Showcase & Updates	How to Create Award-Winning Elementary Media Festival Entries	
Athena Ballroom C			What's New In GALILEO	Using Library Manager to Engage Students	
Athena Ballroom D			Oh Where, Oh Where Has All the Cache Gone: The Basics of Educaching	PAWS for READING	
Athena Ballroom G			Special Collaboration: The Recipe for Successful Partnerships Between School Librarians & Special Educators	Community Contacts & Digital Collections: Using Your Unique Collections to Collaborate	
Athena Ballroom H			Georgia Peach Book Award for Teen Readers- 2011-12 Nominees	Grab GALILEO for Great Multimedia Projects	
Athena Ballroom I			Pick a Peck of Picture Books	Georgia Libraries: An Illustrated History	
Athena Ballroom J			Building a Green Library: Lessons Learned from Three Georgia Academic Libraries	One-Size Fits No One: Unique Embedded Librarian Programs in Georgia Universities	
Olympia 1			GLA Academic Papers Awards		
Olympia 2			Ask Technical Services Bus. Mtg.	Acquisitions Roundtable- Best Practices for the	
Parthenon Room 1			Using Cognitive Theories in the Library Instruction Session	GLMA & GAIT Library Media Specialist of the Year Panel	
Parthenon Room 2			DOE Update. What's the latest news from the Georgia Department of Education?	An Overview of a Planning Guide for Empowering Learners	
Empire Room 1					GLMA/GAIT/GLA School Library K-12 Lunch Buffet (Ticketed)
Empire Room 2					
Willow Room			Leveraging Bite-Size Video for Learning	Reference Services to Special Populations Using LearnCentral Vrooms	
Oconee River Room 1					GLA Academic and Public Library Division Lunch Buffet (Ticketed)
Oconee River Room 2					
High Shoals Room 1			Perfect Pathfinders for Every Purpose	Book Trailers and How to Use Them in a Media Program	
High Shoals Room 2			First Year in the Trenches: Challenges and Insights from New Librarians	Resume Review Clinic	
Cypress Room 1			Win-Win: Communications Scenarios at the Library	Using Information Society Theory In Library Advocacy & Decision	
Cypress Room 2			Smart Phones, Apps and Libraries		

Thursday, October 8, 2009 - 1:30 PM - 9:30 PM

Room/Time	1:30 pm - 2:20 pm	2:30 pm - 3:20 pm	3:30 pm - 4:20 pm	4:30 pm - 5:20 pm	5:30 pm - 7:00 pm	7:00 pm - 9:30 pm
Grand Halls	Exhibits and GLA Scholarship Raffle Ticket Sales		Exhibits Only and Raffle Sales	Exhibits Until 5:00 pm; Raffle Sales Until 5:20	Authors' Reception	
Fire Hall	Registration					
Athena Ballroom E	"Lost in the Stacks:" The Research Library Rock n Roll Show	Ascending into the Cloud: Covenant College's Migration to OCLC's New Web-Scale Management Services System		Second General Session w/ Eric Litwin and James Dean		GLA Awards Banquet with Battledecks Competition Preceding (Ticketed)
Athena Ballroom F	We Hear You: Successful Strategies for Marketing, Implementing & Analyzing a LibQUAL Survey	Reference Services Interest Group				
Athena Ballroom A	Strengthen Your Community From the Library	Profile Your Network: Use Salary Surveys for Job Description Analysis				
Athena Ballroom B	Professional Development Planning for Public Library Staff; GALILEO Included	Make Media Center Presentations Pop With Multimedia!				
Athena Ballroom C		Navigating the Job Search Process				
Athena Ballroom D	5-G Instruction: Get Ready, Get Set, Get Online, Get Busy, Go!	How Libraries Are Supporting and Promoting Undergraduate Research				
Athena Ballroom G	Leveraging Bite-Size Video for Learning	Creating A Relationship Between Schools and Public Libraries				
Athena Ballroom H	Read Alouds That Rock Across the Curriculum!	When Your Library Is Not a Library: Capturing the Functionality of Your Space				
Athena Ballroom I	Trends in Faculty Roles, Promotion and Tenure: A Discussion					
Athena Ballroom J	Don't Go Crazy: Finding and Using E-Books and Online Databases	Using Primary Sources for Multimedia Literacy				
Olympia 1	Panel Discussion on Serials Management					
Olympia 2		Exploring Newspapers In GALILEO				
Parthenon Room 1	Law and Reference : Answering Legal Reference Questions	Literacy and Reading for the 21st Century Learner				GLMA Business Meeting and Dinner (Ticketed)
Parthenon Room 2	Recruiting, Training, Retaining Volunteers for a Successful Helen Ruffin Reading Bowl	How Do iPads Impact Early Childhood Engagement & Emerging Literacy Skills During a Public Library's Storytime?				
Empire Room 1						
Empire Room 2						
Willow Room		Making the Leap: Transitioning from Paraprofessional to Professional Librarian				
Oconee River Room 1						
Oconee River Room 2						
High Shoals Room 1	Rolling in the Deep Web: Mining Free Resources for Science and Technology Information	Comics and Graphic Novels as Academic Literature (Moving Beyond the Kitsch)				
High Shoals Room 2	GALILEO Advocacy	Maximizing Your Social Media Presence: Tools & Tips to Save You Time & Effort				
Cypress Room 1	Recipe for a Great Storytime: Spice It Up With Tech Tools	Out With the Old & In With the New: Reinventing Yourself				
Cypress Room 2	Powerful Untapped Consumer Health Resources	OCLC, Web-scale Management Services, and a New Platform for Interlibrary Loan				

Friday, October 9, 2009 - 8:00 AM - 2:20 PM

Room/Time	8:00 am - 8:50 am	9:00 am - 9:50 am	10:00 am - 10:50 am	11:00 am - 11:50 am	12:00 pm - 12:50 pm	1:00 pm - 1:20 pm	1:30 pm - 2:20 pm
Grand Halls	Exhibits and GLA Scholarship Raffle Ticket Sales		Exhibits Only and GLA Scholarship Raffle Ticket	GLA Scholarship Raffle Ticket Sales			GLA Scholarship Raffle Drawing (Lunch for Pur.)
Fire Hall	Registration						
Athena Ballroom E					Closing Gen Sess w/ First Lady Sandra Deal and State Sch Supt Dr. John Barge	Book Cart Drill Team Demo	
Athena Ballroom F							
Athena Ballroom A		Taking the Leap: Moving From Hardware Solutions to Cloud Computing		Gaining Perspective: A User Discussion of E-Books from Professional to			
Athena Ballroom B		MLIS Faculty Research in Progress at Valdosta State University		Great Student Employees, Not A Myth! Creating a Student Employee Program That Works for the Library, the Students, and You			
Athena Ballroom C		Library Instruction...It's Just an iClick Away		PRIME TIME Family Reading Time: Program			
Athena Ballroom D		What In the "Library" Are You Doing? A Discussion of Survey Results From Library Users at Georgia		License Agreement Red Flags			
Athena Ballroom G		Money Smart Week @ Your Library (April 21-28,		Georgia Children's Picture Storybook Award 2012: And			
Athena Ballroom H		Tapping Into a Technical College's Best Resource: Its Students		Two-Faced Faculty Member: Juggling Librarianship and Teaching in an Academic Setting			
Athena Ballroom I		The Redesigned 21st Century K-12 Media Center		Moving to the Cloud: One Library's Story of Implementing OCLC's Web Management System			
Athena Ballroom J		GLMA Mable Wyche Underwood Grant Winners Presentation		Giving Them What They Want, Not What We Assume They Need: User-Centric Development of a Mobile Library Website			
Olympia 1		Showing Value With GALILEO Statistics		System Level Media Coordinators Meeting			
Olympia 2				Government Information Interest Group			
Parthenon Room 1				Weeding and Donations: A Panel Discussion			
Parthenon Room 2	GAIT Breakfast (Ticketed)			Assessment of Student Learning in Academic Library & Archival Teaching/BI Programs			
Empire Room 1		Working Inside the Box: Innovative LibGuide		The Resourceful Librarian's Guide to Electronic			
Empire Room 2		Promoting Literacy Through Reading		Searching For Treasure in Georgia's Virtual Vault			
Willow Room		PBCore 2.0: Understanding an Updated Metadata					
Oconee River Room 1		Meeting Users' Expectations Through Resource Sharing		Using Technology to Improve Reference Service & Statistics Gathering			
Oconee River Room 2		Value of Social Tagging By Subject Area		Keeping Up The Circulation!			
High Shoals Room 1		Thinking Outside the Box: Strategies for Managing Library-Community		Stepping Up the Ladder: "Next Gen" Leadership in the 21st Century			
High Shoals Room 2		The EPUB Standard and School Library Media Centers		Inviting the World Into Your School Library: Using Web 2.0 Tools for Teaching and			
Cypress Room 1		Usage and Identity for the Branch Library		Panel Discussion: The Impact of RDA on Georgia's Libraries			
Cypress Room 2		The Fundamentals of RDA		Empowering Voices: Communities Speak Out for			

COMO 2011 Concurrent Sessions

Thursday, October 6 6:00 AM -

Pat Carterette Memorial Walk/Run (E)

Location: Meet in front of The Classic Center

Thursday, October 6 10:00AM - 10:50AM

Exhibits (E)

Location: Grand Halls

Thursday, October 6 8:00 AM - 8:50 AM

Exhibits Only

(Chick-fil-A breakfast items for sale) (E)

Location: Grand Halls

Thursday, October 6 8:00 AM - 4:20 PM

Registration (E)

Location: Fire Hall

Thursday, October 6 8:00 AM - 5:00 PM

Exhibits (E)

Location: Grand Halls

Thursday, October 6 8:00 AM - 7:00 PM

GLA Scholarship Raffle Ticket Sales (E)

Location: Grand Halls

Thursday, October 6 9:00 AM - 9:50 AM

Exhibits (E)

Location: Grand Halls

OPENING GENERAL SESSION with Cliff Landis (E)

Location: Athena E/F

Ask Technical Services--Business Meeting (E)

Location: Olympia 2

Building a Green Library: Lessons Learned from Three Georgia Academic Libraries (AL, PL, G)

Location: Athena J

Three Georgia library directors, Gene Ruffin, Loren Pinkerman, and Bill Potter, will discuss the opportunities and challenges involved in building an environmentally sustainable or "green" building.

Presenter(s): Virginia Feher, Gene Ruffin, Bill Potter, Loren Pinkerman

DOE Update (E)

Parthenon 2

What's the latest news from the Georgia Department of Education?

Judy Serritella

jserrite@doe.k12.ga.us

First Year in the Trenches: Challenges and Insights from New Librarians (E)

Location: High Shoals 2

In a panel interview format, recent MLIS graduates will share experiences and lessons learned during their first year as professional librarians in public, academic, and school libraries and IT positions (sponsored by the GLA New Members Round Table)

Presenter(s): Julie Higbee, Ashley Dupuy, John McConnell, Mary Poland, Suzannah Lipscomb
jahigbee@northgeorgia.edu

Georgia Peach Book Award for Teen Readers--2011-12 (PL, HS)

Location: Athena H

Legend: E=Everyone; AL=Academic Librarians; PL=Public Librarians; G=General; IT=Instructional Technologist;
ES=Elementary School Library Media Specialist; MS=Middle School Library Media Specialist; HS=High School Library Media Specialist

Nominees Participants will find out more about the Georgia Peach Book Award for Teen Readers and hear booktalks of the twenty 2011-12 Nominees for the award.

*Presenter(s): Elaine Black, Mary K Donovan
eblack@georgialibraries.org*

Georgia Student Media Festival Showcase and Updates; Get Your Video Groove On! Edit a Winning Media Festival Production (IT, ES, MS, HS)

Location: Athena B

See how students can become critical thinkers and high achievers through media-rich student created projects.

*Presenter(s): Michelle Lenderman, Deborah Gray, Gordon Baker
mlenderman.central@bibb.k12.ga.us*

Leveraging Bite-Size Video for Learning (E)

Location: Willow

Jay Turner, director of continuing education at Georgia Public Library Service, provides a crash course on videography basics and how to create engaging bite-sized videos for learning.

*Presenter(s): Jay Turner
jturner@georgialibraries.org*

Oh Where, Oh Where Has All The Cache Gone? The Basics of Educaching (IT, ES, G)

Location: Athena D

Educaching? Join us to learn about this new, innovative way to use GPS (Global Positioning System) technology to teach math, science and social studies objectives.

*Presenter(s): Suzanne Skeen, Sharon Amolo
suzanne_skeen@gwinnett.k12.ga.us*

Outreach on a Budget (AL)

Location: Athena A

This presentation will provide practical, creative, free or low cost ways for libraries to reach users.

*Presenter(s): Louise Lowe
lowe_ll@mercer.edu*

Perfect Pathfinders for Every Purpose (EL, MS, HS)

Location: High Shoals 1

Learn quick, easy and free ways to create subject-focused pathfinders that support the research process for students at any grade level.

*Presenter(s): Judi Repman, Beth Downs, Stephanie Jones, Lucy Green
jrepman@georgiasouthern.edu*

Pick a Peck of Picture Books (ES)

Location: Athena I

We are back and have picked new batch of picture books to share innovative ways to teach GPS objectives.

*Presenter(s): Kristie Michalowski, Jamie Nobles
kristie_michalowski@gwinnett.k12.ga.us*

Special Collaboration: The Recipe for Successful Partnerships Between School Librarians & Special Educators (PL, ES MS, HS)

Location: Athena G

Learn and share strategies for building collaboration between librarians and special educators focused on providing engaging learning opportunities that incorporate Web 2.0 technology for special needs students.

*Presenter(s): Kathi Vanderbilt, Kelly Bramblett
Kathi.Vanderbilt@cobbk12.org*

Using Cognitive Theories in the Library Instruction Session (AL)

Location: Parthenon 1

This presentation will discuss cognitive and constructivist learning theories and their practical applications in the library instruction session, with time towards the end for group sharing of ideas.

*Presenter(s): LouAnn Blocker
lblockel@aug.edu*

What's New in GALILEO? (E)

Location: Athena C

Catch up on new projects and features with Q&A included.

Presenter(s): GALILEO Staff

Legend: E=Everyone; AL=Academic Librarians; PL= Public Librarians; G = General; IT = Instructional Technologist;
ES = Elementary School Library Media Specialist; MS = Middle School Library Media Specialist; HS = High School Library Media Specialist

Win-Win Communication Scenarios At The Library

Location: Cypress 1

Let's talk—effective workplace communication skills!

Presenter(s): Christian Steinmetz

dahampton@gsu.edu

Thursday, October 6 10:00AM - 11:50AM

GLA Academic Papers Awards (AL)

Location: Olympia 1

The Academic Division of GLA presents the 18th edition of the Academic Papers Competition. Join us to hear presentations of the top six peer reviewed papers.

Smartphones, Apps & Libraries (IT, AL, PL, ES, MS, HS, G)

Location: Cypress 2

Learn how to integrate mobile technologies into your library services for little to no-cost by exploring new technologies like QR Codes, Augmented Reality, SMS and location-based apps, & how these new tools can make libraries more relevant than ever.

Presenter(s): Diana Silveira

diana@novarelibrary.com

Thursday, October 6 11:00AM - 11:50AM

Exhibits (E)

Location: Grand Halls

Accounting and Budgeting for the Non-Accountant (AL, PL, G)

Location: Athena A

Library directors or staff who have no or little concept of accounting procedures will learn basic financial management to use in their libraries.

Presenter(s): Diana Very

dianajvery@gmail.com

Acquisitions Roundtable--Best Practices for the Digital Era (E)

Location: Olympia 2

An Overview of a Planning Guide for Empowering Learners (ES, MS, HS)

Location: Parthenon 2

Learn about the new Planning Guide for Empowering Learners, an online tool which school librarians can use for program assessment and planning.

Presenter(s): Stephanie Jones

sjones@georgiasouthern.edu

Book Trailers and How to Use Them in a Media Program (ES, MS, HS, G)

Location: High Shoals 1

Discover how to find book trailers online or make them yourself - and how to incorporate them into your media program to promote reading!

Presenter(s): Jennifer Sweat, Cathy Shanks

jennifer_sweat@gwinnett.k12.ga.us

Community Contacts and Digital Collections: Using Your Unique Collections to Collaborate (AL, PL, HS, G)

Location: Athena G

GSU librarians share their experience developing digitization projects for the library's unique materials-projects which have opened up opportunities to work with local groups, to host events, to organize traveling exhibits and to get grants.

Presenter(s): Barbara Petersohn, Barbara Petersohn, Traci Drummond

bpetersohn@gsu.edu

Georgia Libraries: An Illustrated History (AL, PL, ES, MS, HS, G)

Location: Athena I

This is Part II of a program that presents spectacular images celebrating the rich tradition of Georgia libraries.

Presenter(s): Bill Meehan, Decker Emy, Lynn Futch, Erika Wagner, Stephanie Landrum

Legend: E=Everyone; AL=Academic Librarians; PL= Public Librarians; G = General; IT = Instructional Technologist;
ES = Elementary School Library Media Specialist; MS = Middle School Library Media Specialist; HS = High School Library Media Specialist

GLMA and GAIT Library Media Specialist of the Year Panel (ES, MS, HS)

Location: Parthenon 1

This panel discussion will include 2011 K-12 LMSO-TY District Winners

Grab GALILEO for Great Multi-Media Projects (IT, ES, MS, HS, G)

Location: Athena H

This fun and inspirational session shows how to grab GALILEO to make great multi-media student projects.

Presenter(s): Lauren Fancher

lauren.fancher@usg.edu

How to Create Award-Winning Elementary Media Festival Entries (ES)

Location: Athena B

A first grade teacher and technology lab manager will share strategies and ideas of how to plan, research and create award-winning media festival entries.

Presenter(s): Sara Forrester, Lynn Young

Carol_Ann_Chapman@gwinnett.k12.ga.us

One Size Fits No One: Unique Embedded Librarian Programs in Georgia Universities (IT, AL, G)

Location: Athena J

Academic librarians at universities large and small are embedding—are you?

Presenter(s): Ginger Williams, Sandra Riggs, Kaye Guterman

ghwilliams@valdosta.edu

PAWS for READING (PL, ES, MS, HS)

Location: Athena D

If you are looking for new ways to get children excited about reading AND you love animals, you won't want to miss this session about incorporating therapy animals into your library's reading programs.

Presenter(s): Teresa Kent, Tina Launey, Andy Spinks

Teresa.Kent@cobbk12.org

Reference Services to Special Populations Using LearnCentral Vrooms (IT, AL)

Location: Willow

Learn how to use LearnCentral VRooms to provide ADA compliant online reference services to those with special needs.

Presenter(s): Mary J. Rootes

mwilson@shorter.edu

Resume Review Clinic (E)

Location: High Shoals 2

Whether you're a recent MLIS graduate, looking for a promotion, or just in need of updating your resume, the Resume Review Clinic, sponsored by the New Members Round Table of GLA, is for you. Please bring your resume or cover letter.

Presenter(s): Angiah Davis, Ashley Dupuy

adavis@auctr.edu

Using Information Society Theory in Library Advocacy and Decision-Making (AL, PL)

Location: Cypress 1

Information Society Theory deals with the underlying reasons for why libraries have changed so much over the years - we'll explore this theory, offer ways to learn more about it, and discuss how you can use it in library advocacy and decision-making.

Presenter(s): Jeffrey Gallant

jwgallant@valdosta.edu

Using Library Manager to Engage Students (EL, MS, HS)

Location: Athena C

Discover how colleagues in K-12 libraries are using features such as MyQuest, ebooks and One Search to engage and instruct learners.

Presenter(s): Mary Barbee

mary_barbee@gwinnett.k12.ga.us

Legend: E=Everyone; AL=Academic Librarians; PL= Public Librarians; G = General; IT = Instructional Technologist;
ES = Elementary School Library Media Specialist; MS = Middle School Library Media Specialist; HS = High School Library Media Specialist

Thursday, October 6 12:00PM - 1:20PM

Exhibits (E)

Location: Grand Halls

GAIT/GLMA/GLA School Library K-12 Lunch Buffet (Ticketed) (PS, G)

Location: Empire 1/2

GLA Joint Academic and Public Divisions Lunch Buffet (Ticketed) (AL, PL, G)

Location: Oconee River 1/2

Join the Academic and Public Library Divisions for lunch and an entertaining presentation by Georgia author and historian, Annette Laing.

Presenter(s): Sarah Steiner

Thursday, October 6 1:30PM - 2:20PM

Exhibits (E)

Location: Grand Halls

5G Instruction: Get Ready, Get Set, Get Online, Get Busy, GO! (ES, MS, HS)

Location: Athena D

This session will provide an array of ideas for implementing exciting web 2.0 tools into classroom instruction and a discussion of how to collaborate with teachers about designing activities that incorporate these tools while supporting curriculum.

*Presenter(s): Phyllis Snipe, Dr. O.P. Cooper, University of West Georgia
psnipes@westga.edu*

Don't Go Crazy: Finding and Using eBooks and Online Databases (IT, ES, MS, HS, G)

Location: Athena J

Dive into the hottest topic in the library world today-eBooks. Yes, they're here to stay, so let's figure out how you can find the best ones for your school. We have the answers to your questions-join us as we explore the Crazy world of eBooks!

*Presenter(s): Robin Cole
katieg@mackin.com*

GALILEO Advocacy (E)

Location: High Shoals 2

Learn how to serve as an advocate for GALILEO - one of Georgia's most valuable assets.

*Presenter(s): Ann Hamilton, RACL GALILEO Advocacy Group
ahamilton@georgiasouthern.edu*

Law & Reference: Answering Legal Reference Questions (IT, AL, PL)

Location: Parthenon 1

Learn internet resources and effective strategies to help you answer legal-related reference questions in a non-law library setting with skill and confidence.

*Presenter(s): Wendy Moore, Maureen Cahill
wemoore@uga.edu*

"Lost in the Stacks:" The Research Library Rock 'n' Roll Radio Show (AL, G)

Location: Athena E

Come learn about Georgia Tech's unique collaboration with WREK student radio: The Research Library Rock 'n Roll Radio Show, "Lost in the Stacks."

*Presenter(s): Ameet Doshi, Charlie Bennett
ameet.doshi@gatech.edu*

Panel Discussion on Serials Management (AL, PL)

Location: Olympia 1

Join others for a panel discussion and information sharing on issues pertinent to serials management.

*Presenter(s): LouAnn Blocker, Skye Hardesty, Charles Sicignano
lblocke1@aug.edu*

Legend: E=Everyone; AL=Academic Librarians; PL=Public Librarians; G=General; IT=Instructional Technologist;
ES=Elementary School Library Media Specialist; MS=Middle School Library Media Specialist; HS=High School Library Media Specialist

Powerful Untapped Consumer Health Resources (PL, MS, HS, G)

Location: Cypress 2

Find free, readily available consumer health information you didn't know existed!

*Presenter(s): Eugenia Abbey, Wesley Stewart
eugenia.abbey@gpc.edu*

Professional Development Planning for Public Library Staff, GALILEO Included (PL)

Location: Athena B

Learn strategies for implementing or improving a professional development program at your library, including a look at the "Great Things to Know in GALILEO" self-guided training modules.

*Presenter(s): Courtney McGough, Jay Turner
courtney.mcgough@usg.edu*

Read Alouds that Rock Across the Curriculum! (PL, ES)

Location: Athena B

How to use rhyming read-alouds to increase students' vocabulary, stimulate imaginations, develop attention, listening, communication/writing, and cognitive skills, and build background knowledge, all of which leads to independent learning.

*Presenter(s): Diane Shore
dzshore@bellsouth.net*

Recipe for a Great Story Time: Spice It Up With Tech Tools (ES)

Location: Cypress 1

If you want to spice up story time, come and explore ways to incorporate technology resources such as websites, videos, and music to create interactive experiences using the Georgia Picture Storybook Award nominees.

*Presenter(s): Eden Clark
eden.clark@yahoo.com*

Recruiting, Training, Retaining Volunteers for a Successful Helen Ruffin Reading Bowl (PL, ES, MS, HS)

Location: Parthenon 2

Competent volunteers = (equals) successful HRRB competitions.

*Presenter(s): Barbara Hallstrom, Mary Etta Thomas, Lummie Harris
Barbara_K_Hallstrom@fc.dekalb.k12.ga.us*

Rolling in the Deep Web: Mining Free Resources for Science and Technology Information. (AL, PL, ES, MS, HS)

Location: High Shoals 1

From space flights to oil spills, discover how to get the most out of databases from the network of key federal agencies which provide scientific information from around the world.

*Presenter(s): Patricia Kenly, Bette Finn
patricia.kenly@library.gatech.edu*

Teaching Critical Thinking in a Digital World (LM, HS)

Location: Willow

Critical thinking and the digital age CAN be synonymous—come explore ways to help 21st century students navigate effectively through their digital world.

*Presenter(s): Jennifer Helfrich
jennifer_helfrich@gwinnett.k12.ga.us*

Trends in Faculty Roles, Promotion and Tenure: A Discussion (AL)

Location: Athena I

Come take part in a discussion of issues of vital importance to academic librarians.

*Presenter(s): Fred Smith, Alan Bernstein, Lorene Flanders, Cathy Jeffrey, Susan Morris
fsmith@georgiasouthern.edu*

Legend: E=Everyone; AL=Academic Librarians; PL=Public Librarians; G=General; IT=Instructional Technologist;
ES=Elementary School Library Media Specialist; MS=Middle School Library Media Specialist; HS=High School Library Media Specialist

We Hear You: Successful Strategies for Marketing, Implementing and Analyzing a LibQUAL Survey (AL, PL, G)

Location: Athena F

Learn how first time LibQUAL participant, Kennesaw State University achieved an amazing response rate on their survey (#1 in number of responses in the US), how they analyzed both quantitative and qualitative data and how they publicized the results.

Presenter(s): Rita Spisak, Cheryl Stiles, Chris Sharpe, Ashley Dupuy

rspisak@kennesaw.edu

Thursday, October 6 2:30PM - 3:20PM

Exhibits (E)

Location: Grand Halls

Ascending Into the Cloud: Covenant College's Migration to OCLC's New Web-Scale Management Services System (AL, PL, G)

Location: Athena E

Are Clouds in Your Forecast?: Adopting OCLC's WMS as a new ILS.

Presenter(s): Tad Mindeman

tad.mindeman@covenant.edu

Comics and Graphic Novels as Academic Literature (Moving Beyond the Kitsch) (IT, AL, PL, ES, MS, HS, G)

Location: High Shoals 1

Libraries are in a unique position to make good use of sequential art texts (comics and graphic novels) to generate both student and faculty interest in the medium as part of the academic pursuit of intellectual thought and discovery.

Presenter(s): Mike Elrod

rmelrod@yhc.edu

Creating a Relationship Between Schools and Public Libraries (PL, ES, MS, HS, G)

Location: Athena G

It's time to begin a positive relationship with your library and librarians.

Presenter(s): Tracy Ralston, Deborah Walburn, Aimee Leavitt

ralstont@mail.henry.public.lib.ga.us

Exploring Newspapers In GALILEO (E)

Location: Olympia 2

A look at content and functionality in DLG historical newspapers and subscription newspaper databases in GALILEO, including tips for better searching.

Ed Johnson & Karen Minton

karen.minton@usg.edu

How Do iPads Impact Early Childhood Engagement and Emerging Literacy Skills During a Public Library's Storytime Program? (IT, PL, ES)

Location: Parthenon 2

In this session presenters will demonstrate and allow audience interaction with related IPAD literacy tools and present findings on an action research study conducted at a public library.

Presenter(s): Timothy Goodale, Geri Spoonas, Stephen Brooks, Randall McCarty, Kelsey Cirmotich
tgoodale@odu.edu

How Libraries are Supporting and Promoting Undergraduate Research (AL)

Location: Athena D

Learn how four university libraries support the needs of undergraduate researchers while boosting the profile of the libraries and GALILEO resources by offering awards and exposure for excellence in undergraduate research and scholarship.

Presenter(s): Caroline Barratt, Laura Burtle, Julie Speer, Amy Buddie
ccason@uga.edu

Legend: E=Everyone; AL=Academic Librarians; PL= Public Librarians; G= General; IT= Instructional Technologist;
ES= Elementary School Library Media Specialist; MS= Middle School Library Media Specialist; HS= High School Library Media Specialist

Literacy and Reading for the 21st Century Learner (ES, MS, HS, G)

Location: Parthenon 1

Introducing the 2010 AASL Library Standards for Literacy and Reading, this session will include various promotional as well as instructional methods to encourage the joy of reading for 21st century learners.

*Presenter(s): Dianne Dees
ecdees@valdosta.edu*

Make Media Center Presentations Pop with Multimedia! (IT, ES, MS, HS)

Location: Athena B

Participants will learn how to use Dvolver (simple online movie-making software), Capzles (visually appealing online presentation tool), and BeFunky (basic online photo editing tool).

*Presenter(s): Kelly Paynter
kelly.paynter@cobbk12.org*

Making the Leap: Transitioning from Paraprofessional to Professional Librarian (AL, PL, G)

Location: Willow

This panel discussion will provide practical advice and insight for paraprofessionals who are considering library school as well as for recent library school graduates who are seeking a professional position.

Presenter(s): Virginia Feher, Viki Timian, Rita Spisak, Kara Mullen, Charles Bennett

Maximizing Your Social Media Presence: Tools and Tips to Save You Time and Effort (IT, AL, PL, ES, MS, HS, G)

Location: High Shoals 2

Think you don't have time for social media? Wonder how people seem to be online 24/7? Learn the secrets to maximizing your social media with less effort.

*Presenter(s): Robin Fay
georgiawebgurl@gmail.com*

Navigating the Job Search Process (IT, AL, PL, ES, MS, HS, G)

Location: Athena C

For job seekers or anyone who wants to update their job hunting skills—discuss cover letters, resumes, public speaking and more!

*Presenter(s): Christian Steinmetz, Jan Hudson
adupuy@kennesaw.edu*

OCLC, Web-scale Management Services, and a New Platform for Interlibrary Loan (E)

Location: Cypress 2

It's coming - be prepared - OCLC, Web-scale Management Services, and a changing platform for Interlibrary Loan.

*Presenter(s): Russell Palmer
smorris@uga.edu*

Out With the Old and In with the New: Reinventing Yourself (E)

Location: Cypress 1

It's time for a career makeover - reinvent yourself with your current skill sets!

*Presenter(s): Denita Hampton, Marcellous Grace, Laura Herndon, Dawn Dale, Karen Walton
dahampton@gsu.edu*

Profile Your Network: Use Salary Surveys for Job Description Analysis (AL, PL, ES, MS, HS, G)

Location: Athena A

If you ever wondered what others in your position earn, what their duties are, or what qualifications they hold then join this panel as we offer useful tips for using salary surveys to profile your network and perform a job description analysis.

*Presenter(s): Yadira Payne, LuMarie Guth, Chris Sharpe
ypayne@aug.edu*

Reference Services Interest Group (E)

Location: Athena F

Legend: E=Everyone; AL=Academic Librarians; PL=Public Librarians; G=General; IT=Instructional Technologist; ES=Elementary School Library Media Specialist; MS=Middle School Library Media Specialist; HS=High School Library Media Specialist

Using Primary Sources for Multimedia Literacy (E)

Location: Athena J

Multimedia literacy has become an important part of the curriculum in many content areas, and the Library of Congress website provides a wealth of primary source materials along with interesting ways to integrate them into instruction.

*Presenter(s): Marsha Huunter
marsha_hunter@gwinnett.k12.ga.us*

When Your Library Is Not a Library: Capturing the Functionality of Your Space (AL, PL, G)

Location: Athena H

If you recognize your Library as a Place, then you can re-imagine it as a Space.

*Presenter(s): Cynthia Horne
crhorne@northgeorgia.edu*

Thursday, October 6 3:30PM - 4:20PM

Exhibits Only (E)

Location: Grand Halls

Thursday, October 6 4:30PM - 5:00PM

Exhibits (E)

Location: Grand Halls

Thursday, October 6 4:30PM - 5:20PM

SECOND GENERAL SESSION with Eric Litwin and James Dean (E)

Location: Athena E/F

Thursday, October 6 5:30PM - 7:00PM

AUTHORS' RECEPTION (E)

Location: Grand Halls

Thursday, October 6 7:30PM - 9:00PM

GLA Awards Banquet With Battledecks Competition Preceding (Ticketed)

Location: Athena E/F

GLA/General

GLMA Dinner and Business Meeting (Ticketed)

Location: Parthenon 1/2

GLMA/General

Friday, October 7 8:00AM - 8:50AM

Exhibits (E)

Location: Grand Halls

GAIT Breakfast (Ticketed)

Location: Parthenon 2

GAIT/General

Friday, October 7 8:00AM - 11:00AM

Exhibits (E)

Location: Grand Halls

Friday, October 7 9:00AM - 9:50AM

Exhibits (E)

Location: Grand Halls

GLMA Mable Wyche Underwood Grant Winners Presentation (ES, MS, HS)

Location: Athena J

Student research on plants, habitats, life cycles leads to schoolyard wildlife habitat; students earn KLUB membership & incentives for reading books & sharing written summaries; students use a video gaming system to develop a reader's advisory program.

*Presenter(s): Linda Johns, Jannell McClure,
Laurie Griffin*

Legend: E=Everyone; AL=Academic Librarians; PL= Public Librarians; G = General; IT = Instructional Technologist;
ES = Elementary School Library Media Specialist; MS = Middle School Library Media Specialist; HS = High School Library Media Specialist

Library Instruction . . . It's Just an iClick Away (AL, ES, MS, HS)

Location: Athena C

Learn how implementing iClickers (personal response systems) into college library instruction curriculum improved student involvement, active learning, and faculty satisfaction.

*Presenter(s): Melissa Whitesell, David Brown
mwhitesell@daltonstate.edu*

Meeting Users' Expectations through Resource Sharing (AL, PL, G)

Location: Oconee River 1

Doing more faster with less—how three Georgia ILL colleagues are meeting users expectations through ILL and other kinds of resources sharing.

*Presenter(s): Katharine Calhoun, Judith Levy, Margaret Ellingson
smorris@uga.edu*

MLIS Faculty Research in Progress at Valdosta State University (E)

Location: Athena B

Find out what VSU's MLIS faculty are discovering through their innovative research projects currently under way.

*Presenter(s): Linda Most, Colette Drouillard, Chang Woo Yang
lrmmost@valdosta.edu*

Money Smart Week @ Your Library (April 21-28, 2012) (AL, PL, ES, MS, HS, G)

Location: Athena G

Learn how your library can participate in Money Smart Week @ your library, a national initiative by ALA, in partnership with the Federal Reserve Bank, to provide financial literacy programming.

*Presenter(s): Michael Dowling
mdowling@ala.org*

PBCore 2.0: Understanding an Updated Metadata Scheme for Audiovisual Resources (IT, AL, G)

Location: Willow

Everything you need to know about PBCore 2.0, the newly revised metadata standard for description of audiovisual resources.

*Presenter(s): Mary Miller
mlmiller@uga.edu*

Promoting Literacy Through Reading Incentive Programs (ES)

Location: Empire 2

Three media specialists will share their reading incentive programs that encourage literacy.

*Presenter(s): Carol Ann Chapman, Mary Tyner, Anne Marie Schleier
Carol_Ann_Chapman@gwinnett.k12.ga.us*

Showing Value With GALILEO Statistics (E)

Location: Olympia 1

This session will show the inner workings of how GALILEO collects, manages, and reports usage statistics. It will also demonstrate different ways to present usage data for accountability purposes.

*Presenter(s): Ken Henslee
ken.henslee@uga.edu*

Taking the Leap: Moving from Hardware Solutions to Cloud Computing (IT, AL, PL)

Location: Athena A

Learn how to utilize the strength and flexibility of the cloud at your library. From the use of collaborative document sharing to shared storage to cloud-based phone systems to cloud-based email, there are a many options available for free.

*Presenter(s): Diana Silveira
diana@novarelibrary.com*

Legend: E=Everyone; AL=Academic Librarians; PL= Public Librarians; G = General; IT = Instructional Technologist;
ES = Elementary School Library Media Specialist; MS = Middle School Library Media Specialist; HS = High School Library Media Specialist

Tapping into a Technical College's Best Resource: Its Students (AL)

Location: Athena H

This session will discuss the initial and trial phase of the collaboration between the SCTC Web Design program and library to create the Student Assistance Tracker, a reference statistic tracking tool.

*Presenter(s): Kathleen Williams, Sherry Brooks, Charles Cash
kate.williams@sctech.edu*

The EPUB Standard and School Library Media Centers (ES, MS, HS)

Location: High Shoals 2

Through discussion and software demonstration we will provide an overview of how creating, managing and publishing eBooks in the EPUB standard format can be implemented and utilized by school library media specialists.

*Presenter(s): O. P. Cooper, Phyllis Snipes
ocooper@westga.edu*

The Fundamentals of RDA (E)

Location: Cypress 2

This is an overview of the fundamentals of Resource Description and Access (RDA) for catalogers and non-catalogers.

*Presenter(s): Linh Uong, Jolanta Radzik
luong@hallcountylibrary.org*

The Redesigned 21st Century K12 Media Center (ES, MS, HS)

Location: Athena I

Through careful furniture choices and rethinking the services provided, Forsyth County Schools is prototyping a new style of media center.

*Presenter(s): Jill Hobson, Valerie Kaye
jhobson@forsyth.k12.ga.us*

Thinking Outside the Box: Strategies for Managing Library-Community Outreach Programs (AL, PL, ES, MS, HS, G)

Location: High Shoals 1

This presentation will demonstrate how to effectively manage a comprehensive community outreach program to disseminate vital information resources and tools beyond an academic library walls.

Presenter(s): Liya Deng, Stan Trembach

Usage and Identity for the Branch Library (AL, PL)

Location: Cypress 1

An examination of user needs in, and how users and administrators identify branch libraries.

*Presenter(s): Michael Law
lawm@uga.edu*

Value of Social Tagging by Subject Area (AL, PL, G)

Location: Oconee River 2

Adding social tags to the library catalog can enhance the effectiveness of the patron searching based on subject area.

*Presenter(s): Harold Thiele
hethiele@valdosta.edu*

What in the "Library" Are You Doing? A Discussion of Survey Results from a Sampling of Library Users at Georgia Southern University (AL)

Location: Athena D

Ever wonder what draws today's students to academic libraries? Come and hear about the survey results of this question from Georgia Southern librarians.

*Presenter(s): David Lowder, Lori Gwinett, Cynthia Frost, Rebecca Ziegler, Lisa Smith
dlowder@georgiasouthern.edu*

Legend: E=Everyone; AL=Academic Librarians; PL= Public Librarians; G = General; IT = Instructional Technologist;
ES = Elementary School Library Media Specialist; MS = Middle School Library Media Specialist; HS = High School Library Media Specialist

Working Inside the Box: Innovative LibGuide Tricks (IT, AL)

Location: Empire 1

Learn features and content ideas that will improve the quality, maintenance and assessment of your guides.

*Presenter(s): Jason Puckett, Casey Long
jpuckett@gsu.edu*

Friday, October 7 10:00AM - 10:50AM

Exhibits Only (E)

Location: Grand Halls

Friday, October 7 11:00AM - 11:50AM

Assessment of Student Learning in Academic Library and Archival Teaching/BI Programs (AL)

Location: Parthenon 2

Assessment is ubiquitous now in higher education, and the library's instruction program must prove its worth: a BI librarian and an archivist explore effective ways to assess student learning and program effectiveness in library and archives teaching.

*Presenter(s): Deborah Davis, Howard Carrier
dsdavis@valdosta.edu*

Empowering Voices: Communities Speak Out for Libraries (E)

Location: Cypress 2

ALA President Molly Raphael will share ideas for engaging your community in advocating for your library.

*Presenter(s): Molly Raphael
ahamilton@georgiasouthern.edu*

Gaining Perspective: A User Discussion of E-Books from Professional to Vendor (IT, AL, PL)

Location: Athena A

Immerse yourself in the popular and changing e-book environment through a panel discussion of the state of the art of this product from the viewpoint of both vendor and library professional.

*Presenter(s): Anne Salter, Scott Wasinger, Joan Taylor, Deborah Prosser, Rebecca Rose, Bruce Heterick, Phoebe E. Acheson
asalter@oglethorpe.edu, pacheson@uga.edu*

Georgia Children's Picture Storybook Award 2012: And the Nominees Are . . . (PL, ES)

Location: Athena G

Newbies and veteran Georgia Book Award participants are invited to hear and share ideas for reading the 20 nominated titles with your elementary school students and young public library patrons.

*Presenter(s): James Campbell
jcampbell@clayton.k12.ga.us*

Giving Them What They Want, Not What We Assume They Need: User-Centric Development of a Mobile Library Website (AL, G)

Location: Athena J

In an effort to build a user-centric mobile site, Georgia State University Library did a user study to identify what the users wanted rather than work from our own assumptions. Take a look at what we learned and see the resulting mobile site.

*Presenter(s): Mandy Swygart-Hobaugh, Christian Steinmetz
aswygarthobaugh@gsu.edu*

Government Information Interest Group (E)

Location: Olympia 2

Legend: E=Everyone; AL=Academic Librarians; PL= Public Librarians; G = General; IT = Instructional Technologist;
ES = Elementary School Library Media Specialist; MS = Middle School Library Media Specialist; HS = High School Library Media Specialist

Georgia Council of Media Organizations 2011 Conference - Athens, GA

23

Great Student Employees, Not a Myth! Creating a Student Employee Program That Works for the Library, the Students, and You (AL, PL, HS)

Location: Athena B

Good student employee programs are created over time through careful planning and constant revision; the Oxford College Library will be sharing their experiences and encouraging others to share their best practices.

*Presenter(s): Ellen Neufeld, Jennifer Sirotkin
ellen.neufeld@emory.edu*

Inviting the World into Your School Library: Using Web 2.0 Tools for Teaching and Collaboration (IT, ES, MS)

Location: High Shoals 2

See how you can use Web 2.0 tools such as blogs, podcasts, photosharing sites, Skype and more to create collaborative lessons with not only the teachers in your building but with teachers and media specialists throughout the world.

*Presenter(s): Kathy Schmidt
kathy_schmidt@gwinnett.k12.ga.us*

Keeping Up the Circulation! (HS)

Location: Oconee River 2

Learn effective strategies to keep your high school circulation statistics high.

*Presenter(s): Dawn Hall, Dawn Hall, Kim Sciandra
dhall@forsyth.k12.ga.us*

License Agreement Red Flags (AL)

Location: Athena D

Learn why specific wording common to license agreements may be unacceptable to your library.

*Presenter(s): Florence Tang
tang_fy@mercer.edu*

Moving to the Cloud: One Library's Story of Implementing OCLC's Web Management System (IT, AL, PL, ES, MS, HS)

Location: Athena I

Frustrated with your ILS? Move to the Cloud with OCLC's Web Management System

*Presenter(s): Lynn Futch, Chris Manriquez
lfutch@ogeecheetech.edu*

Panel Discussion: The Impact of RDA on Georgia's Libraries (E)

Location: Cypress 1

Hosted by the GLA Technical Services Interest Group, this panel discusses the impact of the Library of Congress' decision on the implementation of RDA from the perspective of academic and public librarians in Georgia.

*Presenter(s): Linh Uong Jolanta Radzik, Armin Siedlecki, Elaine Hardy, Suzanne Graham, Kelly Holt
luong@hallcountylibrary.org*

PRIME TIME Family Reading Time: Program Overview (PL, ES)

Location: Athena C

PRIME TIME is a 6 week inter-generational family literacy program that really works! Learn about the program and hear how PRIME TIME is transforming families across the state.

*Presenter(s): Elaine Black
eblack@georgialibraries.org*

Searching for Treasure in Georgia's Virtual Vault (E)

Location: Empire 2

A look at the digital image collections housed in the Georgia Archives' Virtual Vault and a discussion of their use as well as methods of effectively searching for them.

*Presenter(s): David Minchew
david.minchew@gmail.com*

Legend: E=Everyone; AL=Academic Librarians; PL=Public Librarians; G=General; IT=Instructional Technologist;
ES=Elementary School Library Media Specialist; MS=Middle School Library Media Specialist; HS=High School Library Media Specialist

Stepping Up The Ladder: "Next Gen" Leadership In the 21st Century (AL, PL, ES, MS, HS)

Location: High Shoals 1

With the retirement of many experienced and very skilled librarians, are Generation Xers and Millennials prepared to step up the ladder and take the libraries into the future?

*Presenter(s): Maud Mundava, Angiah Davis
mmundava@auctr.edu*

System Level Media Coordinators Meeting

Location: Olympia 1

Annual update from DOE concerning school library/media centers.

*System Level Media Coordinators
Judy Serritella
jserrite@doe.k12.ga.us*

The Resourceful Librarian's Guide to Electronic Resources Management (E)

Location: Empire 1

Come learn how Microsoft Access, Microsoft Excel, and LibGuides can be employed to manage a small to mid-sized e-resources collection.

*Presenter(s): Tessa Minchew
tessa.minchew@gpc.edu*

Two-Faced Faculty Member: Juggling Librarianship and Teaching in an Academic Setting. (IT, AL, G)

Location: Athena H

Newbie librarian moonlighting as part-time professor seeks same (or curious) for a session of sharing, best practices, horror stories, and successes!

*Presenter(s): Sarah Hepler
shepler@highlands.edu*

Using Technology to Improve Reference Service and Statistics Gathering (IT, AL)

Location: Oconee River 1

As technology continues to thrive, methods to improve service to our patrons, as well as data collection follow suit. The presentation looks at automated chat/text reference and reference data collection.

*Presenter(s): Bonnie Morris, Judy McHan
bmorris@northgeorgia.edu*

Weeding and Donations: A Panel Discussion (E)

Location: Parthenon 1

Panel briefly discusses how to weed your collection and handle donated materials, then will take your questions and feedback to discuss best practices.

*Presenter(s): Shelley Smith, Kyle McCarrell
shelley@westga.edu*

Friday, October 7 12:00PM - 12:50PM

CLOSING GENERAL SESSION with GA First Lady Sandra Deal and Dr. John Barge, State School Superintendent (E)

Location: Athena E/F

Friday, October 7 1:00PM - 1:20PM

Book Cart Drill Team Demo (E)

Location: Athena E/F

Friday, October 7 1:30PM - 2:20PM

GLA Scholarship Raffle Drawing (Lunch Available for Purchase) (E)

Location: Grand Halls

Legend: E=Everyone; AL=Academic Librarians; PL=Public Librarians; G=General; IT=Instructional Technologist;
ES=Elementary School Library Media Specialist; MS=Middle School Library Media Specialist; HS=High School Library Media Specialist

Georgia Council of Media Organizations 2011 Conference - Athens, GA

25

Special Thanks

A Huge Debt of Gratitude goes to Tom Beggs & the staff of the Center for Teaching and Learning at The University of Georgia including Krystal Pintar & her staff of the Instructional Media Group for providing and setting up the Projection screens for the sessions!

COMO Thanks the Following Sponsors:

COMO Tote Bags: Follett Library Resources - \$1,000

Authors' Reception: Davidson Titles - \$500

Exhibit Refreshments Breaks: Bound to Stay Bound Books - \$250.00

Movie Night: Mackin Library Services - \$250.00

Movie Night: Gumdrop Books \$100.00

Book Cart Drill Team Expo: Demco Gift Certificates \$250

The Official Librarian: Bessy's Back

A hilarious children's mystery novel
for children and pets of all ages!

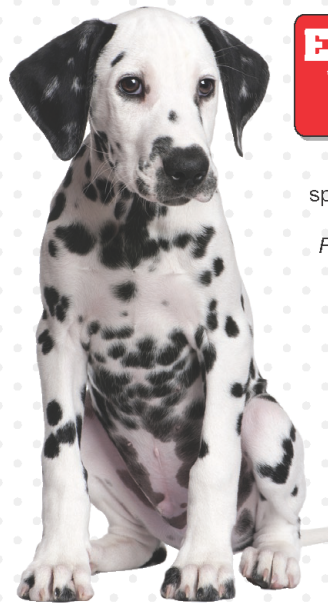

Enter to WIN!

Visit officiallibrarian.com
for "Name That Dog"
contest details

"... Miller writes with
sprightly energy, engaging
readers instantly..."
ForeWord Clarion Review



Get your copy at Barnes and Noble, Borders
or order online at officiallibrarian.com

2011 Exhibitors

#419

Agati Furniture
Brent Mintz, Ed O'Neill
1501 Brown Thrasher Ln
Marietta, GA 30062
770-973-0029
bmintz@agati.com
Agati designs, engineers, and manufacturers finely crafted and timeless furniture. Quality pieces and complete collections are tailored to meet clients' functional, aesthetic and technological needs. Designers and clients in institutional, healthcare and hospitality markets select Agati for an ability to offer both personalized service and guaranteed products.

#211

AWE, Inc.
Martha Gettys
2501 Seaport Dr, Suite 410
Chester, PA 19013
610-833-6400
gettysm@awe-net.com
www.awe-net.com
AWE's Early Literacy Station™

#100

Baker & Taylor
Vicky Lester
2550 W Tyvola Rd
Charlotte, NC 28217
800-775-7930 ext. 1350
lesterv@btol.com
Baker & Taylor, based in Charlotte, N.C., is a global information and entertainment services company that offers books, DVDs, music and related services to libraries, educational institutions, and retailers.

#417

The Book Farm, Inc.
Karen Greene, Chris Tinsley
1329 Altamonte Way S
Birmingham, AL 35205
205-933-1915
karengreene@thebookfarm.biz
Children's library books, PreK-12
Puppets, puzzles, felt products

#116

Bound to Stay Bound Books
Ryan Jett
1880 West Morton Ave
Jacksonville, IL 62650
800-637-6586
btsb@btsb.com
www.btsb.com
Prebound juvenile library books with full processing and automation support available.

#415

Brodart Co.
Sharon Shotwell
500 Arch St
Williamsport, PA 17701
800-233-8467 ext.6388
sharon.shotwell@brodart.com
www.brodart.com
Brodart is the premier supplier of shelf-ready materials to libraries delivering carefully selected, cataloged and processed books, as well as automation resource tools.

#215, 217

Burrow Library Services
Martha Stocton, Bruce Gailes, GeRene Gailes
408 Turner Rd
Pell City, AL 35128
800-683-5187
brenda4books@aol.com

#413

BWI
Josh Young
1340 Ridgeview Dr
McHenry, IL 60050
800-888-4478
josh.young@bwibooks.com
BWI offers books, music, and more to public libraries. For specialized collection development and personal service, choose BWI.

- #118
Camcor, Inc.
Joyce Canfield
3605 Sandy Plains Rd, Suite 240-263
Marietta, GA 30066
800-868-2462 ext. 353
jcanfield@camcor.com
www.camcor.com
Audio visual, digital imaging, and instructional technology solutions.
- #310, 411
Capstone
Jim Boon
22 Old Stonemill Rd
Marietta, GA 30067
404-993-9449
jimboon@windstream.net
K-8 content provider in both print and digital format
- #611
Children's Plus, Inc.
Jack Rosenberg, Kevin Walsh, Dan Walsh
PO Box 847
Beecher, IL 60401
800-230-1279
www.childrensplusinc.com
Classroom and library books for PreK to young adult.
- #315
Davidson Titles, Inc.
Kevin Tuschl
281 Angla Dr SE
Smyrna, GA 30082
678-939-1527
kevin.tuschl@davidsontitles.com
www.davidsontitles.com
Davidson Titles Inc. provides library materials, books, ebooks, and ibooks including non-fiction, fiction, reference and language titles. We offer diverse opening day collections for new libraries and collection analysis, weeding, and replacement suggestions for existing collections.
- #207, 209
Delaney Educational Enterprises, Inc.
Veronica Evans, Rhonda Sapp, Doraine Bennett
1455 W Morena Blvd
San Diego, CA 92110
800-788-5557
deebooks@deebooks.com
- #407
DEMCO Interiors
Joe Laura
4810 Forest Run Rd
Madison, WI 53704
800-858-2720
joel@demco.com
www.demcointeriors.com
DEMCO Interiors works collaboratively with architects, designers, librarians, and educators to create inspiring environments by combining design services with the most comprehensive choices in furniture and technology. Services include design and layout, project management and full installation.
- #512, 514, 516
Eason Associates
Julie Galbiati, Pete Galbiati, Sam Eason, Gwen Eason
2788 Cravey Ln
Atlanta, GA 30345
770-621-0398
pjgalbiati@comcast.net
Quality library bound books and digital products from several publishers.
- #423
EBSCO
Mary Sue Hoyle, Jodi Kuehl, Tim Turner
PO Box 2543
Birmingham, AL 35202
800-633-4604
www.ebsco.com
EBSCO provides e-journal, e-book, and e-journal package and print subscriptions, e-resource management tools, full-text and secondary databases, and related services for all types of libraries, research organizations, and corporations.
- #316
Equinox Software
Sally Fortin, Angela Kilsdonk, Suzannah Lipscomb
3050 Business Park Dr Suite A1
Norcross, GA 30071
770-709-5571
www.esilibrary.com
Open source library automation software services provider

#108

Films Media Group
Clark Turner
132 W 31st St, 17th floor
New York, NY 10001
800-257-5126 ext. 4233
clark.turner@infobaselearning.com
Films on Demand is a web-based digital video delivery service that allows you to view streaming videos from Films Media Group anytime, anywhere, 24/7!

#305

Florida State University
School of Library & Information Studies
Don Latham
PO Box 3062100
Tallahassee, FL 32306-2100
850-644-7272
dlatham@fsu.edu
www.slis.fsu.edu
Information on FSU's undergraduate and graduate programs in LIS.

#201, 203

Follett Library Resources Inc.
Ben Myers, Kim Hudson, David Starnes,
Marc McMullen, Randy Ceryan
1340 Ridgeview Dr
McHenry, IL 60050
888-511-5114 ext. 3311
sales@flr.follett.com
Follett Library Resources Inc. is a full-service distributor of a wide range of solutions designed to assist schools in improving student learning. Quality print materials are combined with digital resources like eBooks, interactive eBooks, online digital subscriptions, reference databases, audiovisual materials including early literacy and bilingual materials, professional resources, Accelerated Reader software and much more.

#106

Follett Software Company
John Rueff, Lori Schwebke
1391 Corporate Dr
McHenry, IL 60050
800-323-3397
lwelter@follettsoftware.com
Combining proven thought leadership with digitally powered, integrated educational technologies, Follett Software Company helps sustain a rich, collaborative 21st century K-12 learning environment that supports student success.

#221

Gale Cengage Learning
Kara Wilkes, Fred Sprouse
27500 Drake Rd
Farmington Hills, MI 48331
800-877-4253
latrescia.murphy@cengage.com
www.galeschools.com

#522

GALILEO – Georgia's Virtual Library
Deborah Shackelford
2500 Daniells Bridge Rd, Building 300
Athens, GA 30606
706-583-2007
deborah.shackelford@usg.edu
GALILEO is a World Wide Web-based virtual library providing access to multiple information resources, including secured access to licensed products. Participating institutions access databases indexing thousands of periodicals and journals.

#314

Gallopade International
Pam Morris, Jennifer Johnson
PO Box 2779
Peachtree City, GA 30269
770-631-4222
pam@gallopade.com
Gallopade International is a leader in the production of curriculum-related and supplementary educational materials. Author and CEO Carole Marsh has been writing children's books for more than 30 years.

#408

Garrett Book Company
Maria Almeida, Melissa Hill
PO Box 1588
Ada, OK 74821
800-654-9366
mail@garrettbooks.com
Library books for children and young adults

#204

Georgia Perimeter College – Library & Information Science Technology Program
Joseph Barnes, Lora Mirza, Stephen Koplan, Dan Veach, Carmel Brunson, Eugenia Abbey, Wesley Stuart, Amy Bursi, Pete Bursi
2101 Womack Rd

Dunwoody, GA 30338
770-274-5085
joseph.barnes@gpc.edu
GPC's new Library & Information Science Technology
(LIST) – program of study for library assistants.
#520

Georgia Public Library Service
David Baker, Darin Givens, Dustin Landrum
1800 Century Pl, Suite 150
Atlanta, GA 30345
404-235-7200
dbaker@georgialibraries.org
www.georgialibraries.org

#317
Georgia Southern University Instructional Technology
Program
Judi Repman, Beth Downs, Lucy Green
College of Education
Georgia Southern University
Statesboro, GA 30460
912-478-8533
jrepman@georgiasouthern.edu
Higher education – M.Ed & Ed.S. in School Library Media
and Instructional Technology

#218
Georgia Voyager Publications
Cathy M. Hodge, Dr. Tom Hodge
220 College Ave, Suite 412
Athens, GA 30603
706-352-6210
georgiavoyager1@yahoo.com
Reading books in social studies content area magazines

#518
Gumdrop Books
Gret Hechenbleikner, John Stevens, Glen Fitzgerald
PO Box 505
Bethany, MO 64424
800-821-7199
www.gumdropbooks.com
Top educational book distributor and publisher for PreK-
College level representing over 300 publishers, some exclu-
sive. Professional sales representatives, exceptional service,
unconditionally guaranteed.

#214
Imaginative Journeys
Annette Laing
PO Box 2523
Statesboro, GA 30459
912-536-2719
annette@imaginativejourneys.org
imaginativejourneys.org
Non-boring history for kids, led by a real historian! Intro-
duce your Summer Reading Program kids to the pleasures
of historical fiction and non-fiction with the entertaining,
inspiring, and affordable programs of Imaginative Jour-
neys. Led by Dr. Annette Laing, whose work on history for
kids has been profiled by the Associated Press, Imaginative
Journeys makes history at your library!

#307
Junior Library Guild
Karen Kelley-Salliotte
7858 Industrial Pkwy
Plain City, OH 43064
800-491-0174
sales@juniorlibraryguild.com
Junior Library Guild is a collection development review
service specializing in new edition, hard cover children's
and young adult literature.

#205
Learning Express, LLC
Vanessa Cardwell
2 Rector St, Floor 26
New York, NY 10006
512-584-1508
vcardwell@learningexpressllc.com

#206
Lyrasis
1438 W. Peachtree St. NW
Atlanta, GA 30309
800-999-8558
www.lyrasis.org
Lyrasis is a membership-based, non-profit organization
providing collaboration, creative solutions and leadership
for libraries through Lyrasis Technology Services (LTS),
digital and preservation services, professional develop-
ment, consulting, increased buying power for library and
eResources, and more.

- #112
Mackin Educational Resources
Robin Cole, Susy Dalton
3505 County Road 42 W
Burnsville, MN 55306
800-245-9540
robin.cole@mackin.com
www.mackin.com
Mackin Educational Resources is a complete one-source service providing virtually any book, eBook, audio, DVD, CD-Rom or educational software in print for libraries and classrooms. All orders receive FREE processing, FREE cataloging, and FREE shipping.
- #110
Mumford Library Books
Byron Rocher
7847 Bayberry Rd
Jacksonville, FL 32256
800-367-3927
byron@mumford.fdn.com
We are a wholesaler who sells books to libraries.
- #223
Novare Library Services
Diana Silveira, Ellen Mizio
PO Box 1663
Tarpon Springs, FL 34688
877-816-93638
diana@novarelibrary.com
Provides IT services and training to libraries. Novare develops custom mobile applications, web pages, and custom programming for libraries. Novare also offers training – face-to-face, web-based and on demand.
- #210, 311
Palmetto Microfilm Systems, Inc.
Bob Gilliam, Mark Coker, Bryan Johnson
202 N Lake Dr
Lexington, SC 29072
800-635-9638
bgilliam@pmsimag.com
ScanPro 2000, microfilm hardware
- #322
Peachtree Publishers
1700 Chattahoochee Ave
Atlanta, GA 30318
404-876-8761
palermo@peachtree-online.com
www.peachtree-online.com
An independently owned trade publisher specializing in quality children's books.
- #216
Perma-Bound Books
Mark Klein, Tim Dunham
PO Box 1029
Greensboro, GA 30642
800-903-2463
Pre-bound book titles for school media centers and classrooms. eBooks, collection analysis, and full processing. Free shipping on all orders. Book boosters, common core, and whiteboard activities.
- #312
Precision Planning, Inc.
Liz Hudson, Bill Cornell, Carla Carraway
400 Pike Blvd
Lawrenceville, GA 30046
770-338-8000
carla@ppi.us
Architects and engineers
- #219
ProQuest
Inez Karageorge
789 E. Eisenhower Pkwy
Ann Arbor, MI 48108
734-761-4700
- #122
Quality Books Inc.
John Higgins, Norma Higgins, Bebe Butler
1003 West Pines Rd
Oregon, IL 61061
800-323-4241
www.qbibooks.com
Quality Books Inc. specializes in distributing small press print and non-print materials to libraries. We offer approval, annotation, standing order plans & shelf-ready library processing.

#120

Rainbow Book Company
Tim Carlmark, Mark Sherman
500 E Illinois Route 22
Lake Zurich, IL 60047
847-726-9930
sales@rainbowcompany.com
Distributor of childrens books, K-12. Offering easy readers
and bilingual titles.

#319

Rand State Statistics
Joe Nation
70 Corte Precita
Greenbrae, CA 94904
415-602-2973
nation@randstatistics.org
Collection of statistical databases covering all states.

#220, 222

Reading Source
David Prince
PO Box 436
Anderson, SC 29622
888-473-6465
info@thereadingsource.com
Award nomination books , reference books, books to aid
and enhance the curriculum of the students.

#318

Ready Room Design
Jeff Prozan, Chris Prozan, Laura Prozan
117 Gary Glen Blvd
Huntsville, AL 35811
256-508-8812
contact@readyroomdesign.com
Colorful, graphic signage for libraries and schools

#505

Sebco Books
Ron Sen
2001 SW 31st Ave
Pembroke Park, FL 33009
800-223-3251
staff@sebcobooks.com
Sebco Books is a distributor of PreK through adult titles.
Now featuring site-license eBooks including Flip Books
and Interactive Books. Visit esebco.com to learn more.

#308

Selig Center for Economic Growth
University of Georgia
Lorena Akioka, Beate Kochut, Stephen Kuzniak
110 East Clayton St, Suite 602
Athens, GA 30602
706-425-2961
lakioka@uga.edu
Data products, reference works – featuring the Georgia
Statistical Abstract (books and CDs).

#410, 511

Source Interiors, Inc.
Mark Patterson, Michelle Patterson
PO Box 190728
Atlanta, GA 31119-0728
678-319-4347
markpmail@bellsouth.net
www.sourceinteriors.net
Library furniture, shelving, lounge and collaborative furni-
ture solutions.

#104

State Standards Publishing
Mimi Chandler, Jill Ward
1788 Quail Hollow
Hamilton, GA 31811
866-740-3056
jward@statestandardspublishing.com
www.statestandardspublishing.com
Books for Georgia Performance Standards

#208

TeacherLine Southeast
Kathy Finger
1101 George Rogers Blvd
Columbia, SC 29201
800-277-0829
teacherline@scetv.org
www.teacherlinesoutheast.org
TeacherLine Southeast provides online solutions for teacher
professional development, including Ga DOE approved
PBS Teacherline Courses, the nation's premier research and
standards-based resource for PreK-12 teachers.

#114

Tomorrow's Dreams
Paula Wiggs
281 Heritage Hills Dr
Spartanburg, SC 29307
scqnpw1@bellsouth.net
864-431-0244

Designs by Lucinda pins, necklaces and bracelet sets. Simone's country candles.

#102

University of North Texas
College of Information
Yvonne Chandler
1155 Union Circle 311068
Denton, TX 76203-5017
940-565-3777
yvonne.chandler@unt.edu

The College of Information Department of Library & Information Sciences offers graduate degrees and certifications in information science and library science, including a master of science, certificates of advanced study, and doctor of philosophy.

#313

University of South Carolina
School of Library & Information
Tilda Reeder, Nonie Price
1501 Greene St
Columbia, SC 29208
803-777-5067
tildareeder@sc.edu

The School of Library and Information Science at USC offers the Bachelor's, Master's, certificate and PhD. Courses are offered both on campus and online.

#409

Usborne Books and More
EDC Educational Services
Patti McClimans, Chan Ta Rivers, Cathy Eads
845 Landover Crossing
Suwanne, GA 30024
770-271-1782

patti@usbourneschoolservices.com

Educational books for children of all ages. 50% matching grants available.

#213

Valdosta State University
MLIS Program
Dr. Changwoo Yang, Dr. Harold Thiele, Dr. Colette Drouillard
1500 N Patterson St
Valdosta, GA 31698-0133
229-333-5966
wkoehler@valdosta.edu
www.valdosta.edu/mlis
Master of Library & Information Science @ VSU

#309

World Book
Donna Ellers, Katherine Jenkins, Mary Anne Thompson
233 N Michigan Ave, Suite 2000
Chicago, IL 60601
800-975-3250
judy.stancil@worldbook.com
Online and print for libraries and classrooms. World Book Web has integrated search with 275,000 primary source documents and over 5,000 ebooks. Reads aloud in English and translates into 30 languages. New! Science Power & Social Studies Power!

#510

Young Audiences
Woodruff Arts Center
Emily Genetelli
1280 Peachtree St NE
Atlanta, GA 30309
404-733-4574
emily.genetelli@woodruffcenter.org
Young Audiences, Woodruff Arts Center is Georgia's leading provider of educational arts programming. YAWAC brings the power of live arts experiences in music, dance, theatre, literary & visual arts to young people from pre-school to high schools through curriculum based programs.

Exhibit Hall



Athens Classic Center

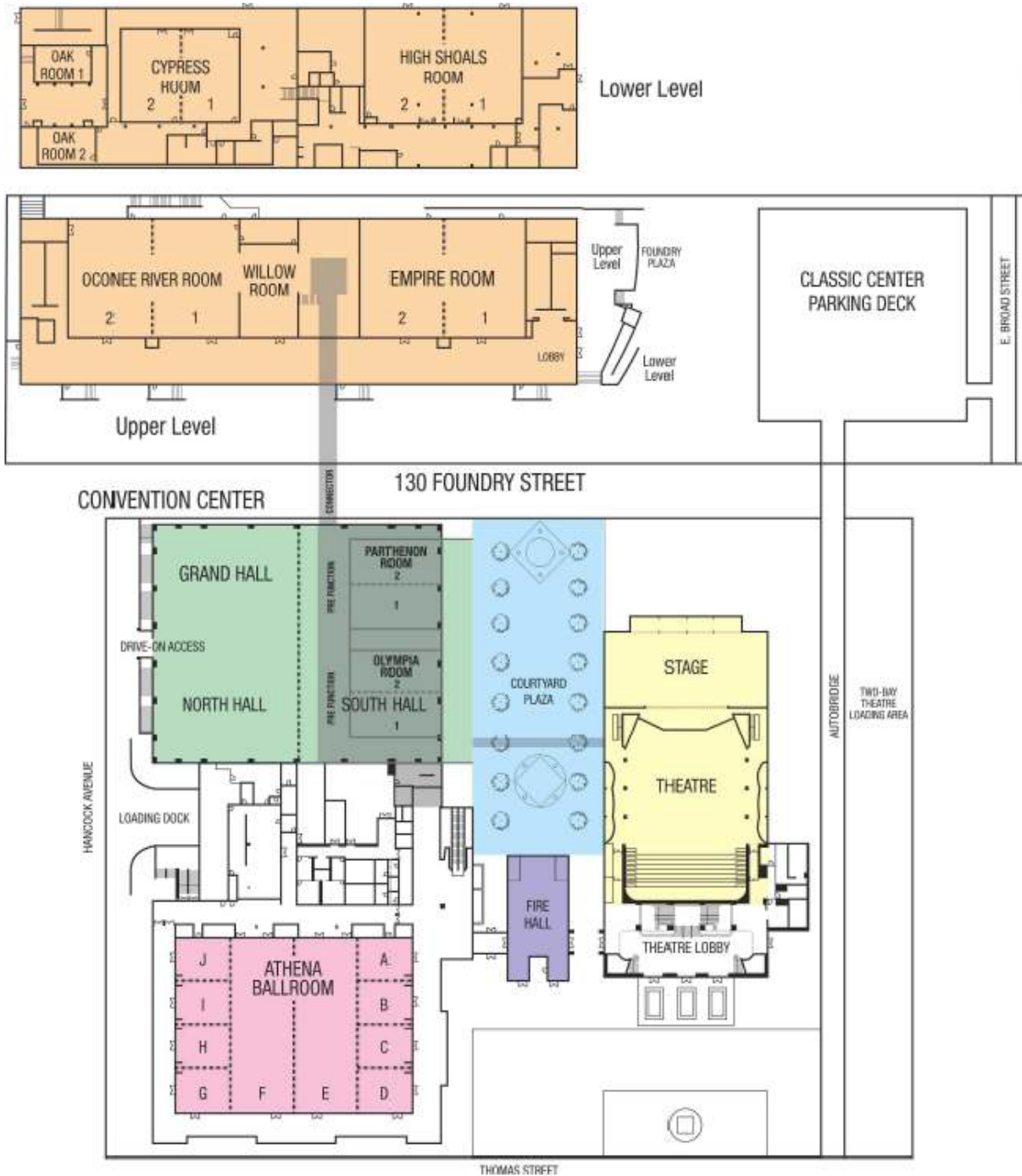

Georgia Council of Media Organizations XXIII Steering Committee

GLMA - Conference Chair

Betsy Razza, GACOMO XXIII Conference Chair and GLMA President

Valerie Ayer, GLMA Immediate Past-President

Karen White, GLMA President-Elect

Susan Grigsby, GLMA Past President

GAIT – Program

Sonja Fox, GACOMO XXII Program Chair and GLA President

Leslie Wantland, GACOMO XXIII Conference Treasurer and GAIT Treasurer

Dr. Gordon Baker, Programs Advisor

Pam Kelly, GAIT President-Elect

Dr. Melissa Underwood, GAIT Immediate Past-President

Giselle Escobar, GAIT Past President

GLA – Registration

Carolyn Fuller, GLA President

Carol Stanley, GLA Immediate Past-President

Elizabeth Bagley, GLA Vice-President

Jim Cooper GLA Past-President

Jim & Shirley Clark

Exhibits/Printed Program

Dr. Gordon Baker

Kara Mullen

The Authors Reception

Diana Very, GLA Public Library Division Chair