

REINVENT · REIMAGINE · REDISCOVER

LIBRARIES

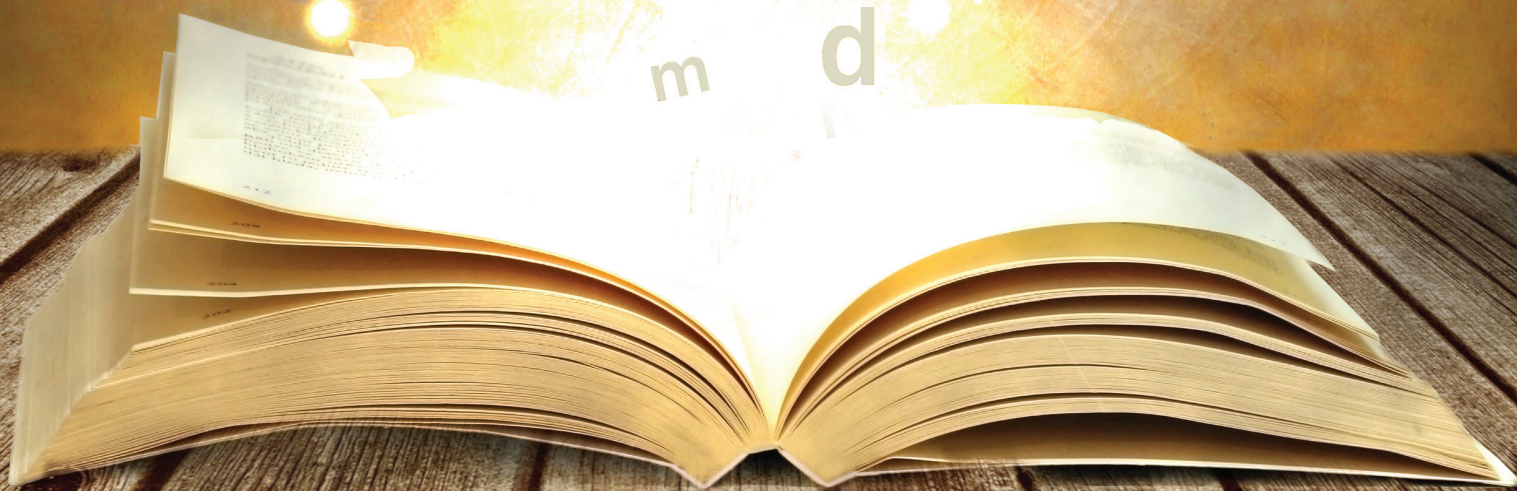

JOINT CONFERENCE OF GEORGIA COMO
& THE SOUTHEASTERN LIBRARY ASSOCIATION



28th GEORGIA COMO CONFERENCE

COMO 2016

OCT 5-7, 2016

THE CLASSIC CENTER - ATHENS, GEORGIA



REINVENT
REIMAGINE
REDISCOVER

LIBRARIES

WELCOME!

Welcome to the 28th and final GaCOMO Conference. We are happy to welcome the Southeastern Library Association (SELA) as our partner for this milestone event.

The very first GaCOMO – Cooperative Ventures Conference sponsored by the Georgia Council of Media Organizations (COMO) was held March 17-19, 1988 at Jekyll Island. The 2016 Conference will be the last conference presented under the GaCOMO brand. The two remaining COMO partners, the Georgia Association for Instructional Technology (GAIT) and the Georgia Library Association (GLA) have voted to begin a new venture in 2017 renaming our conference to the Georgia Libraries Conference.

As we bid a fond farewell to GaCOMO, it is an opportunity to look back to the beginning. At the first GaCOMO conference in 1988, the conference participants were welcomed with this statement:

*“We sincerely hope you will have an enjoyable, stimulating conference
“filled” with new ideas, new friends/colleagues, new methods of cooperation and a renewed dedication
to our profession and “what it’s all about.”*

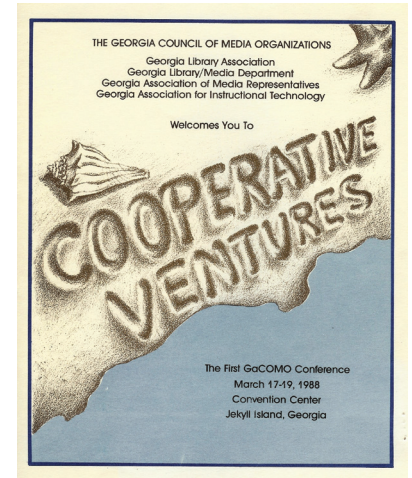

After 28 years the 2016 Georgia COMO/SELA Joint Conference Steering Committee wishes our participants the same things. We hope you leave Athens with new ideas, new friends and colleagues, and a renewed dedication to our profession.

It is fitting as we make plans to reinvent our conference that the theme for this year’s conference is REINVENT REIMAGINE REDISCOVER LIBRARIES. We hope you will find the Joint Steering Committee has met this theme. As with every Georgia COMO Conference, the schedule is packed with great concurrent sessions, featured speakers, and other activities. Some of these are highlighted below:

- Information about Local Arrangements and other activities can be found at the Information Table in The Classic Center Lobby
- Movie Night featuring “The Princess Bride”
- Pat Carterette Memorial Walk/Rum
- All Conference Luncheon with award-winning author, reporter, columnist, and television producer and analyst Jonathan Alter
- Exhibits each day, but Exhibits Only at 2:30-3:30 on Thursday
- Keynote Session with Eric Faden, “Visual Data, Copyright, and the Archive of the Future”
- Author Appreciation Reception
- All Conference Awards

The Conference will conclude on Friday with most everyone’s favorite, “The Scholarship Raffle.” This event always brings lots of excitement, plenty of cheering and “oohs” and “aahs.”

We have worked hard to provide you with a quality conference and we think we have. Please enjoy yourself and take back great ideas from the 2016 Georgia COMO/SELA Joint Conference.

Dr. Gordon N. Baker, 2016 GAIT President, Georgia COMO Co-Chair
Cathy Jeffrey, 2016 GLA President, Georgia COMO Co-Chair
Camille McCutcheon, 2015-2016 SELA President



REINVENT
REIMAGINE
REDISCOVER

LIBRARIES

GEORGIA ASSOCIATION FOR INSTRUCTIONAL TECHNOLOGY, INC.

The Georgia Association for Instructional Technology, Inc. (GAIT) is open to all who are interested in improving education through the use of media and technology. The membership is diverse and includes public school educators, corporate trainers, vocational instructors, college media directors, university professors, library/media specialists, commercial vendors, and more. All unite in activities designed to expand and diversify information. Communications technology activities are used to improve instruction through the systematic development, utilization, and management of learning resources including people, processes, and technology.

GAIT Affiliation

GAIT is the Georgia affiliate of the international Association for Educational Communications and Technology (AECT). As a member of GAIT, one plugs into a network of colleagues who provide each other with informal information and who join together to work on various committees and activities. Because GAIT is a diverse organization, members may often interact with other professionals outside their own work setting to share common interests in teaching, learning, and technology.

GAIT Sponsorships

GAIT co-sponsors (with GLA) an annual joint professional development conference (GeorgiaCOMO). The organization co-sponsors (with the Georgia Library Media Association-GLMA) the Georgia Library Media Specialist of the Year Award; and co-sponsors (with the Georgia Library Association-GLA) the Georgia Student Media Festival.

GAIT Membership Benefits

GAIT annually presents awards, scholarships, and stipends. The Distinguished Service Award is presented to members of the association whose service to GAIT is acknowledged as exemplary and worthy of special recognition. The Walter S. Bell Award is GAIT's highest recognition of achievements in the field of instructional technology from the public school sector and is presented to individuals who have made significant contributions throughout their careers. The Juanita Skelton Award is GAIT's highest recognition of achievements in higher education at the state or national level in instructional technology. GAIT/AECT Leadership Development Stipend is available to any active member of GAIT to be used for professional growth and development at the annual AECT Leadership Development Conference. The GAIT Technology

Innovation Mini-Grant is awarded to two current GAIT members and consists of grants from \$500-\$2000. The Goen-Sloan Scholarship is awarded annually to a GAIT member who is pursuing graduate studies in a media-related area. Awards traditionally are presented during ceremonies at the annual meeting of the association during Georgia COMO.

GAIT Communications

GAIT members keep current with association news and information through the GAIT Listserv [gait-l@lists.clayton], Web Connection newsletter, and the GAIT website [http://www.gait-inc.org]

2016 OFFICERS

PRESIDENT

DR. GORDON N. BAKER
Dean of Libraries, Clayton State University

PRESIDENT-ELECT

DR. PAMELA S. NUTT
Media Specialist, Griffin-Spalding County Schools

PAST PRESIDENT

MICHELLE LENDERMAN
Media Coordinator, Bibb County Schools

SECRETARY

LYNN CRAIG
Media Specialist, Henry County Schools

TREASURER

LAURA HERNDON
Serials Librarian, Clayton State University



REINVENT
REIMAGINE
REDISCOVER

LIBRARIES

GEORGIA LIBRARY ASSOCIATION

The Georgia Library Association (GLA) is an all-encompassing organization with membership from the academic, public, school, and special libraries communities. It includes professional and paraprofessional staff, public library trustees, and friends of libraries. GLA was founded in 1897 for the purposes of promoting public library funding, establishing a library training program in the state, and setting up a state commission to oversee the library interests of the state. Its current focus lies along similar lines, with legislative, financial, technological and library training issues, and advocacy for libraries of all types being among its chief concerns.

With over 700 members, GLA represents all library interests in Georgia. The Atlanta Emerging Librarians, the Carterette Series Webinars, Georgia Library Day, the GLA Mid-Winter Meeting and the state's participation in the ALA National Library Day are examples of major activities of the association. To cultivate the next generation of librarians, the Association offers MLIS students joint membership in GLA and ALA (American Library Association). GLA's official organ is the peer-reviewed journal The Georgia Library Quarterly.

The GLA Academic Library Division is a chapter of ACRL (the Association of College and Research Libraries). GLA also has memberships in, is affiliated with, or sponsors the following professional organizations: the American Association of School Librarians (AASL); the Freedom to Read Foundation (FTRF); the Georgia Association of Media Assistants (GAMA); the Library Leadership and Management Association (LLAMA), the Public Library Association (PLA); the Society of Georgia Archivists (SGA); and the Southeastern Library Association (SELA). Thus, GLA can draw upon considerable resources to facilitate workshops and other training programs for librarians, media specialists, and support staff.

GLA awards two scholarships annually to students enrolled in a program leading to an ALA-accredited Master's Degree in Library/Information Science. Noteworthy achievements of members and laypersons in the advancement of and advocacy for Georgia's libraries are recognized through the association's awards program.

For the last 120 years, GLA has been instrumental in the growth of Georgia's libraries. More information on the Association can be found at <http://gla.georgialibraries.org>.

2016 OFFICERS

PRESIDENT

CATHY JEFFREY

Associate Dean of Libraries,
Clayton State University, retired

VICE-PRESIDENT/ PRESIDENT-ELECT

ELIZABETH MCKINNEY

Pines Program Director,
Georgia Public Library Service

VICE-PRESIDENT/ MEMBERSHIP

JOHN MACK FREEMAN

Marketing and Programming Coordinator,
West Georgia Regional Library

SECRETARY

CASEY LONG

User Education Librarian,
Agnes Scott College

TREASURER

ELI ARNOLD

Head of Reference Services,
Oglethorpe University



REINVENT
REIMAGINE
REDISCOVER

LIBRARIES

SOUTHEASTERN LIBRARY ASSOCIATION

Founded in 1920, the Southeastern Library Association is a regional library organization with members from Alabama, Arkansas, Florida, Georgia, Kentucky, Louisiana, Mississippi, North Carolina, South Carolina, Tennessee, Virginia, and West Virginia. SELA promotes cooperation and information sharing throughout the Southeast to improve library service region-wide.

SELA places a strong emphasis on communication and professional growth. SELA provides opportunities for members to develop leadership skills through participation in committees and roundtables; offers mentoring to new professionals; promotes continuing education; and disseminates information about job openings and library news through social media and its website, listserv, and Facebook page. In addition SELA publishes the peer reviewed journal *The Southeastern Librarian*.

SELA actively supports libraries and literacy with regional awards and scholarships. These include:

- The Honorary SELA Membership Award is conferred upon living individuals who have made outstanding contributions to the Association or to library development in the Southeast.
- The Charles E. Beard Award honors an individual outside the library profession who has made a significant contribution to the development or promotion of libraries in the Southeast.
- The Mary Utopia Rothrock Award acknowledges the exceptional contributions of an individual to library development in the Southeast.
- The Outstanding Southeastern Author Award recognizes authors for current works of literary merit.
- The Outstanding Southeastern Library Program Award recognizes an outstanding program of service in an academic, public, school, or special library in a Southeastern Library Association member state.
- The Hal Mendelsohn Award honors an individual for dedicated service to the Southeastern Library Association.
- The Ginny Frankenthaler Memorial Scholarship in Library Science is awarded to beginning professional librarians who possess potential for leadership and commitment to service in libraries in the Southeast.

Since 1952 SELA has sponsored the Southern Books Competition. Trade publishers, university presses, specialty publishers, and private presses located in the southeastern states are eligible to enter this competition.

2015-2016 OFFICERS

PRESIDENT

CAMILLE MCCUTCHEON

Coordinator of Collection Management University of South Carolina Upstate (SC)

PRESIDENT-ELECT

LINDA S. HARRIS

University of Alabama-Birmingham,
Retired (AL)

SECRETARY

MELISSA DENNIS

Head of Research & Instruction,
University of Mississippi (MS)

TREASURER

BEVERLY JAMES

Director, Greenville County Library System (SC)



REINVENT
REIMAGINE
REDISCOVER

LIBRARIES

GENERAL INFORMATION

PRE-CONFERENCE WORKSHOP

There are six pre-conferences for 2016: Alma/Primo Workflow Best Practices, Counting What Counts, Emergency Management Toolkit for Libraries and GALILEO Mini-Conference. These are held at The Classic Center. Librarians in Print will be held at the UGA Digital Humanities Lab and Points, Polygons, and Possibilities will be held at the UGA Libraries Main Lab A. These sessions will be from 8:30 A.M. – 12:00 P.M. The GAIT Board will meet from 9:00 – 10:00 AM; both GLA and SELA Boards will meet from 10:00 A.M. to 12:00 P.M. A continental breakfast will be served from 8:00 – 10:30 AM for these participants.

EXHIBITS

Exhibits are located in Grand Hall 7 in The Classic Center. Exhibits are open Thursday from 8:00 A.M. – 5:00 P.M. and Friday from 8:00 A.M. – 11:00 A.M. Join us for “Coffee with the Vendors” on Thursday and Friday, 8:00 A.M. – 8:45 A.M. Another “Exhibits Focused” time happens Thursday, 2:30 P.M. – 3:20 P.M. Plan to spend some quality time with the vendors. They are extremely important to the success of this conference, and they have a lot to show you! Your badge is required to enter the Exhibits. Guest Badges are available for \$20.00 each at the Conference Registration Window in The Classic Center.

LOCATIONS FOR CONCURRENT SESSIONS, KEYNOTES, MOVIE NIGHT, AND PARKING

On Wednesday, The Library Movie Night will be “The Princess Bride,” and will be located at the Athens Regional Public Library from 7:00 – 9:00 P.M. Join old friends and chat with new ones over popcorn and fun trivia. The All Conference Luncheon will be held in Oconee River Room. Jonathan Alter is our speaker. The All Conference Luncheon is from 12:00 – 1:15 P.M. Thursday’s General Session will be held in Athena E & F at 3:45 P.M. Eric Faden is our keynote speaker. Concurrent Sessions are scheduled in the meeting rooms of The Classic Center. There is a parking deck at The Classic Center. It is \$7.00 for all day parking. If The Classic Center lot is full, there is a public parking lot at 125 W. Washington Street. The fee is \$1.50 per hour.

MEALS AND MEAL TICKETS

All meals are ticketed functions; payment is due with your conference registration. No tickets will be sold on site, although you may ask at COMO Registration if anyone has made a ticket available. If you are not attending a ticketed meal, you are only steps away from some of Athens’ finest restaurants. For suggestions check this link provided by The Classic Center: https://classiccenter.com/general/visitor_information/dining.html#Vf_xN5WFNaQ

AUTHORS APPRECIATION RECEPTION

Enjoy a glass of wine or a soft drink, chat with authors, visit with old friends, and make new ones at this reception. The reception will be held from 5:00-6:00 PM in The Classic Center Atrium following the keynote address. A book seller will be on site with books by your authors to provide you with the opportunity to ask authors who you have met during the reception to autograph their books. Guest passes are available for \$20.00.

CONFERENCE AWARDS CEREMONY

Please join us for the 2016 All Conference Awards Ceremony to be held in The Classic Center Atrium on Thursday from 6:00 – 7:00 P.M. Celebrate the award winners from the Georgia Association for Instructional Technology, the Georgia Library Association, and the Southeastern Library Association!

BADGES AND REGISTRATION

Your conference badge is required for admittance at all conference sessions and events. Non-registrants will not be admitted. Guest badges for Exhibits and Authors’ Reception will be sold at the COMO Conference Registration window. COMO Registration, managed by Classic Center Registration Team, will take place in the Atrium of The Classic Center.

GLA SCHOLARSHIP RAFFLE BOOTH

Shop for a good cause! (Drop off items for the Raffle on Wednesday, 2:00 – 5:30 P.M.) The GLA Scholarship Raffle Booth will be in the Exhibit Hall (Grand Hall 7) on Thursday from 8 A.M. – 3:45 P.M. and Friday from 8 A.M. – 11:00 A.M. Plan to stop by between sessions to view items such as gift baskets, art, one-of-a-kind items, etc...and BUY your lucky tickets. To save yourself from printing your name 10 times on raffle tickets, remember to bring personalized adhesive labels with your contact information on them. Proceeds from this annual raffle support two GLA Scholarships for library graduate programs.

REINVENT
REIMAGINE
REDISCOVER

LIBRARIES

CONFERENCE OVERVIEW

Wednesday, October 5, 2016

8:00 a.m. - 5:00 p.m.	Registration - Atrium
8:30-noon	Pre-conferences [Includes continental breakfast in Atrium 8:00-10:00]
9:00 a.m. - 10:00 a.m.	CAIT Executive Board
10:00 a.m. - 12:00 p.m.	SELA Executive Board
10:00 a.m. - 12:00 p.m.	GLA Executive Board
1:00 p.m. - 2:00 p.m.	Scholarship Raffle Booth accepting donations - Grand Hall 7
1:30 p.m. - 2:15 p.m.	Concurrent Session A
2:00 p.m. - 5:30 p.m.	Scholarship Raffle Booth open - Drop off items - Grand Hall 7
2:30 p.m. - 3:15 p.m.	Concurrent Session B
3:30 p.m. - 4:15 p.m.	Concurrent Session C
4:30 p.m. - 5:15 p.m.	Concurrent Session D
7:00 p.m. - 9:00 p.m.	Movie Night & Trivia at Athens Regional Public Library

Thursday, October 6, 2016

5:55 a.m. - 7:00	Pat Carterette Memorial Walk/Run
7:30 a.m. - 8:30	CAIT Breakfast
8:00 a.m. - 5:00 p.m.	Registration - Atrium
8:00 a.m. - 3:45 p.m.	Scholarship Raffle Booth open - Grand Hall 7
8:00 a.m. - 9:00 a.m.	Exhibits open and Coffee with the Vendors - Grand Hall 7
8:00 a.m. - 8:45 a.m.	GLA Division Meetings
9:00 a.m. - 9:45 a.m.	Concurrent Session E
10:00 a.m. - 10:45 a.m.	Concurrent Session F
11:00 a.m. - 11:45 a.m.	Concurrent Session G
12:00 p.m. - 1:15 p.m.	All Conference Lunch with Luncheon Keynote
8:00 a.m. - 3:45 p.m.	Scholarship Raffle Booth open - Grand Hall 7
1:30 p.m. - 2:15 p.m.	Session H
2:30 p.m. - 3:30 p.m.	Poster Session A - Grand Hall 7
2:30 p.m. - 3:30 p.m.	Break with the Vendors - Grand Hall 7
3:45 p.m. - 5:00 p.m.	All Conference Meeting and Keynote Speaker
5:00 p.m. - 6:00 p.m.	Meet the Authors Reception
6:00 p.m. - 7:00 p.m.	All Conference Awards
7:30 p.m. - 9:30 p.m.	New Members Round Table/Interest Group Dinner (Dutch Treat)

Friday, October 7, 2016

7:30 a.m. - 9:00 a.m.	SELA Breakfast
8:00 a.m. - 10:00 a.m.	Registration - Atrium
8:00 a.m. - 11:00 a.m.	Scholarship Raffle Booth open - Grand Hall 7
8:00 a.m. - 11:00 a.m.	Exhibits Open and Coffee With the Vendors - Grand Hall 7
8:00 a.m. - 8:45 a.m.	GLA Interest Group Business Meetings
9:00 a.m. - 9:45 a.m.	Concurrent Session J
10:00 a.m. - 11:00 a.m.	Poster Session B - Grand Hall 7
11:00 a.m. - 11:45 a.m.	Concurrent Session K
12:00 a.m. - 1:30 p.m.	Scholarship Raffle

FEATURED SPEAKERS



ERIC FADEN

KEYNOTE ADDRESS: "VISUAL DATA, COPYRIGHT, AND THE ARCHIVE OF THE FUTURE"

Eric Faden is an Associate Professor of English at Bucknell University. He

teaches a wide variety of courses in film/media studies from introductory courses to advanced production seminars. He produces multimedia works that imagine how academic scholarship works as an audio/visual medium. He is currently developing a feature film and web-based project called Within The Law that recreates a lost 1917 silent film.



JONATHAN ALTER

ALL CONFERENCE LUNCHEON

Jonathan Alter is an award-winning author, reporter, columnist and television producer and analyst. He is the author of

three New York Times bestsellers: "The Center Holds: Obama and His Enemies" (2013), "The Promise: President Obama, Year One" (2010) and "The Defining Moment: FDR's Hundred Days and the Triumph of Hope" (2006), also one of the Times' "Notable Books" of the year. Since 1996, Alter has been an analyst and contributing correspondent for NBC News and MSNBC, appearing on-air two or three times a week. After 28 years as a columnist and senior editor at Newsweek, where he wrote more than 50 cover stories, Alter is now a twice-monthly columnist for the Daily Beast. He has also written for The New York Times, The Washington Post, The Washington Monthly, Rolling Stone, The Atlantic, The New Yorker, Vanity Fair, The New Republic, Esquire, Bloomberg View and other publications. He is an executive producer of "Alpha House," a half-hour political comedy created by Garry Trudeau and starring John Goodman that is available for viewing on Amazon.com. He is at work on a full-length biography of former President Jimmy Carter and is producing a documentary about the lives of legendary journalists Jimmy Breslin and Pete Hamill.



REINVENT
REIMAGINE
REDISCOVER

LIBRARIES

WEDNESDAY, OCTOBER 5

Room	8:00AM - 10:30AM	8:30AM - 9:00AM	9:00AM - 10:00AM	10:00AM - 11:00AM	11:00AM - 12:00PM	12:00PM - 1:30PM
Atrium	Registration 8:00AM - 5:00PM					
Grand Hall 1			GAIT Executive Board	SELA Executive Board		
Grand Hall 2				GLA Executive Board		
Grand Hall 4	All Pre-conferences meet in the Classic Center Atrium for Breakfast	Emergency Management Toolkit for Libraries				
Grand Hall 5		Counting What Counts: GPLS's IMLS B4 Grant Outcomes and PLA's Project Outcome				
Olympia 1		GALILEO Preconference				
Olympia 2		ALMA/Primo Workflow: Best Practices from the Georgia Vangaurds' Perspectives				
Empire		Librarians in Print: A Scholarly Approach to Library Research				
UGA Digital Humanities Lab		Points, Polygons, and Possibilities: an Introduction to GIS for the Novice				
UGA Libraries Main Lab A						



REINVENT
REIMAGINE
REDISCOVER **LIBRARIES**

WEDNESDAY, OCTOBER 5

Room	1:30PM - 2:15PM	2:30PM - 3:15PM	3:30PM - 4:15PM	4:30PM - 5:15PM	5:15PM - 7:00PM	7:00PM - 9:00PM
Atrium	Registration 8:00AM - 5:00PM					
Grand Hall 1	Be Prepared - Keeping Your Staff, Library Users, and You Safe If The Unthinkable Occurs		Re-imagine Patron Services Through User Feedback	Reimagining the Library's Connection to Student Success: An Assessment Revelation		
Grand Hall 2	Full STEAM Ahead! The First Year of the STEAM Engine at West Georgia Regional Library	Use Programming Grants to Reinvent and Revitalize Your Library	Maximize the Potential of Your Library with Community Partnerships	Media Specialist Advocacy and Evaluation: How the MIKES Offers Support		
Grand Hall 4	What To Do When You're New (at E-Resources!)	Digital Storytelling in the Classroom	Striking a Balance: Using Web Analytics and More to Inform Decisions About Website Content	Self-Censorship and its Effect on Collection Development		
Grand Hall 5	E-Book Marketplace Updates	Language Learning in the Library	With Us, Not For Us: A History of Library Services to African Americans in Macon, Georgia	Well, That Took A While: An Anecdotal Comparison of the Job Application Process Between Public and Academic Libraries		
Olympia 1	We Felt The Need To Weed: Deselection Projects in Two Southeastern Academic Libraries	What's New in GALILEO	Reinvent Strategic Planning	Make Training Happen: Develop and Promote In-House Learning Opportunities		
Olympia 2	Lions, Penguins, and Poetry, Oh My!	Reading is Delicious: Fun, Fresh Food Programming for Kids	Cataloging Graphic Novels: Some Best Practices	Subject Headings in a Shared Environment: What's Best For Everyone?		
Empire	Green, Gold, & The Red White and Blue: Using Open Access and Government Information as a Representation of Searching as a Strategic Exploration in Information Literacy Instruction	Serving Patrons with Disabilities	Let's Play: Library Instruction	Library Web Usability Study: Quick and Dirty How-To's and Tips -and- Reimagining the Library Through Statistics: An Access Institution Story		
Off-site Tours			Re-discovering University of Georgia's Treasures (UGA Special Collections Library, 300 S. Hull; guided walk from Classic Center Atrium leaves at 3:00PM)			Movie Night and Trivia (Athens Regional Public Library)



REINVENT
REIMAGINE
REDISCOVER

LIBRARIES

THURSDAY, OCTOBER 6

Room	5:55AM - 7:00AM	7:30AM - 8:00AM	8:00AM - 8:45AM	9:00AM - 9:45AM	10:00AM - 10:45AM	11:00AM - 11:45AM	12:00PM - 1:15PM
Atrium			Registration 8:00AM - 5:00PM				
	Pat Carterette Memorial Walk/Run			Meeting of the Georgia Library Trustees, Friends, and Advocates Association			
Grand Hall 7			Coffee With The Vendors		Exhibits Open		
Oconee							Luncheon Keynote
Olympia 1		GLA Public Library Division		The Modern Classroom: Rediscover the Pulse of F2F Engagement -and- Library Instruction for Disabled and Neurodivergent Students	GLA Academic Library Division Paper PR and PA Discussion on Scholarly Writing and Publishing		
Olympia 2		GAIT Breakfast		Teen Programming Fun with 3D Pens!		An Introvert and an Extrovert Walk Into a Classroom: How Personality Type Affects Teaching Styles	
Parthenon 1			GLA Special Libraries and Information Services Division	Level Up Your S.T.E.A.M. Programs	PINNACLE Class of 2016 Reports		
Parthenon 2			GLA Paraprofessional Division	You Are Special: Paraprofessional Performance at its Best	Creating Curiosity: How Five Libraries Brought Creativity Educations to Their Tweens (and how you can too!)		
Grand Hall 1			Georgia Association for School Librarians	Mini-BOB: The Best of the Best... Thus Far 2016	Showcasing Our Gems: Unique Treasure From Public Libraries	Re-Integrating the Library and the Classroom through a "Faculty Fellows" Project	
Grand Hall 2			Georgia Independent College Association Libraries	Accessibility Compliance: What Does It Mean For Electronic Resources?	Reinventing Your Spaces to Advance Library and Campus Initiatives	More than Butts in the Seat! Outreach Programs enhance the Metaliteracy and Social Learning Concepts of the New Information Literacy Framework	
Grand Hall 4			SELA Library Instruction Round Table	A Very Specific Type of Geek: Adding Tabletop Games To An Academic Library Collection -and- Out of Your Comfort Zone Collection Management	A Bird in the Hand: Leveraging ILL Requests to Improve Electronic Resource Access	Foraging Alliances: Leveraging Internal and External Partnerships	
Grand Hall 5				Gathering Vision: Reinventing the Library in Leaderless Times	Consolidating Instruction Programs: How Did You Do That?	Simple Springshare Mashups: Cross-Platform Strategies for repurposing Digital Content for Multiple Audiences	
Athena A				GALILEO Tech Tips and Tricks	What Drives and Guides Us: The Improtance of Developing a Personal Philosophy of Librarianship	Resume Review Workshop	
Athena B				Brave New World: Observations During the Early Transition Between Public and Academic Libraries	Connecting with Your Campus through Collaborative Library Marketing	Developing & Managing Your School Library Volunteer Program	
Athena C				ALA Forum	Reinventing Library Services and Programs Using Tablets and iPads	Libraries Meeting the Special Needs and Interests of Older Adults	
Athena D				Beyond The One-Shot: The Next Generation of Library Instruction	Removing Barriers to One-Shot Assessment	Rediscovering Student Success: Library Instruction and GPA	
Athena G				Reinventing Library Instruction with the ACRL Framework	Sowing Seeds of Innovation: Interlibrary Collaboration to Build a Blossoming Seed Library	From One-Shot Instruction to Co-Teaching	
Athena H				Reinventing the Numbers Game: How Traditional Metrics and Altmetrics Work in Your Library	Engaging Teens with Passive Programming	The Amazing Author Club	
Athena I				Basic Legal Research for the Non-Law Librarian	They Do It Here: How Students Use Space in a Research Library	Primary and Educators' resources in the Digital Library of Georgia and Digital Public Library of America	
Athena J					Out of the Labs and Into the Libraries: How to Run a 3D Printing Program for the General Public	Homeschool: Highway to Harmony	Historical Hunt: Finding Government Information for Historical Research



REINVENT
REIMAGINE
REDISCOVER

LIBRARIES

THURSDAY, OCTOBER 6

Room	1:30PM - 2:15PM	2:30M - 3:30PM	3:45PM - 5:00PM	5:00PM - 6:00PM	6:00PM - 7:00PM	7:30PM - 9:30PM
Atrium	Registration			Authors Appreciation Reception	All- Conference Awards	NMRT/ Interest Group Dinner (Dutch Treat)
Grand Hall 7	Exhibits Open					
		Poster Session A				
Athena E&F			All Conference Meeting and Keynote Speaker			
Olympia 1	Introducing the Friends of Georgia Libraries					
Olympia 2	Media Tech Toolbox: Research Success Is Just A Click Away					
Parthenon 1	Different Roads to the Same Destination: ALMA Implementation at 3 Diverse Institutions					
Parthenon 2	Get That Grant!					
Grand Hall 1	NSF Data Management Requirements 101					
Grand Hall 2	Are You Being Served? Reevaluating Academic Library Policies for Diversity and Inclusion					
Grand Hall 4	Libraries And Writers, A Symbiotic Relationship					
Grand Hall 5	Bring The Magic Back					
Athena A	Design on a Dime: Library Displays and Merchandising on a Shoestring Budget					
Athena B	What USC Upstate Alumni Say About Information Literacy in the Workplace					
Athena C	Career Transitions: Reinvent Yourself for the Job Your Want! -and- Fantastic Student-Employees and Where to Find Them: Using Gamification and the World of Harry Potter to Engage Student Employees					
Athena D	Reinventing a Small Library Space -and- The Good, The Bad, & Parts Unknown: One Library's Tale of Renovation Lessons Learned					
Athena G	Public Library/High School Media Center Partnership-Book Club -and- Use of Social Media to Build Online Communities in Academic Libraries in Georgia					
Athena H	Re-Imagining Library Relationships					
Athena I	The Bookless Library as Community Organizer -and- Community Patron Access to Academic FDL P Libraries					
Athena J	Re-Imagining the Academic Library					



REINVENT REIMAGINE REDISCOVER LIBRARIES

FRIDAY, OCTOBER 7

Room	8:00AM - 8:45AM	9:00AM - 9:45AM	10:00AM - 10:45AM	11:00AM - 11:45AM	12:00PM - 1:30PM
Atrium	Registration				Scholarship Raffle
Grand Hall 7	Exhibits Open Coffee With The Vendors				
			Poster Session B		
Olympia 1	First Meeting of the Local History & Genealogy Interest Group	2016-2017 Georgia Student Media Festival Update		Digitize Your To-Do List: A Librarian's Introduction to KanbanFlow -and- Managing Your Library Projects by Using Trello	
Olympia 2	SELA Breakfast	TROLLS! In the Dungeon (aka Teens in the Library)		Peachy Keen - The Georgia Peach Book Award for Teen Readers	
Parthenon 1	Research and Assessment Interest Group Meeting	Invigorate Your Library's Learning Culture: Tips and Free Tools		Speed Mentoring: a new level of networking	
Parthenon 2	Government Information Interest Group Meeting	Chinese Students in KSU Libraries: Their Information Seeking Behaviors -and- Academic Librarian Outreach to Special Populations on Campus: What Works, What Doesn't		Getting the Word Out: Library Options for Captioning and CART	
Grand Hall 1	Interlibrary Loan Interest Group Meeting	GLASS Update: New Tools, New Tips		Home Scholars: Integrating Home School Programs Into Your Library	
Grand Hall 2	Technical Services Interest Group Meeting	Reimagine Resource Sharing with the New STAR Checklist		You Are Not Alone: A Forum For Librarians Grappling With Electronic Resources Issues	
Grand Hall 4	Information Technology Interest Group Meeting	Update on the Georgia State Copyright Lawsuit		Communicating Effectively during an LMS Migration: Hitting the Sweet Spot	
Grand Hall 5	Intellectual Freedom Interest Group Meeting	The Changing Typology of Library Buildings in an Information-Overload Environment		(Re)Discovering Genealogy in GALILEO	
Athena A	PACE (Professional and Continuing Education) Interest Group Meeting	Demonstrating the Library's Value for University Students' RPG		Connecting Concept Maps to Library Research	
Athena B	Distance Learning Interest Group Meeting	Rediscover Your Institution's History: Using an Institutional Repository to Highlight Special Collections Materials		Surveying the State of Library Assessment	
Athena C	Reference and Instructional Services Interest Group Meeting	Using Creative Commons Licenses		Spelunking the Internet: What Every Librarian Should Know About The Dark Web	
Athena D	Library Services for Patrons with Disabilities Interest Group Meeting	Summer Reading - Going Beyond the Books		Demonstrating Your Professional Value	
Athena G	Technical College Interest Group Meeting	Rediscover GALILEO: An Amazing Reference Resource		LIT-T3: Literature and Information Literacy through Technology, Teamwork, and Teaching	
Athena H	Facilities Interest Group Meeting	Look What's New at the DPLA!		STEM Programming @ Your Library: A How-To Approach	
Athena I	Collection Development Interest Group Meeting	Revitalizing Your Library's Health Information Services: An Overview of National Library of Medicine Consumer Health Resources		Self-Publishing and Collection Development in Libraries -and- uCOLEle! Ukelele Lending at Jacksonville State University's Houston Cole Library	
Athena J		Creating An Amazing Bookmobile on a Shoestring Budget			

Wednesday 8:00am-10:30am**Preconference Breakfast**

Location: Atrium

A continental breakfast will be served for all preconference attendees.

Wednesday 8:30am-12:00pm**Emergency Management Toolkit for Libraries**

Location: Grand Hall 4

Presenter(s): Chris Sharpe, Sandra Barclay, Cheryl Stiles

Contact: csharpe@kennesaw.edu

Next year will be the tenth anniversary of the Virginia Tech shootings, a critical event that necessitated institutions of higher learning to be better prepared for emergencies. This workshop will contribute to building a preparedness culture in libraries by allowing participants to learn how libraries can be prepared for various emergencies and create their own emergency management toolkit. It will be organized in four segments based on the FEMA's mission areas of emergency management: prevention, protection, mitigation, and response. Content includes developing an emergency plan, reviewing what other libraries are doing, and assessing threats to their institutions. The workshop will include several activities such as team building and tabletop exercises as well as a simulation of a threat. The presenters are librarians who are crisis coordinators at their campus and have undergone extensive emergency management training at their institution, in their community, and through FEMA.

Intended Audience: Multiple Library Types

Track(s): Administration; Professional Development

Wednesday 8:30am-12:00pm**Counting what counts: GPLS's IMLS B4 Grant Outcomes and PLA's Project Outcome**

Location: Grand Hall 5

Presenter(s): Elaine Black, Dr. Denise Davila, Samantha Lopez

Contact: eblack@georgialibraries.org

B4: Innovative Early Literacy to Revolutionize Family Engagement: Join us to learn how pilot libraries in Georgia transformed early literacy in their community using either PRIME TIME Preschool or Every Child Ready to Read parent workshops. Dr. Denise Davila, principal researcher for the project, will discuss what worked, what didn't, and ways your library can implement a similar program. This project was made possible in part by the Institute of Museum and Library Service, LG-07-0063-14.

Presented by Dr. Denise Dávila. Dávila is an assistant professor of literacy and children's literature at the University of Nevada, Las Vegas and a member of the graduate faculty at the University of Georgia. Currently, she is collaborating with public libraries in the Las Vegas Valley region to advance family literacy and STEM initiatives.

The Power of Performance: Project Outcome: Project Outcome offers and innovative and easy-to-use online platform for public libraries to measure the outcomes of their programs and services. Staff are able to view their results in an innovative and interactive data dashboard almost immediately, allowing for them to respond quickly to insights gained from patron feedback. For the first time, public libraries will have

free access to an aggregated set of performance measurement data and analysis tools they can use to affect change within their communities and beyond. This session will provide an overview of the tools and share lessons learned from libraries using Project Outcome.

Presented by Samantha Lopez. Lopez is the Project Coordinator for PLA's performance measurement initiative, Project Outcome, funded by the Bill & Melinda Gates Foundation, providing coordination, content, and user support.

Intended Audience: Public Libraries; School Libraries

Track(s): Administration; Children's Services; Elementary School

Wednesday 8:30am-12:00pm**GALILEO Preconference**

Location: Olympia 1&2

Presenter(s): Karen Minton

Contact: karen.minton@usg.edu

This year the preconference focuses on ebooks in GALILEO, genealogy, Explora, and a GALILEO 101 session to cover the basics. The format is a mini-conference with concurrent sessions. Cap: 30 attendees

Intended Audience: Multiple Library Types

Track(s): General Interest; Reference Services

Wednesday 8:30am-12:00pm**Alma/Primo Workflow Best Practices from the Georgia Vanguard's Perspectives**

Location: Empire

Presenter(s): Shelley Rogers, Guy Frost, Jessica Lee, Debra Skinner, Viki Timian, Kelly Holt, Steven Scheuler, Mary Poland

Contact: shelley@westga.edu

Sponsored by GLA Technical Services Interest Group and GIL Cataloging Functional Group

Alma and Primo form the new shared library system for the University System of Georgia! We hope you have gotten training provided by ExLibris, but why reinvent the wheel? Come to this preconference to discover what the Vanguard's (first implementers in the USC) have discovered works for them as best practices in their acquisitions, cataloging, circulation, and interlibrary loan workflows. Technical Services (called Resource Management in Alma) and Access Services (called Fulfillment) are discussed by implementers at University of Georgia, Georgia Southern University, and Valdosta State University. Prior experience is not required. Learn from the Vanguard's to avoid pitfalls and implement streamlined workflows from the start!

Contact: shelley@westga.edu

Intended Audience: Academic Libraries

Track(s): Circulation; Interlibrary Loan/ Document Delivery/ Resource Sharing; Technical Services/ Cataloging/ Acquisitions

Wednesday 8:30am-12:00pm**Librarians in Print: A Scholarly Approach to Library Research, Writing and Publishing**

Location: UGA Digital Humanities Lab (Meet in The Classic Center Atrium)

Presenter(s): Sarah Steiner

Contact: sksteiner@wcu.edu

Sponsored by GLA Academic Library Division

Are you nervous about getting started with scholarly or professional publishing, or looking to hone your skills? In this preconference, we'll discuss the various aspects of academic publishing: getting started, selecting a topic, selecting a research methodology, finding an appropriate place to publish, and handling suggestions and rejection from editors. Attendees are strongly encouraged to come with an idea for a scholarly publication. We will workshop your ideas together, and you will leave with a plan for your publication. Attendees will meet in The Classic Center Atrium at 8:30 for breakfast and walk together to the UGA Library. Please arrive at The Classic Center no later than 8:45am.

Cap: 30 attendees

Intended Audience: Academic Libraries

Track(s): Professional Development

Wednesday 8:30am-12:00pm**Points, Polygons, and Possibilities: an Introduction to GIS for the Novice**

Location: UGA Libraries Main Lab A (Meet in The Classic Center Atrium)

Presenter(s): Hallie Pritchett, Meagan Duever

Contact: hpritche@uga.edu

Have you ever wanted to try your hand at a GIS (geographic information system) but didn't know where or how to start? This hands-on introductory workshop will cover the basics of to using a GIS to make a map. No experience or equipment necessary - join us in the UGA Libraries Main Lab A to learn how to use this increasingly popular data visualization tool. Attendees will meet in The Classic Center Atrium at 8:30 for breakfast and walk together to the UGA Lab. Please arrive at The Classic Center no later than 8:45am. Cap: 20 attendees

Intended Audience: Multiple Library Types

Track(s): Government Docs; Info Technology

Wednesday 9:00am-10:00am**GAIT Board of Directors Meeting**

Location: Grand Hall 1

Presenter(s): Gordon Baker

Contact: gordonbaker@clayton.edu

Wednesday 10:00am-12:00pm**SELA Executive Board Meeting**

Location: Grand Hall 1

Presenter(s): Gordon Baker

Contact: gordonbaker@clayton.edu

Wednesday 10:00am-12:00pm**GLA Executive Board Meeting**

Location: Grand Hall 2

Presenter(s): Cathy Jeffrey

Contact: cathy.GLA2016@gmail.com

Wednesday 1:30pm-3:15pm**Be Prepared - Keeping Your Staff, Library Users, and You Safe If The Unthinkable Occurs**

Location: Grand Hall 1

Presenter(s): Sarah Mauldin

Contact: smaULDin@sgrlaw.com

With discussions of Georgia's campus carry law and reports of mass shootings and other attacks in the news it's time to talk about what you would do if violence erupts where you are. A University of Georgia Office of Preparedness trainer will present its well-reviewed Active Shooter training and answer questions on what to do to be prepared for the unthinkable.

Intended Audience: Multiple Library Types

Track(s): General Interest; Physical Space

Wednesday 1:30pm-2:15pm**Full STEAM Ahead! The First Year of the STEAM Engine at West Georgia Regional Library**

Location: Grand Hall 2

Presenter(s): Justin Nobles, Teresa Jones, Roni Tewksbury

Contact: justin@wgrl.net

Come learn about the development and first year of the West Georgia Regional Library STEAM Engine, one of Georgia's first ever mobile makerspaces. With modules ranging from 3D printing and robotics to photography and scrapbooking, come learn how we take this show on the road multiple times a week. Get ideas about how to make your mobile makerspace, and come hear about our plans for the future! In addition, we will be bringing out our STEAM Engine van.

Intended Audience: Multiple Library Types; Public Libraries

Track(s): General Interest; Technology

Wednesday 1:30pm-2:15pm**What To Do When You're New (at E-Resources!)**

Location: Grand Hall 4

Presenter(s): Kevin Shehan, Christopher Stotelmyer

Contact: kshehan@uscupstate.edu

Sponsored by SELA Electronic Resources Roundtable

New to electronic resources? Not so new but feeling overwhelmed?

Perhaps just curious about what coordinating e-resources entails? Two newer academic e-resources librarians share their experiences, dealing specifically what they learned once on the job. Topics covered include record keeping, gathering and interpreting statistics, troubleshooting and where to find help (listservs, etc.).

Intended Audience: Multiple Library Types; Academic Libraries

Track(s): General Interest

Wednesday 1:30pm-2:15pm

E-book Marketplace Updates

Location: Grand Hall 5

Presenter(s): Wendy Cornelisen

Contact: wcornelisen@georgialibraries.org

The e-book lending market is an ever-changing landscape. Libraries across the country are exploring options for acquiring and delivering digital content that leverage the power of libraries, deliver good user experiences, and are consistent with library values. This session will provide an update and discuss the best ways for libraries to advance access to digital collections, with a focus on the collaborative and innovative efforts of two IMLS grant funded projects: SimplyE and the Library E-content Access Project (LEAP).

Intended Audience: Multiple Library Types

Track(s): Collection Development; Technology

Wednesday 1:30pm-2:15pm

We Felt the Need to Weed: Deselection Projects in Two Southeastern Academic Libraries

Location: Olympia 1

Presenter(s): Camille McCutcheon, Gordon Baker

Contact: CMCCUTCHEON@uscupstate.edu

Sponsored by SELA

During this session, librarians will discuss their experiences with recent weeding projects in their respective libraries. Following a SACS visit, the Clayton State University Library staff needed to weed their aging collections. In addition, the Library was preparing for an upcoming renovation which stressed the need for additional student spaces. At the University of South Carolina Upstate, an analysis and extensive weeding of the bound periodical and microfilm collections occurred, the first since the library opened its doors in 1967. Deselection methodology and criteria will be discussed. The presenters will share what they learned from these projects as well as what they would do differently next time. A question and answer session will be open to participants.

Intended Audience: Academic Libraries; Emerging Librarians/ MLIS Students

Track(s): Collection Development; Technical Services/ Cataloging/ Acquisitions

Wednesday 1:30pm-2:15pm

Lions, Penguins and Poetry, Oh My!

Location: Olympia 2

Presenter(s): Irene Latham

Contact: irene@irenelatham.com

Explore the wilds of nature writing from Antarctica to Africa with author Irene Latham. In this hands on workshop attendees will learn various strategies to engage readers and create and nurture armchair naturalists through art and writing activities that generate personal connections while celebrating the wonder of animals and their unique ecosystems.

Intended Audience: Public Libraries; School Libraries

Track(s): General Interest; Children's Services; Elementary School

Wednesday 1:30pm-2:15pm

Green, Gold, & The Red White and Blue: Using Open Access and Government Information as a Representation of Searching as a Strategic Exploration in information Literacy Instruction.

Location: Empire

Presenter(s): Seth Porter

Contact: seth.porter@library.gatech.edu

This presentation will offer a meta-analysis of the pertinent literature on Searching as a Strategic Exploration and will cover best practices in using open access and government information in information literacy instruction, research consultations, and conversations with faculty about potential library services. The presenter will reflect on personal experience in teaching, performing embedded librarianship, and using open access and government information in the information literacy curriculum. This presentation will cover the different elements of searching as strategic exploration and ways in which academic librarians can improve their information literacy instruction through the adoption of diverse resources that embody information literacy and strategic exploration as a life-long pursuit.

Intended Audience: Academic Libraries

Track(s): General Interest; Assessment; Government Docs; Info Instruction; Outreach/ Marketing/ Public Relations

Wednesday 2:30pm-3:15pm

Use Programming Grants to Reinvent and Revitalize Your Library

Location: Grand Hall 2

Presenter(s): Alyssa Martin, Christopher Staffer, Lisa Vardaman

Contact: almartin@troy.edu

Troy University librarians will discuss how a variety of programming grants reinvented and revitalized three Troy University Libraries. Librarians will also give best practices for implementing successful grants, including tips on how to successfully write, promote, host and evaluate programs. Since 2010, the Troy University Libraries have received numerous grants including film series such as the Pragma Spanish Film Festival, lecture series, book talks, exhibits and concerts. Librarians will talk about some memorable programs including Let's Talk About It: Muslim Journeys, and Ann Rosenheck: A Witness to the Holocaust. Troy University librarians will highlight one of their most exciting program experiences, the Latino Americans: 500 Years of History grant. Three Troy University Libraries held public screenings of the PBS documentary film Latino Americans: 500 Years of History, and hosted speakers and an art exhibit at the Rosa Parks Museum. Results of data gathered will be shared.

Intended Audience: Multiple Library Types; Academic Libraries

Track(s): General Interest; Outreach/ Marketing/ Public Relations

Wednesday 2:30pm-3:15pm

Digital Storytelling in the Classroom

Location: Grand Hall 4

Presenter(s): Daryl Funn, Tom Lewis

Contact: tlewis6520@gmail.com

Digital Storytelling allows middle and high school students to work alongside an Alliance Arts for Learning (AA4L) Institute teaching artist to explore the full creative process of telling a digital story with tools such as images, text, audio, interactive illustrations, and music. Each student produces a 3-5 minute digital story. Examples of previous writing prompts include personal narratives, reflections on a mentor text, studies of historical time periods, and persuasive essays. The theme of the residency will be decided by the teacher and teaching artist. Digital Storytelling is a 12-session in-classroom residency. The AA4L Institute can bring iPads to use at schools that do not have the technology.

Intended Audience: Academic Libraries; School Libraries

Track(s): Children's Services; Elementary School; Young Adult or Youth Services; Middle or High School

Wednesday 2:30pm-3:15pm

Language Learning in the Library

Location: Grand Hall 5

Presenter(s): Andrea Faulk

Contact: faulka@mail.henry.public.lib.ga.us

Sponsored by GPLA

I will present the importance of offering language classes in the library and methods for doing so. The library is a safe, neutral place for patrons to come to learn a new language. The library is quiet (hopefully) and offers resources to connect to the community, such as newspapers, bulletin boards with community events, library programs, etc. I will focus especially on English as a Second Language classes and how to connect these patrons to other services and programs in the library, such as Spanish-speakers practicing with students learning Spanish. Language Learning in the Library would help equip people who want to offer English classes in their library but may feel unprepared to do so.

Intended Audience: Public Libraries; School Libraries

Track(s): Instruction; Outreach/ Marketing/ Public Relations

Wednesday 2:30pm-3:15pm

What's New in GALILEO

Location: Olympia 1

Presenter(s): Karen Minton

Contact: karen.minton@usg.edu

Join GALILEO staff for information on GALILEO services and enhancements with time built in to address your questions and comments.

Intended Audience: Multiple Library Types

Track(s): General Interest; Reference Services

Wednesday 2:30pm-3:15pm

Reading is Delicious: Fun, Fresh Food Programming for Kids

Location: Olympia 2

Presenter(s): Irene Latham

Contact: irene@irenelatham.com

Want to create programs that bring kids and their families to the library? Make them about FOOD! Join an award-winning author in a delicious celebration of peaches, corn, watermelon and more as she take you on a journey through her latest food-themed picture book and related titles to offer fresh, fun, hands-on activities to delight readers and leave them hungry for more.

Intended Audience: Public Libraries; School Libraries

Track(s): General Interest; Children's Services; Elementary School

Wednesday 2:30pm-3:15pm

Serving Patrons with Disabilities

Location: Empire

Presenter(s): Stephanie Irvin, Dyana Costello Banks

Contact: sirvin@georgialibraries.org

Sponsored by GLA Library Services for Patrons With Disabilities Interest Group

This presentation gives ideas on how to best serve patrons with disabilities, giving examples from the members of the GLA Library Services for Persons with Disabilities Interest Group. We will also cover how to address the patron with respect.

Intended Audience: Multiple Library Types

Track(s): General Interest

Wednesday 3:30pm-4:15pm

Re-imagine Patron Services Through User Feedback

Location: Grand Hall 1

Presenter(s): Viki Timian, Mary Poland

Contact: vtimian@uga.edu

Your library collects data in a multitude of ways. The UGA Libraries' have expanded services based on information gathered through LibQual, usage statistics, surveys and advisory groups - to name only a few sources. Using this collected data and working with other UGA departments, the libraries developed an intra-library retrieval service, instituted a bicycle checkout program, and received funding for renovating more study areas and creating a MakerSpace. Find out how we have implemented these services to improve the user experience at the Main and Science Libraries.

Intended Audience: Multiple Library Types; Academic Libraries

Track(s): Assessment; Circulation

Wednesday 3:30pm-4:15pm

Maximize the Potential of Your Library with Community Partnerships

Location: Grand Hall 2

Presenter(s): Tammy Gerson, Priscilla Lewis, Marsha Carlan

Contact: tgerson@athenslibrary.org

Public Librarians Marsha Carlan, Tammy Gerson, and Priscilla Lewis will discuss recent, successful collaborative community projects, such as The Big Read and Money Smart Week. They will suggest resources, models, and tips on how to maintain and build partnerships that build community bridges and education.

Intended Audience: Multiple Library Types; Academic Libraries; Public Libraries; School Libraries; Special Libraries

Track(s): Young Adult or Youth Services; Middle or High School; Outreach/ Marketing/ Public Relations

Wednesday 3:30pm-4:15pm

Striking a Balance: Using Web Analytics and More to Inform Decisions About Website Content

Location: Grand Hall 4

Presenter(s): Adam Olsen

Contact: aolsen3@kennesaw.edu

This presentation deals with the opportunities and challenges afforded by building a new library website in a new CMS, while utilizing data from an existing website, as well as input from various stakeholders.

The presentation will include discussion of the web analytics tools used, and how the data from those tools must be used in conjunction with consideration for the needs of library patrons and staff.

Intended Audience: Multiple Library Types; Academic Libraries

Track(s): General Interest; Assessment; Technology

Wednesday 3:30pm-4:15pm

With Us, Not for Us: A History of Library Services to African Americans in Macon, Georgia

Location: Grand Hall 5

Presenter(s): Shaundra Walker

Contact: shaundra.walker@gcsu.edu

This presentation will illuminate the struggle for inclusive public library services in Macon, Georgia. By placing the African American architects of the struggle at the center of the story, this presentation will add to existing narratives on Southern public library history, revealing the tenacity of Macon's African American community in both securing and administering public library services for their race. The story at Macon will also provide a unique lens through which to examine how African Americans and Whites interacted within the political and social landscape of a small, southern town during the Jim Crow era.

Intended Audience: Academic Libraries; Archives; Public Libraries

Track(s): General Interest; Special Collections; Archives

Wednesday 3:30pm-4:15pm

Reinvent Strategic Planning

Location: Olympia 1

Presenter(s): Wendy Cornelisen, Alan Harkness, Melody Jenkins, Anna Lyle

Contact: wcornelisen@georgialibraries.org

The challenges facing librarians are real, complex, and varied. As such, they require thoughtful planning and strategic implementation. This year GPLS partnered with Library Strategies, the consulting group within The Friends of the Saint Paul Public Library, to train 14 Georgians in their Rapid Results Planning program. Come learn about this new approach to strategic planning, and see the results of the initial pilot sites from around the state.

Intended Audience: Public Libraries

Track(s): Administration; Outreach/ Marketing/ Public Relations

Wednesday 3:30pm-4:15pm

Cataloging Graphic Novels: Some Best Practices

Location: Olympia 2

Presenter(s): Linh Uong

Contact: luong@negeorgialibraries.org

How should you catalog, label and shelve your graphic novels? This session answers those questions with an overview of Best Practices from academic and public libraries in Georgia and across the country, and describes the implementation of the multipart functionality in PINES.

Intended Audience: Academic Libraries; Public Libraries

Track(s): Technical Services/ Cataloging/ Acquisitions

Wednesday 3:30pm-4:15pm

Let's Play: Library Instruction

Location: Empire

Presenter(s): Rebecca Engsborg, Jean Cook, Karen Doster-Greenleaf, Amy Stalker

Contact: engsborg_rl@mercer.edu

Sponsored by GLA Reference and Instruction Services Interest Group

By tapping into curiosity, creativity, and a sprinkling of competitiveness, instruction through games can be engaging, exciting, and energizing.

The panel presentation will discuss the theory of gaming in teaching, including examples the presenters have used in their classrooms.

Intended Audience: Multiple Library Types

Track(s): General Interest; Instruction

Wednesday 3:30pm-5:00pm

Re-discovering University of Georgia's Treasures

Location: UGA Special Collections Library, 300 S. Hull (For guided walk, meet in The Classic Center Atrium at 3:00pm; tour will leave promptly)

Presenter(s): Tamika Barnes

Contact: tbarnes24@gsu.edu

Did you know that UGA has such things as the Peabody Awards Collection, historical maps and amateur films highlighting Georgia? Join the Special Libraries Division on a tour of the Special Collections Libraries at the University of Georgia to learn about these and other rare and unique materials they have acquired and how people use these materials in the classroom and for personal research.

Intended Audience: Academic Libraries; Archives; Special Libraries

Track(s): General Interest; Special Collections; Archives

Wednesday 4:30pm-5:15pm

Reimagining the Library's Connection to Student Success: An Assessment Revelation

Location: Grand Hall 1

Presenter(s): Alison Sperry, Florence Wakoko, Paul Luft, Paula Adams

Contact: sperry_alison@columbusstate.edu

Participants will learn how methods of collecting meaningful data can reveal much about how well their library contributes to student success as well as other institutional communities and goals. The Columbus State University Libraries assessment study provides a holistic way data can be measured and analyzed to reveal user attitudes, usage patterns and ideas for a better approach to providing academic support. This presentation will illustrate how CSU Libraries used comprehensive assessment methods to generate qualitative and quantitative data that link the value of the library to institutional goals and successes.

Intended Audience: Academic Libraries

Track(s): General Interest; Assessment

Wednesday 4:30pm-5:15pm

Media Specialist Advocacy and Evaluation: How the MKES Offers Support

Location: Grand Hall 2

Presenter(s): Phyllis Snipes, Susan Grigsby

Contact: psnipes@westga.edu

"Reinvent, re-imagine, and rediscover" library media specialists as well as libraries! The Media Specialist Keys Effectiveness System (MKES) was developed for that very purpose. It presents a clear framework of what the practicing school library media specialist should be able to accomplish through a powerful media program. It has been introduced across the state as an advocacy tool that is an excellent guide for discussing the roles of the media specialist with administrators, teachers, and community members. Some school districts in Georgia have implemented the MKES and this session will report the observations and recommendations for improvements from those districts as well as provide a report from the Georgia School Library Media Consortium. Whether participants are interested in learning about MKES as a media specialist evaluation tool or just want to revisit it as a strong advocacy tool, this session will provide information about both opportunities.

Intended Audience: Emerging Librarians/ MLIS Students; School Libraries

Track(s): Administration; Assessment; Outreach/ Marketing/ Public Relations

Wednesday 4:30pm-5:15pm

Self-Censorship and its Effect on Collection Development

Location: Grand Hall 4

Presenter(s): Dr. Vicki L. Gregory, Tim Dodge

Contact: dodgeti@auburn.edu

Sponsored by SELA Intellectual Freedom Committee

The presenter is Dr. Vicki L. Gregory, Professor, School of Information, University of South Florida. Presentation plus question-and-answer.

Intended Audience: Multiple Library Types

Track(s): General Interest, Collection Development

Wednesday 4:30pm-5:15pm

Well, That Took A While: An Anecdotal Comparison of the Job Application Process Between Public and Academic Libraries

Location: Grand Hall 5

Presenter(s): Jessica Garner

Contact: jgarner@georgiasouthern.edu

When a position for Interlibrary Loan Librarian came open at Georgia Southern University in the latter part of 2015, I was intrigued. Although ensconced happily in a public library position and a 10-year veteran of public systems, the lure of an academic position-along with logistical considerations-prompted me to apply for the position. I believe my observations about the hiring, though anecdotal, begin to unravel a conversation comparing and contrasting academic libraries with public libraries, possibly to the benefit of both institutions.

Intended Audience: Multiple Library Types; Academic Libraries; Public Libraries

Track(s): General Interest; Administration; Career Advice; Professional Development

Wednesday 4:30pm-5:15pm

Make Training Happen: Develop and Promote In-House Learning Opportunities

Location: Olympia 1

Presenter(s): Meghan Johnson, Joan Blalock

Contact: meghanj@infodepot.org

Stretched thin on time and funds to send staff to training outside your library system? Learn how the Spartanburg County Public Libraries (SC) integrate training into daily activities with our monthly RTP Training Review and how our managers make time for ongoing learning. Step by step, we will cover how to develop monthly self-guided training by utilizing the expertise of staff and share templates for setting up your own program. We will also discuss our Self-Directed Achievement program where managers encourage continued learning by scheduling time off desk for staff to complete self-selected training. Keeping staff up to date on library tools, resources, and trends can be handled in house, even if you don't have a Training Department!

Intended Audience: Multiple Library Types; Public Libraries

Track(s): Professional Development

Wednesday 4:30pm-5:15pm

Subject Headings in a Shared Environment: What's Best For Everyone?

Location: Olympia 2

Presenter(s): Sandra Barclay, Hyun Chu Kim, Emily Williams

Contact: sbarclay@kennesaw.edu

Academic catalogers explore recent changes in subject heading and thesauri use. A brief history of LCSH (Library of Congress Subject Headings) from the Paris Principles to IFLA's Statement of International Cataloguing Principles will be presented. Our investigation into the use of thesauri other than LCSH in large academic libraries will be shared, as well as recommendations for use in a shared catalog.

Intended Audience: Multiple Library Types; Academic Libraries

Track(s): Reference Services; Technical Services/ Cataloging/ Acquisitions

Wednesday 4:30pm-5:15pm

Half-Sessions Location: Empire

Library Web Usability Study: Quick and Dirty How-To's and Tips

Presenter(s): Stephanie Adams

Contact: sjadams@tntech.edu

Tennessee Tech University has embarked upon a multi-semester usability study of our library website. Currently, we have completed one semester of testing with 17 participants including undergraduate students, graduate students, and faculty. The presenter will share advice on choosing a usability study committee, dealing with an IRB, designing user tasks, recruiting participants, and selecting usability testing software. She will also focus on difficulties that arose during the study and offer tips to avoid some of the pitfalls TTU encountered. Finally, she will share some of the outcomes and suggestions gleaned from the first set of participants as well as the next steps in the study.

Intended Audience: Multiple Library Types; Academic Libraries

Track(s): Assessment

Reimagining the Library Through Statistics:

An Access Institution Story

Presenter(s): Amanda McKenzie, Katie Shepard

Contact: amckenzie@ega.edu

In August 2015, the East Georgia State College Library implemented a new tactic for gleaning usage statistics using Google Forms. This “home-grown” approach was both free and easy to implement and allows the library to glean both quantitative and qualitative information from our previously stagnant reference statistics. The Google Form enables the library to conduct a more in-depth analysis of data, allowing us to see how we assist our patrons at both a granular and high-level view and what other parts of the college we touch. The flexibility of the Google Form allows the library to adapt the form quickly when a new type of information would be beneficial to assess. By using the information gathered through the Google Form, we have been able to reinvent spaces, projects, and services as soon as the transaction is completed, creating a rapidity of changing service-levels that have delighted our users.

Intended Audience: Multiple Library Types, Academic Libraries

Track(s): General Interest, Assessment

Dinner on Your Own

Visit the Athens CVB in the main lobby of The Classic Center

Wednesday 7:00pm-9:00pm

Movie Night & Trivia

Location: Athens-Clarke County Library [2025 Baxter St, Athens, GA 30606 - 2.5 miles away]

Conference Movie Night will be showing “The Princess Bride” at the Athens-Clarke County Library [2025 Baxter St, Athens, GA 30606]. Movie Trivia, Door Prizes and Refreshments will make for a great mawage of fun and fellowship!

Directions and map to the Athens-Clarke County Library can be found at the end of the program. Free parking is available for library visitors.

Thursday 5:55am-7:00am

Pat Carterette Memorial Walk/Run

Location: Meet in front of The Classic Center (300 N Thomas St)

Presenter(s): Elizabeth McKinney

Contact: emckinney@georgialibraries.org

Thursday 7:30am-9:00am

GAIT Breakfast

Location: Olympia 2

Presenter(s): Gordon Baker

Contact: gordonbaker@clayton.edu

Thursday 8:00am-9:00am

Coffee With The Vendors

Location: Grand Hall 7

Meet the COMO exhibitors and share a complimentary coffee!

Thursday 8:00am-8:45am

GLA Public Library Division Business Meeting

Location: Olympia 1

Presenter(s): Beth McIntyre

Contact: bmcintyre@prlib.org

Thursday 8:00am-8:45am

GLA Special Library and Information Services Division Business Meeting

Location: Parthenon 1

Presenter(s): Tamika Barnes

Contact: tbarnes24@gsu.edu

Thursday 8:00am-8:45am

GLA Paraprofessional Division Business Meeting

Location: Parthenon 2

Presenter(s): Tangela McKibbens

Contact: mckibbenst@mail.henry.public.lib.ga.us

Thursday 8:00am-8:45am

Georgia Association For School Librarians

Location: Grand Hall 1

Presenter(s): Stephanie Jones

Contact: sjones@georgiasouthern.edu

Thursday 8:00am-8:45am

Georgia Independent College Association Libraries

Location: Grand Hall 2

Presenter(s): Lisa Macke

Thursday 8:00am-8:45am

SELA Library Instruction Round Table meeting

Location: Grand Hall 4

Presenter(s): Michael Wilson

Contact: mwwilson@valdosta.edu

Thursday 9:00am-9:45am

Meeting of the Georgia Library Trustees, Friends, and Advocates Association

Location: Atrium

Presenter(s): Gordon Baker

Contact: gordonbaker@clayton.edu

Thursday 9:00am-9:45am

Half-Sessions Location: Olympia 1

The Modern Classroom: Rediscover the Pulse of F2F Engagement

Presenter(s): Michelle Jones

Contact: jones_michelle@columbusstate.edu

Interested in low-tech tools to engage your students in a face to face class? This session will explore a few easy to use options that not only give you feedback about what your students are learning, but help

students feel more comfortable participating in class. Reinvent your course using these ideas as well as share some of your own!

Intended Audience: Academic Libraries

Track(s): General Interest; Instruction

Library Instruction for Disabled and Neurodivergent Students

Presenter(s): Morgan Rhett

Contact: mrhett@kennesaw.edu

Examining instruction librarians' preparedness for teaching students who have physical and/or learning disabilities. Instruction librarians doing one shots in classrooms are often not informed ahead of time by the professor that such students are present in the lesson. Instruction librarians must be prepared to serve students with disabilities "on the fly".

Thursday 9:00am-9:45am

Teen Programming Fun with 3D Pens!

Location: Olympia 2

Presenter(s): Aimee Leavitt

Contact: leavitta@mail.henry.public.lib.ga.us

As libraries evolve with technology we find many new things to offer our patrons for programming. Henry County Library System has recently won a generous technology grant. We were able to purchase several new tech items. 3Doodler pens were one of these sets. I will bring our entire set (along with information about the sets) to teach others how they work and to inspire them to bring this tech into their libraries for their teen and adult programming.

Intended Audience: Multiple Library Types; Academic Libraries; Public Libraries; School Libraries

Track(s): General Interest; Young Adult or Youth Services; Middle or High School; Instruction Technology

Thursday 9:00am-9:45am

Level Up Your S.T.E.A.M. Programs

Location: Parthenon 1

Presenter(s): Margaret Penn, Radha Ashok, Arlene Melton

Contact: mpenn@gwinnettpl.org

The Hamilton Mill and Centerville Branches of Gwinnett County Public Library (GCPL) have both held a variety of successful S.T.E.A.M. programs for customers of all ages. Seeking to develop more intensive S.T.E.A.M. experiences, the branches developed multi-day, cumulative learning programs designed to incorporate various S.T.E.A.M. concepts and materials into creative and fun learning opportunities for children and teens. These programs, with marketing support from area schools, provided meaningful hands-on learning experiences at minimal cost to the library. Come learn how to take your S.T.E.A.M. programs to the next level without busting your budget.

Intended Audience: Public Libraries

Track(s): General Interest; Children's Services; Elementary School; Young Adult or Youth Services; Middle or High School; Technology

Thursday 9:00am-9:45am

You Are Special: Paraprofessional Performance at its Best

Location: Parthenon 2

Presenter(s): Tangel McKibbens, Karen Manning, Dawn Dale, Roland Garner

Contact: mckibbenst@mail.henry.public.lib.ga.us

Sponsored by GLA Paraprofessional Division

Paraprofessionals are significantly involved in major functions within the library profession. Their contributions include performance in workplace extended duties, involvement in organizations and associations, policy making, marketers, and numerous other tasks that are assigned or gained. This program serves to motivate and inform paraprofessional of development methods that may lead to higher opportunities.

Intended Audience: Multiple Library Types

Track(s): General Interest; Professional Development

Thursday 9:00am-9:45am

Mini-BoB: The Best of the Best ... Thus Far 2016

Location: Grand Hall 1

Presenter(s): Cindy Welch

Contact: cwelch11@utk.edu

What are you reading? Did it make the cut? This session features a brief version of the popular Best of the Best (Thus Far) program presented each summer by the University of Tennessee Center for Children's & Young Adult Literature. Join Associate Director, Dr. Cindy Welch, and explore the newest and best literature that will help you reimagine and reinvent your school or public library youth collections. Features literature for birth through new adult.

Intended Audience: Public Libraries; School Libraries

Track(s): Collection Development; Children's Services; Elementary School; Young Adult or Youth Services; Middle or High School

Thursday 9:00am-9:45am

Accessibility Compliance: What Does It Mean for Electronic Resources?

Location: Grand Hall 2

Presenter(s): Stephanie Adams

Contact: sjadams@tntech.edu

Sponsored by SELA Resources and Technical Service Section

Accessibility compliance is a growing concern for universities as it pertains to instructional materials on websites, course management systems, and course documents. This extends to materials provided by academic libraries such as electronic resources. This presentation will discuss plans developed by the Tennessee Board of Regents Libraries Accessibility Task Force that include an initial audit of web-based subscription databases and the creation of a repository of vendor documents addressing product accessibility compliance such as the Voluntary Product Accessibility Template (VPAT). Accessibility standards as described in WCAG 2.0, EPUB3, and Section 508 of the Rehabilitation Act of 1973 will also be covered. Finally, the presenter will discuss measures that the Tennessee Tech Library and University Procurement are taking to obtain documentation from vendors for all new and renewal electronic resources as well as incorporating compliance language into licenses and RFQs.

Intended Audience: Academic Libraries; Public Libraries

Track(s): Technical Services/ Cataloging/ Acquisitions

Thursday 9:00am-9:45am

Half-Sessions Location: Grand Hall 4

A Very Specific Type of Geek: Adding Tabletop Games To An Academic Library Collection

Presenter(s): Jonathan Klotz

Contact: jrklotz@valdosta.edu

VSU's Odum Library has a thriving tabletop game collection designed for college students. Learn how to create, develop and market a collection of your own.

Intended Audience: Multiple Library Types; Academic Libraries

Track(s): General Interest; Outreach/ Marketing/ Public Relations

Out of Your Comfort Zone Collection Management

Presenter(s): Angela Megaw

Contact: amegaw@ung.edu

You get a new job or someone leaves and suddenly you've been assigned to do collection development and management for an area you know nothing about. What do you do? How do you figure out if this book is a "classic" and should be kept or should it be weeded? This talk will share strategies and lessons learned in doing collection management in areas outside of your current expertise.

Intended Audience: Academic Libraries; Public Libraries

Track(s): Collection Development

Thursday 9:00am-9:45am

Gathering Vision: Reinventing the Library in Leaderless Times

Location: Grand Hall 5

Presenter(s): Kaetrena Davis Kendrick, Rebecca Freeman

Contact: kaetrena@mailbox.sc.edu

A hallmark of American academic librarianship is solid, formal library leadership. But what happens when a leadership position is (suddenly) vacated or if the position is open for longer than expected? This session discusses the importance of strategic planning, library advocacy, communication transparency, succession planning, and successfully leading from the middle during formal leadership gaps; with a particular focus on small and rural academic libraries.

Intended Audience: Multiple Library Types; Academic Libraries

Track(s): Administration; Outreach/ Marketing/ Public Relations

Thursday 9:00am-9:45am

GALILEO Tech Tips and Tricks

Location: Athena A

Presenter(s): Mike White

Contact: mike.white@usg.edu

This session will illustrate a number of easy-to-use backend tools can help schools add links and widgets to school or media center websites and other pages, making it easier for students to get to content. We will also cover database tech tips, such as how to use persistent links to ebooks and articles. The mobile section will include how to save the GALILEO website to the home screen and how to set up ebook readers.

Intended Audience: Multiple Library Types; Support Staff

Track(s): General Interest; Technical Services/ Cataloging/ Acquisitions

Thursday 9:00am-9:45am

Brave New World: Observations During the Early Transition Between Public and Academic Librarians

Location: Athena B

Presenter(s): Jessica Garner

Contact: jgarner@georgiasouthern.edu

After a decade in public libraries, a move to the world of academic libraries is exciting, new and-sometimes-an exercise in learning how to see the world one is accustomed to as if it were suddenly turned slightly sideways. This discussion address the little differences a newcomer to academic libraries sees in the first months of an academic career and asks the audience to think about little details of their everyday business that may not be as little as they believe.

Intended Audience: Multiple Library Types; Academic Libraries; Public Libraries

Track(s): General Interest; Career Advice

Thursday 9:00am-9:45am

ALA Forum

Location: Athena C

Presenter(s): Amy Eklund, Tamika Barnes, John Mack Freeman, Kimberly Boyd

Contact: amypeklund@hotmail.com

Join some of Georgia's member leaders of the American Library Association (ALA) to learn more about their roles in the national association and how ALA membership can benefit you. Also, learn about GLA's participation in the ALA Midwinter 2017 conference and how you can get involved.

Intended Audience: Multiple Library Types

Track(s): General Interest; Professional Development

Thursday 9:00am-9:45am

Beyond the One-Shot: The Next Generation of Library Instruction

Location: Athena D

Presenter(s): Jeff Graveline, Brooke Becker

Contact: jgraveli@uab.edu

Are you tired of the one shot? Have you found its effectiveness lagging? Do you want more? Come learn how to breathe new life into your library's instruction program and engage your academic community. In this session, attendees will learn how to create a new or adapt their current instruction programs into successful, in-depth, semester-long certificate programs tailored to the needs of their own academic communities. The certificate programs designed by our librarians have been recognized by campus administrators as an integral part of the campus-wide educational experience and have won awards at both the national and international levels.

Intended Audience: Academic Libraries

Track(s): Instruction; Reference Services

Thursday 9:00am-9:45am

Reinventing Library Instruction with the ACRL Framework

Location: Athena G

Presenter(s): Diane Fulkerson

Contact: dfulkerson@sar.usf.edu

With the recent adoption of the ACRL Framework academic librarians have the opportunity to reinvent and redesign their library instruction session. This presentation will provide attendees with an overview of how to use the Framework to design their one-shot library instruction sessions.

Intended Audience: Academic Libraries; School Libraries

Track(s): Assessment; Instruction

Thursday 9:00am-9:45am

Reinventing the Numbers Game: How Traditional Metrics and Altmetrics Work in Your Library?

Location: Athena H

Presenter(s): Paolo Gujilde, Ashley Lowery

Contact: pgujilde@georgiasouthern.edu

Impact Factors? Citation Reports? Altmetrics? What does it all mean?

This session will bring perspectives and understanding to publication metrics for library personnel and library school students. Gujilde will focus on traditional metrics such as impact factors and citation reports and its impact on core library services. Lowery will discuss altmetrics and its influence on the current research landscape. Examples of application of publication metrics from Georgia Southern University will be highlighted throughout the session.

Intended Audience: Multiple Library Types; Emerging Librarians/ MLIS Students

Track(s): General Interest; Outreach/ Marketing/ Public Relations

Thursday 9:00am-9:45am

Basic Legal Research for the Non-Law Librarian

Location: Athena I

Presenter(s): Sarah Mauldin

Contact: smauldin@sgrlaw.com

Have you ever encountered a patron seeking help with a legal question? Did you know how to help them? If not, please join us for an hour of fact filled fun as we show you free and cheap resources that you can add to your reference bag of tricks and provide a look at how our legal system works. You will also learn how to evaluate a situation to determine if it is beyond the resources you have available and when and where to refer patrons for additional assistance.

Intended Audience: Multiple Library Types; Public Libraries

Track(s): General Interest; Reference Services

Thursday 9:00am-9:45am

Out of the Labs and Into the Libraries: How to Run a 3D Printing Program for the General Public.

Location: Athena J

Presenter(s): Theodore Mashburn, Dedra Roman

Contact: mashburn@cobbcat.org

3D printing technology, though relatively well known and available in some areas, remains out of reach and virtually unknown to the vast majority of Georgia's residents. In order to ensure that 3D printing is available to the public, the South Cobb Regional Library has offered 3D printing services to its patrons since February of 2016. During our presentation, we will share our insights to operating and maintaining

a public 3D printing program for patrons, and how we utilize this technology for our libraries.

Intended Audience: Public Libraries

Track(s): General Interest; Outreach/ Marketing/ Public Relations; Technology

Thursday 10:00am-11:45am

GLA Academic Library Division Paper Presentation & Panel Discussion on Scholarly Writing and Publishing

Location: Olympia 1

Presenter(s): Rebecca Rose, Sofia Slutskey, Camille McCutcheon, Virginia Feher, Cheryl Stiles

Contact: rebecca.rose@ung.edu

Sponsored by GLA Academic Library Division

This program is sponsored by the Academic Library Division of the GLA/ Georgia Chapter of ACRL. The first session features the top three entries selected through blind peer-review process from the 2016 submissions to this year's call for academic papers.

Utilizing Student Workers at the Digital Library of Georgia, by Mandy Mastrovita and Donnie Summerlin

A Mobile Solution to Information Literacy Assessment, by Karen Viars, Mary Ann Cullen and Amy Stalker

Defining ourselves: What makes a librarian professional?, by Andrea Stanfield

The second session is a panel discussion with librarians who are actively involved in scholarly writing and publishing. Panel members include Camille McCutcheon, a member of the Editorial Boards of The Southeastern Librarian, The Journal of Popular Culture, and The Journal of American Culture and Book Review, Editor for the Journal of American Culture; Virginia Feher, current editor of Georgia Library Quarterly; Cheryl Stiles, who is piloting one-year professional writing group for Kennesaw State University librarians. The panel will discuss ways to get published, writing software and tools, communicating with journal editors, and navigating the peer review process. This session is intended for all who have an interest in publishing.

Intended Audience: Multiple Library Types; Academic Libraries

Track(s): General Interest; Professional Development

Thursday 10:00am-11:45am

PINNACLE class of 2016 reports

Location: Parthenon 1

Presenter(s): 2016 PINNACLE Class

Contact: wcornelisen@georgialibraries.org

Sponsored by GLA Public Library Division

Best Practices in Marketing Your Library (We will present strategies that different libraries have used to spread the word about library services and discuss methods that can be used to measure the effectiveness of your marketing strategy.) Mentoring Magic: Creating Mentoring Relationships for Powerful Transformations (This presentation will provide strategies to alleviate hurdles and foster knowledge transfer and succession planning through mentoring.) What's Keeping Them From Our Libraries?: Identifying Barriers in Georgia's Public Libraries (Join us as we dissect survey results from around the state of library users and non-users, explore the barriers that potential public users face, and discuss what services matter most.) No strings attached: the good, the bad, and

the ugly of private funding (We'll be exploring the options libraries have building relationships with corporate and private funding agencies.)

Intended Audience: Multiple Library Types; Emerging Librarians/ MLIS Students

Track(s): General Interest; Outreach/ Marketing/ Public Relations

Thursday 10:00am-11:45am

Creating Curiosity: How Five Libraries Brought Creativity Educations to Their Tweens (and how you can too!)

Location: Parthenon 2

Presenter(s): John Mack Freeman, Carmen Thomason, Jennifer Rapier, Sheila Kypta, Ora Stuckey, Jessica Cheek, Rebecca Power

Contact: johnmackfreeman@gmail.com

Five Georgia libraries were recipients of the inaugural Curiosity Creates grant to bring creativity education to 6-14 year olds in public libraries.

From photography to art, from creativity clubs to library publishing houses, these libraries have unlocked their young people's creative potentials for the last six months in a special way. Join us at this special double session where you'll learn what they did, how they did it, and the lessons they learned along the way. In the second half of the session, the panel will break down their best practices and tell you how you can take these ideas home to your library without having to spend an arm and leg. With a focus on practical tips and adaptable programs, this program is recommended for all children's librarians or those who want to expand creativity programming in their libraries!

Intended Audience: Multiple Library Types; Public Libraries

Track(s): Children's Services; Elementary School; Young Adult or Youth Services; Middle or High School

Thursday 10:00am-10:45am

Showcasing Our Gems: Unique Treasures from Public Libraries

Location: Grand Hall 1

Presenter(s): Tamika Strong, Richelle Brown, Muriel Jackson

Contact: tstrong@georgialibraries.org

This program will provide an opportunity for several librarians from public libraries to showcase archival items found in their collections. This show and tell will be done primarily through a Powerpoint presentation with the possibility of some of the items being on display.

Intended Audience: Archives; Public Libraries

Track(s): General Interest; Reference Services; Special Collections; Archives

Thursday 10:00am-10:45am

Reinventing Your Spaces to Advance Library and Campus Initiatives

Location: Grand Hall 2

Presenter(s): Bob Fox, Gordon Baker

Contact: bob.fox@louisville.edu

Sponsored by SELA

While few of us will have the opportunity to open a new library, it's still possible to reinvent your existing spaces to move forward important library and campus initiatives. Hear from two library deans how they are continuing to re-purpose their spaces. You'll hear about campus

and project goals being turned into reality through these space transformations.

Intended Audience: Multiple Library Types; Academic Libraries

Track(s): Administration; Physical Space

Thursday 10:00am-10:45am

A Bird in the Hand: Leveraging ILL Requests to Improve Electronic Resource Access

Location: Grand Hall 4

Presenter(s): Jeffrey Mortimore, Jessica Garner, Jermaine Bryant, Jessica Williams

Contact: jmortimore@georgiasouthern.edu

Interlibrary Loan (ILL) requests reveal a lot about our collections, from development needs to access issues. This session focuses on how ILL and Technical Services personnel at Georgia Southern University are using ILL request information to troubleshoot and improve electronic resource access across our collections. We will explore the kinds of access issues ILL lending and borrowing requests reveal, discuss strategies for issue reporting and feedback, and consider the benefits of leveraging ILL requests to identify, mediate, and resolve access issues, sometimes before they ever crop up at the reference desk. Additionally, we look forward to hearing about what strategies other libraries are using to leverage ILL data to improve access troubleshooting.

Intended Audience: Multiple Library Types

Track(s): Administration; Assessment; Interlibrary Loan/ Document Delivery/ Resource Sharing; Technical Services/Cataloging/Acquisitions

Thursday 10:00am-10:45am

Consolidating Instruction Programs: How Did You Do That?

Location: Grand Hall 5

Presenter(s): Chris Sharpe, Kelly Ansley, Amanda Nash, Ben Mullis, Sarah Kirkley, Leslie Madden, Patricia Ziebart

Contact: csharpe@kennesaw.edu

This panel made up of members from four institutions will discuss the challenges, benefits, and ongoing issues related to instruction programs at consolidated universities. Panelists will describe how consolidation affected their program and what changes, if any, they made. The process of joining instruction programs will be reviewed, which includes talking about goals, guiding principles, and organizational structure. Finally, the panelists will share the lessons they learned through the experience and their recommendations for others who may undergo consolidation.

Intended Audience: Academic Libraries

Track(s): Administration; Instruction

Thursday 10:00am-10:45am

What Drives and Guides Us: The Importance of Developing a Personal Philosophy of Librarianship

Location: Athena A

Presenter(s): Brandy Horne

Contact: BrandyH@usca.edu

What is your philosophy of librarianship? To answer this question we must be thoughtful about our work, we must understand our role in the communities we serve, and we must identify what drives and guides us.

A clearly articulated philosophy helps focus our efforts, gives us a rubric by which to assess our effectiveness, and helps identify opportunities for growth and improvement. Unfortunately, when asked this question in an interview, many people struggle to answer. The answers are mostly generic--meeting people's information needs, providing excellent service, etc... While it's true that certain aspects of librarianship apply to all types of librarians, specific positions and/or specific communities require equally specific philosophies. In this session, we'll discuss the importance of having a philosophy of librarianship and how our philosophies guide our work. We will also look at resources that can help librarians begin to explore and articulate their specific philosophies.

Intended Audience: Multiple Library Types; Emerging Librarians/ MLIS Students

Track(s): General Interest; Career Advice

Thursday 10:00am-10:45am

Connecting with Your Campus through Collaborative Library Marketing

Location: Athena B

Presenter(s): Franklin Roberts, Kathryn Greer, Lydia Hofstetter

Contact: froberts@ggc.edu

Over the past two years, Georgia Gwinnett College has developed a cross-departmental working group we call the Library Marketing and Outreach Group (LMOG). The aim of this group has been to bring students into the library, to take the library into places where the students are, and to market the various services our library provides. This group has sought to collaborate with faculty, students, and various departments around campus to provide programming and marketing materials, in addition to still doing traditional library marketing like displays. For example, library staff have attended and presented complementary library materials at various campus speaker events, worked with the writing center and student organizations to present a student poetry event, and attended several campus promotional events to show the library's connection to the campus in addition to marketing library services. The presenters will provide information about some successful programs and events.

Intended Audience: Multiple Library Types; Academic Libraries

Track(s): General Interest; Outreach/ Marketing/ Public Relations

Thursday 10:00am-10:45am

Reinventing Library Services and Programs Using Tablets and iPads

Location: Athena C

Presenter(s): Roy Cummings

Contact: roy.cummings@claytoncountyga.gov

So you've decided to incorporate mobile devices such as tablets and iPads into your library's services... great! And now that you've bought them (or are getting ready to buy them), you realize you have almost no clue about what to do with them. Well, that's not so great. If this describes your situation, then this session is for you. Attendees will learn about the process the Clayton County Library System used to select, manage, and deploy mobile devices to enhance patron experiences. Attendees will also get practical advice and hear about the successes, challenges, and lessons learned so far. This presentation is ideal for librarians and library staff seeking insight into efficiently incorporating

mobile devices to their library services.

Intended Audience: Multiple Library Types

Track(s): General Interest; Instruction; Outreach/ Marketing/ Public Relations; Technology

Thursday 10:00am-10:45am

Removing Barriers to One-Shot Assessment

Location: Athena D

Presenter(s): Amy Fyn, Margaret Fain

Contact: afyn@coastal.edu

Developing effective assessments for one-shot sessions is feasible. Developing assessments that are non-intrusive and provide measurable data that informs teaching and assesses student learning is harder. In this session, learn how a team of librarians used low-barrier and low-cost technology tools, like Padlet and Google forms, to create assessment tools that are an integrated part of the instruction session. The session will cover tips on how to develop and incorporate these tools into a 50 minute instruction class. We will also cover techniques for developing assessment rubrics that rely on the strengths of assessment tools, resulting in data that can be used to improve both teaching and student learning.

Intended Audience: Academic Libraries

Track(s): Assessment; Instruction

Thursday 10:00am-10:45am

Sowing Seeds of Innovation: Interlibrary Collaboration to Build a Blossoming Seed Library

Location: Athena G

Presenter(s): Patricia Hartman, Rosanna McGuinness

Contact: pjh0011@auburn.edu

Seed libraries are popping up at public and academic libraries all over the country. In Lee County, Alabama, we were surprised to learn that two separate seed library efforts were under way, one at a university library and the other at a public library. Rather than manage two independent seed libraries in our relatively small community, we created a unified seed library. By leveraging the complementary strengths and weaknesses library types and by taking advantage of our unique partnerships, we were able to attract more users, more volunteers, and more input from expert researchers to provide a better overall service. In this presentation, we will describe the creation and evolution of our independent seed libraries, then focus on how we joined forces to create a resource that motivates us and our users to reimagine the role of libraries on campus and in the community.

Intended Audience: Multiple Library Types; Academic Libraries; Public Libraries; School Libraries; Support Staff

Track(s): General Interest; Administration; Outreach/ Marketing/ Public Relations; Physical Space

Thursday 10:00am-10:45am

Engaging Teens with Passive Programming

Location: Athena H

Presenter(s): Angelica Torres

Contact: torresa@bibblib.org

It can be a struggle to reach teenage patrons. The difficulty is in

attracting teenagers to the library and even more so to persuade them to attend library programs. For some teens, the library is a quick stop in their busy lives; they grab their books and leave. Others prefer to find a cozy chair and pass the time reading. Some teens use their library solely for Wi-Fi or computer access and do not seek any further services. Passive programming is an easy way for staff to engage teen patrons who might otherwise be reluctant to use the library to its fullest extent. Passive programming allows the library to involve teens on their terms. We will take a look at successful and unsuccessful attempts at getting teens involved with the Middle Georgia Regional Library system. Then we will try out a couple of programs to see what it is like.

Intended Audience: Public Libraries; School Libraries

Track(s): General Interest; Young Adult or Youth Services; Middle or High School

Thursday 10:00am-10:45am

They Do It Here: How Students Use Space in a Research Library

Location: Athena I

Presenter(s): Ashley Dees, Melissa Dennis

Contact: aesorey@olemiss.edu

This presentation showcases findings from a recent study of public spaces in the University of Mississippi's main library. After a 2015 survey revealed a number of space and overall facilities comments, librarians prepared a semester-long photographic study to capture which public spaces within the library were getting the heaviest use and how patrons were actually using those spaces. Research methods, survey data, and space usage are discussed as ways to use evidence to drive renovation projects.

Intended Audience: Multiple Library Types; Academic Libraries

Track(s): Assessment; Physical Space

Thursday 10:00am-10:45am

Homeschool: Highway to Harmony

Location: Athena J

Presenter(s): Crystal Gates

Contact: crystal.gates@lamanlibrary.org

Sponsored by SELA

Whether you agree or disagree, homeschooling is here to stay. Libraries are in a prime position to reach out to this diverse population. Specialized programming allows students to collaborate on group projects or discoveries. As libraries continue to expand their learning programs, we have the opportunity to provide access to materials and education not otherwise available to the average homeschooled student together with the route to success. Successful programs will be highlighted as examples of collaboration with various organizations to create interactive learning experiences and a list of recommended materials will be shared.

Intended Audience: Public Libraries; Support Staff

Track(s): General Interest; Instruction

Thursday 11:00am-11:45am

An Introvert and an Extrovert Walk Into a Classroom: How Personality Type Affects Teaching Styles

Location: Olympia 2

Presenter(s): Kelly Ansley, Laurie Aycock

Contact: kansley1@kennesaw.edu

This workshop aims to take a look at how introverted librarian and extroverted librarians approach instruction. Topics of discussion will include planning instruction sessions versus 'fly by the seat of your pants', and possible differences in how the introverted versus the extroverted librarians engage the students in the instruction session.

Intended Audience: Multiple Library Types; Academic Libraries; Emerging Librarians/ MLIS Students; Public Libraries; School Libraries; Special Libraries

Track(s): Instruction; Professional Development

Thursday 11:00am-11:45am

Re-integrating the Library and the Classroom through a "Faculty Fellows" Project

Location: Grand Hall 1

Presenter(s): Jeff Dowdy, Hasitha Mahabaduge, Nancy Davis-Bray

Contact: jeffrey.dowdy@gcsu.edu

The panel will discuss a faculty fellows project designed to team up a faculty member and a librarian charged with the redesign of a course to include key information literacy assignments that go beyond the traditional research paper. The panel will include a midterm report from a team that used the project to redesign a physics course on renewable energy.

Intended Audience: Academic Libraries

Track(s): Instruction; Outreach/ Marketing/ Public Relations; Reference Services

Thursday 11:00am-11:45am

More than Butts in the Seat! Outreach Programs enhance the Metaliteracy and Social Learning Concepts of the New Information Literacy Framework!

Location: Grand Hall 2

Presenter(s): Nikki Cannon-Rech

Contact: rechn@savannahstate.edu

Quality outreach enhances an information literacy program and supports the ACRL framework. Come ready to play and learn how programs support your mission, increase visibility of your services, and form collaborative partnerships across your campus! Explore types of assessment, and leave with a tentative plan for one outreach program!

Intended Audience: Multiple Library Types; Academic Libraries

Track(s): General Interest; Outreach/ Marketing/ Public Relations

Thursday 11:00am-11:45am

Forging Alliances: Leveraging Internal and External Partnerships

Location: Grand Hall 4

Presenter(s): Iyanna Sims, Tamika Barnes

Contact: iyanna@ncat.edu

Partnerships are a necessity for the continued growth of libraries. Strategic partnerships allow libraries to engage stakeholders and maximize library resources. One university and one community college library will speak on their experience of identifying and leveraging partnerships. The presentation will discuss steps taken to identify and develop strategic partnerships and beneficial outcomes.

Intended Audience: Academic Libraries

Track(s): Instruction; Outreach/ Marketing/ Public Relations

Thursday 11:00am-11:45am

Simple Springshare Mashups: Cross-Platform Strategies for Repurposing Digital Content for Multiple Audiences

Location: Grand Hall 5

Presenter(s): Ruth Baker, Jeffrey Mortimore

Contact: rbaker@georgiasouthern.edu

During this session, presenters will offer simple strategies for content creation and management that maximize opportunities for repurposing content across delivery platforms while keeping maintenance to a minimum. First, we will consider strategies for content creation-including naming, description, and chunking-that support repurposing of content for multiple audiences and support contexts. Second, we will look at strategies for dynamically mapping content across platforms that eliminates any need to monitor platform content separately. While this session will focus on LibGuides and LibAnswers, the content creation techniques we discuss are applicable to any content management system that supports dynamic content mapping and/or external widget creation.

Intended Audience: Academic Libraries; School Libraries

Track(s): Instruction; Outreach/ Marketing/ Public Relations; Technical Services/ Cataloging/Acquisitions

Thursday 11:00am-11:45am

Resume Review Workshop

Location: Athena A

Presenter(s): Ashley Hoffman, Steve Burton, Christina Holm

Contact: ahoffm18@kennesaw.edu

You don't have to be on the job market to fine-tune your resume!

Great resumes and CVs are not only good at getting you a job, but also applying for promotion, awards, speaking engagements, or publications. Join GLA's New Members Roundtable for a brief overview of resume and curriculum vitae writing for the library field, followed by a one-on-one resume review clinic. Make sure to bring your current resume or CV!

Intended Audience: Emerging Librarians/ MLIS Students

Track(s): Professional Development

Thursday 11:00am-11:45am

Developing & Managing Your School Library Volunteer Program

Location: Athena B

Presenter(s): Linda Johnson, Trish Vlastnik, Marneda Ivey

Contact: linda.n.johnson@clayton.k12.ga.us

This presentation will discuss specific practices for recruiting, training and maintaining a strong volunteer program in elementary, middle and high school libraries.

Intended Audience: Emerging Librarians/ MLIS Students; School Libraries; Support Staff

Track(s): General Interest; Administration; Children's Services; Elementary School; Young Adult or Youth Services; Middle or High School; Outreach/ Marketing/ Public Relations

Thursday 11:00am-11:45am

Libraries Meeting the Special Needs and Interests of Older Adults

Location: Athena C

Presenter(s): Jacqueline Johnson

Contact: johnsonj@mail.henry.public.lib.ga.us

This presentation is a sharing of information gleaned from Fairview Public Library's experience of opening a satellite branch at the Hidden Valley Senior Center, located in its community. The goal is to introduce the model which includes the steps used to make the initial connection which are: to outline our point of interest of enabling older adults to get or stay engaged in the digital world by offering programs that will allow them continue to be self-sufficient. To learn the ins and outs of operating a satellite branch onsite equipped with a comfortable inviting space that feels a part of the center that has always belonged to the participating members of the center. And, teaching courses that are pre-approved by the organization and are designed to meet the special needs and interests of the target audience that will not interfere with the services and classes already provided by the organization.

Intended Audience: Public Libraries

Track(s): Physical Space

Thursday 11:00am-11:45am

Rediscovering Student Success: Library Instruction and GPA

Location: Athena D

Presenter(s): Ula Gaha

Contact: ugaha@saintmarys.edu

Need an idea for your next research project? Learn about the positive relationship between library instruction and student GPA at Saint Mary's College, Notre Dame. Take away ideas for conducting a study on your own campus, and learn about coordinating research with Institutional Research and the Registrar's office.

Intended Audience: Academic Libraries; Emerging Librarians/ MLIS Students; School Libraries; Special Libraries; Support Staff

Track(s): Assessment; Instruction; Outreach/ Marketing/ Public Relations

Thursday 11:00am-11:45am

From One-shot Instruction to Co-Teaching

Location: Athena G

Presenter(s): Olga Koz

Contact: okoz@kennesaw.edu

Are you interested in working with teaching faculty to make a difference in the academic achievement of students? Would you like to move from one-shot instructions to co-designing and co-teaching courses? If so, this interactive session is for you! Co-teaching has been widely used to bring together K-12 teachers with unique skills and create opportunities for specialized or enhanced instruction. It has not been used extensively as an instructional strategy in higher education institutions or as a model for librarian-instructor collaboration. The presenter, an on-site librarian, a liaison for graduate programs at the College of Education, will take you on her personal journey from an occasional collaboration with instructors to co-teaching a course. The interactive session will include an overview of studies on co-teaching and other collaborative teaching

models; a case study of implementing an embedded librarian and co-teaching models, and discussion on barriers in successful faculty.

Intended Audience: Academic Libraries

Track(s): Instruction

Thursday 11:00am-11:45am

The Amazing Authors Club

Location: Athena H

Presenter(s): Karen Larrick, Debbie Holmes, Rose Jenkins, Ben Bryson

Contact: klarrick@glynncounty-ga.gov

Would you like to add a spark of excitement to your teen program next summer? Challenge your students to become published authors and give them the tools to accomplish the goal. With the help of mentors - professionals from the world of writing, illustration, and publishing - the Marshes of Glynn Libraries guided the Amazing Authors Club through this process during two camps, one in the summer of 2015 and one in 2016. The panelists, who include library staff and a mentor from each camp, will talk about the formula they used to host the two camps and create two books: the costs, the challenges, and the excitement of the biggest book signing party your library may ever have. The panelists will welcome questions from the audience at the close of the discussion.

Intended Audience: Public Libraries; School Libraries

Track(s): Children's Services; Elementary School; Young Adult or Youth Services; Middle or High School

Thursday 11:00am-11:45am

Primary and Educators' resources in the Digital Library of Georgia and Digital Public Library of America

Location: Athena I

Presenter(s): Karen Minton, Sheila McAlister

Contact: karen.minton@usg.edu

The Digital Library of Georgia (DLG) and Digital Public Library of America (DPLA) provide a wealth of primary resources for research and classroom use. The presentation will discuss locating resources within both sites. Additionally, the session will feature the online exhibits and series of curated primary resource sets available in the DPLA.

Intended Audience: Multiple Library Types

Track(s): General Interest; Young Adult or Youth Services; Middle or High School

Thursday 11:00am-11:45am

Historical Hunt: Finding Government Information for Historical Research

Location: Athena J

Presenter(s): Paula Webb

Contact: pwebb@southalabama.edu

Sponsored by the GLA Government Information Interest Group and SELA Government Documents Roundtable

The majority of government information has always intended to be free from copyright restrictions; lending themselves to be among the first items to be scanned and uploaded into online databases and collections. The positive aspect is this information is free and available to everyone. The negative aspect is this same information is in so many various free and fee-based databases that you have no idea where to begin searching

for what you need.

Paula Lenor Webb, Government Documents Reference and Outreach Librarian at the University of South Alabama, editor of Mobile Mayor's Court Reports: 1865, and upcoming History Press publication, Mobile Under Siege: Surviving the Union Blockade, will show you how she discovered government resources and how they helped her research.

Intended Audience: Multiple Library Types

Track(s): General Interest; Reference

Thursday 12:00pm-1:15pm

Luncheon and Keynote

Location: Oconee River Room

Presenter(s): Jonathan Alter

Jonathan Alter is an award-winning author, reporter, columnist and television producer and analyst. He is the author of three New York Times bestsellers: "The Center Holds: Obama and His Enemies" (2013), "The Promise: President Obama, Year One" (2010) and "The Defining Moment: FDR's Hundred Days and the Triumph of Hope" (2006), also one of the Times' "Notable Books" of the year. Since 1996, Alter has been an analyst and contributing correspondent for NBC News and MSNBC, appearing on-air two or three times a week. After 28 years as a columnist and senior editor at Newsweek, where he wrote more than 50 cover stories, Alter is now a twice-monthly columnist for the Daily Beast. He has also written for The New York Times, The Washington Post, The Washington Monthly, Rolling Stone, The Atlantic, The New Yorker, Vanity Fair, The New Republic, Esquire, Bloomberg View and other publications. He is an executive producer of "Alpha House," a half-hour political comedy created by Garry Trudeau and starring John Goodman that is available for viewing on Amazon.com. He is at work on a full-length biography of former President Jimmy Carter and is producing a documentary about the lives of legendary journalists Jimmy Breslin and Pete Hamill.

Thursday 1:30pm-2:15pm

Introducing the Friends of Georgia Libraries

Location: Olympia 1

Presenter(s): Keith Shuermann, Dan Aldridge, Kathy Ash

Contact: kshuermann@thrl.org

Board members of the statewide library friends group, the Friends of Georgia Libraries (FOGL), will discuss the work and mission of their organization. They will share FOGL's proven success in helping local friends groups work more effectively, grow their memberships, and prosper in a time when friends support is needed more than ever before for our libraries.

Intended Audience: Public Libraries

Track(s): General Interest

Thursday 1:30pm-2:15pm

Media Tech Toolbox: Research Success is Just a Click Away!

Location: Olympia 2

Presenter(s): Sandy Wise

Contact: Sandy_Wise@Gwinnett.k12.ga.us

Having trouble "selling" the research process? Discover how to

pump new life into your instruction with online, easy to use apps and technology tools. Streamline your lesson plans with interactive databases, Google add-ons, online resources and presentation programs to create a one-stop "media tech toolbox" that teachers and students alike will use. The presentation will feature instructional strategies and technology tools used to engage students in the research process. The benefits of using MackinVIA Groups, Google Drive, Symbaloo, Smore, Prezi, and other presentation tools will be discussed.

Intended Audience: Academic Libraries; School Libraries

Track(s): Young Adult or Youth Services; Middle or High School; Instruction Technology

Thursday 1:30pm-2:15pm

Different Roads to the Same Destination: Alma Implementation at 3 Diverse Institutions

Location: Parthenon 1

Presenter(s): Sean Boyle, Erin Grant, Jessie Copeland, Marlee Givens

Contact: sean.boyle@ung.edu

For the past year, the libraries of the University System of Georgia institutions and Emory University have been contending with the same major change - the migration from two Integrated Library Systems (Voyager and Aleph) to Ex Libris' Alma. Librarians from three different institutions - Georgia Tech, Emory, and University of North Georgia - will discuss the various decisions made at their institutions about data cleanup, configuration/implementation, training, and the outcomes of those decisions.

Intended Audience: Multiple Library Types; Academic Libraries

Track(s): General Interest; Technical Services/ Cataloging/ Acquisitions

Thursday 1:30pm-2:15pm

Get that Grant!

Location: Parthenon 2

Presenter(s): Mary Moore, Stephen Sherman, Diana Very

Contact: mwmoore@smyrnaga.gov

Have a great idea, but don't have the resources to implement? Explore ways to find funds through government grants, foundation grants, community gifts, and direct donations. Stephen Sherman, Atlanta Lead with the Foundation Center, will discuss resources for researching private funding, including the Center's grantmaker databases and learning opportunities for grantseekers. Diana Very has a Doctorate in Public Administration and is the Director of the Three Rivers Library System in Jesup, Georgia. She will discuss Grants.gov, the paperwork surrounding the federal grant process, the number of certification numbers that you need to send in an application, and the ability to make partnerships and sponsors for larger grants. Mary Wallace Moore is the Director of Smyrna Public Library, in Smyrna, Georgia. She will discuss tactics for writing grants, developing and maintaining relationships with funders, and how to present your ideas to administration if you are an entry level or mid-career librarian.

Intended Audience: Multiple Library Types; Academic Libraries;

Emerging Librarians/ MLIS Students; Public Libraries; Support Staff

Track(s): General Interest; Administration; Professional Development

Thursday 1:30pm-2:15pm

NSF Data Management Requirements 101

Location: Grand Hall 1

Presenter(s): Jeffrey Mortimore

Contact: jmortimore@georgiasouthern.edu

As federal funding requirements continue to evolve and more publishers are requiring open data sharing as a condition of publication, academic libraries have an important role to play supporting campus researchers' data management needs. During this session, we will explore in detail the National Science Foundation's current data management requirements, giving special attention to data planning as part of the NSF's grant application process. In so doing, we will discuss basic tools and levels of service for supporting campus researchers throughout the data life cycle.

Intended Audience: Academic Libraries

Track(s): Government Docs; Info Reference Services

Thursday 1:30pm-2:15pm

Are You Being Served?: Reevaluating Academic Library Policies for Diversity and Inclusion.

Location: Grand Hall 2

Presenter(s): Jenny Harris, Shaundra Walker, Jennifer Price, Ben Davis

Contact: shaundra.walker@gcsu.edu

Most academic libraries have policies in place to guide decision-making, but how often are those policies reviewed through the lens of inclusivity and transparency? In Summer 2016, the Diversity Leadership Team at Russell Library set out to restructure several policies to foster diversity and inclusion. Using ACRL's Diversity Standards as a guide, our goal was to develop policies that benefit our employees and users instead of creating barriers for access and discovery.

Intended Audience: Academic Libraries

Track(s): General Interest

Thursday 1:30pm-2:15pm

Libraries and Writers, A Symbiotic Relationship

Location: Grand Hall 4

Presenter(s): David Darracott

Contact: daviiddarracott@gmail.com

Sponsored by GLA Public Library Division

Most librarians are highly respectful of writers and think libraries should display a healthy range of new work. Few librarians; however, understand how essential libraries have become in introducing their patrons to the most current and varied works of writers today. In fact, upheaval in the world of publishing makes libraries more vital than ever in the book discovery process. Since publishers offer less selection every year through normal retail channels, librarians exercise a powerful role in connecting writers and readers. Without libraries, few working writers could ever reach their audience.

Intended Audience: Public Libraries

Track(s): General Interest

Thursday 1:30pm-2:15pm

Bring the Magic Back

Location: Grand Hall 5

Presenter(s): Ashley Snelgrove

Contact: asnelgrove@greenvillelibrary.org

Sponsored by SELA Public Library

Attention muggles! Does your library want to engage school age children, create buzz around programs, and give young patrons memories of your library that will last a lifetime? Consider bringing magic alive in your library by hosting Harry Potter themed programs. Learn how to plan, promote, and carry out programs that allow children to feel like they are part of the "wizarding world." Get ideas on how to customize your program to fit your patrons and library space, from a simple craft to a week-long camp. With the release of one illustrated book per year, Harry Potter and the Cursed Child play, and a new movie set to be released this winter, there will be no shortage of interest in the Potter series anytime soon.

Intended Audience: Public Libraries

Track(s): Children's Services; Elementary School; Young Adult or Youth Services; Middle or High School

Thursday 1:30pm-2:15pm

Design on a Dime: Library Displays and Merchandising on a Shoestring Budget

Location: Athena A

Presenter(s): Kate Chambers

Contact: klarson@thrl.org

You've got the materials your patrons want, but how to best show them off? In this session, we'll explore retail models to emulate or avoid in your library. We will also explore easy and affordable ways to re-imagine how you showcase your materials and how to merchandise your library in appealing ways. You'll leave with tips, tricks, ideas, and maybe even a prize!

Intended Audience: Multiple Library Types; Archives; Emerging Librarians/ MLIS Students

Track(s): General Interest; Outreach/ Marketing/ Public Relations

Thursday 1:30pm-2:15pm

What USC Upstate Alumni Say About Information Literacy in the Workplace

Location: Athena B

Presenter(s): Andrew Kearns

Contact: akearns@uscupstate.edu

Sponsored by SELA Library Instruction Round Table

Librarians have rightly focused their efforts on helping students acquire the information literacy skills needed to complete academic research while in college, but what comes after, especially for those students headed directly for the workplace rather than graduate school? This session examines the results of a survey of USC Upstate alumni conducted between May and September 2015 in which they were asked about their use of information literacy skills on the job, how they acquired those skills, and where they look for job-related information. What they said emphasizes the collaborative and situational nature of workplace research and many of their observations are consistent with the literature on workplace information literacy, providing a context that makes survey results more meaningful. The presenter will seek to engage session participants in a broader discussion based on issues raised by the survey.

Intended Audience: Academic Libraries; Emerging Librarians/ MLIS Students

Track(s): General Interest; Instruction

Thursday 1:30pm-2:15pm

Half-Sessions Location: Athena C

Career Transitions: Reinvent Yourself for the Job You Want!

Presenter(s): Stephanie Adams

Contact: sjadams@ntech.edu

Librarianship is often a second career for many people. Given certain constraints such as financial and family responsibilities, geography, and time, it's often difficult to "start over." Using her path from a corporate job in media to full-time library science grad student, followed by a transition from instruction/reference librarian to electronic resources librarian as an example, the presenter will offer tips and suggestions for successful career transitions. She will discuss identifying education and skills that are transferable as well as making the most of part-time jobs, internships, grad assistantships, and field experiences. The importance of networking, participation in professional organizations, and taking calculated risks will also be discussed. Reinvent yourself and find out how to get from where you are to where you want to be!

Intended Audience: Multiple Library Types; Emerging Librarians/ MLIS Students

Track(s): General Interest; Career Advice

Fantastic Student-Employees and Where to Find Them: Using Gamification and the World of Harry Potter to Engage Student Employees

Presenter(s): Amanda Roper, Kimberley Boyd

Contact: aaddison@brenau.edu

In the spring of 2016 the Research and Instruction Team ran a six-week pilot program simulating a House Cup Competition with our 22 student-employees. The goal of the game was to increase student-employment engagement, team spirit, and productivity and encourage our staff to notice exemplary work from the student-workers. The game was developed in response to poor work performance by student-employees and a tendency from staff to lean on punishing errant behavior rather than fostering a positive and productive relationship between student-employees and library staff. This presentation will cover the development, implementation, assessment and restructuring of the House Cup Competition.

Intended Audience: Academic Libraries; Support Staff

Track(s): Outreach/ Marketing/ Public Relations; Management

Thursday 1:30pm-2:15pm

Half-Sessions Location: Athena D

Reinventing a Small Library Space

Presenter(s): Virginia Feher

Contact: virginia.feher@ung.edu

Sponsored by GLA Library Facilities Interest Group

Often, small libraries offer similar or identical resources and services as their larger counterparts but with limited space and staffing. This presentation will focus on how small academic libraries can maximize use of space and also offer useful ways to improve on-site services to successfully meet student/faculty expectations. The presenter will share lessons learned from a recent remodel of a small commuter campus

library, providing creative ideas for updating furniture, public service areas, staff workspace, and technology, all while working within space and other limitations, such as budgets and staffing. Based on real-library-world experience, the presenter will demonstrate how to create a positive learning environment for library users that offers a variety of resources and services within a small physical space, while at the same time providing a pleasant and practical physical work environment for library staff.

Intended Audience: Multiple Library Types; Academic Libraries

Track(s): General Interest; Physical Space

The Good, the Bad, & Parts Unknown: One Library's Tale of Renovation Lessons Learned

Presenter(s): Alan Lebish

Contact: alebish@kennesaw.edu

This presentation will provide an overview of what went well, and not so well, in the course of a one year major renovation project at Kennesaw State University's Sturgis Library. A summary of the project's goals and outcomes will be discussed. The presentation will highlight the impact the renovation had on staff and patrons, the challenges of keeping the library open during construction, and lessons learned along the way.

Intended Audience: Multiple Library Types

Track(s): Physical Space

Thursday 1:30pm-2:15pm

Half-Sessions Location: Athena G

Public Library/High School Media Center Partnership - Book Club

Presenter(s): Dedra Roman, Jennifer Bone, Brian Ragsdale

Contact: romand@cobbcat.org

This session will provide the groundwork, explain the benefits and highlight the importance of establishing a professional partnership between the Public Library and the High School Media Center in your region.

Intended Audience: Public Libraries; School Libraries

Track(s): General Interest; Young Adult or Youth Services; Middle or High School; Outreach/ Marketing/ Public Relations

Use of Social Media to Build Online Communities in Academic Libraries in Georgia

Presenter(s): Beatrice Pavlick

Contact: bchuites@gmail.com

A power point presentation on the findings from a study I conducted on a subgroup of state university libraries grouped by the University System of Georgia and their use of social media for community building.

Intended Audience: Academic Libraries; Emerging Librarians/ MLIS Students

Track(s): Outreach/ Marketing/ Public Relations

Thursday 1:30pm-2:15pm

Re-imagining Library Relationships

Location: Athena H

Presenter(s): Benjamin Mullis

Contact: benjamin.mullis@mga.edu

This program will discuss the various communities which academic libraries serve: students, faculty, the university community, and the community in which it is embedded. The program will discuss the library's relationships with each and present strategies for strengthening the library's relationship with each and the benefits of doing that.

Intended Audience: Academic Libraries

Track(s): Instruction; Outreach/ Marketing/ Public Relations

Thursday 1:30pm-2:15pm

Half-Sessions Location: Athena I

The Bookless Library as Community Organizer

Presenter(s): Kathy Boudreau-Henry

Contact: kpatten@mtsu.edu

Presentation on development of Murfreesboro, TN new Community Technology Center--an initiative of the Linebaugh Public Library. Includes anticipated effects on use by non-library users in the community designated as the service area.

Intended Audience: Public Libraries

Track(s): Outreach/ Marketing/ Public Relations; Physical Space; Technology

Community Patron Access to Academic FDLP Libraries

Presenter(s): Emily Rogers, Brett Williams

Contact: ecrogers@valdosta.edu

Sponsored by GLA Government Information Interest Group

More than three-fourths of Federal Depository Library Program (FDLP) members today are housed within libraries at colleges and universities, yet traditionally many academic libraries have limited community patron access. How do academic FDLP members maintain both the requirement to offer public access to their depository collections and their missions to serve their primary constituents? The authors present the results of a survey of FDLP coordinators at southeastern academic FDLP libraries to show how these libraries meet community patrons' needs and what issues arise from extending public access to non-institutional affiliates.

Intended Audience: Multiple Library Types; Academic Libraries

Track(s): Administration; Government Docs/Info

Thursday 1:30pm-2:15pm

Re-imagining the Academic Library

Location: Athena J

Presenter(s): John Cruickshank

Contact: johnlc@uga.edu

A generation ago, the great iconoclast F.W. Lancaster warned us about the prospect of libraries devolving into electronic switching stations and the dumbing down of the reference librarian's skill set. Today in libraries we see virtual research hubs, data management centers, the ongoing disappearance of the reference desk and books, and the rebranding of the reference librarian to consultant. But how does a consultant help a patron when the consultant is the novice and the patron the expert? Has Lancaster's worst nightmare come true? This presentation will explore the latest developments in academic libraries and information technology and what it all means from the perspective of a librarian who ardently shared many of Lancaster's views. What can we say already in

THUR., OCTOBER 6 / FRIDAY, OCTOBER 7

response to Lancaster's criticisms, and what can we learn by revisiting and rediscovering the hard-won wisdom and knowledge of the past?

Intended Audience: Multiple Library Types; Academic Libraries;

Emerging Librarians/ MLIS Students; Special Libraries

Track(s): General Interest; Physical Space; Reference Services; Technology

Thursday 2:30pm-3:30pm

Break With The Vendors

Location: Grand Hall 7

Meet the COMO exhibitors and share a complimentary snack!

Thursday 2:30pm-3:30pm

Poster Session A

Location: rear of Grand Hall 7

Collaboration in Collections: Acquisitions and Interlibrary Loan Partner for a Demand-Driven Collection at the University of Tennessee at Chattanooga's Library, by Melanie Dunn

Faculty Use of Interlibrary Loan at Georgia Southern University, by Fred Smith
Use This! Supervisor Development Programs that Work, by Heather Sostrom
Engaging your Community with Instagram: A Snapshot of #ClubMitchell, by Sheeji Kathuria

Using Virtual Reality in the Information Literacy Classroom, by Derek Malone, Doris McDaniel

Thursday 3:45pm-5:00pm

All Conference Meeting and Keynote Speaker

Location: Athena E-F

Presenter(s): Eric Faden

Eric S. Faden is an Associate Professor of English and Film/Media Studies at Bucknell University (Lewisburg, PA). He studies early cinema and digital image technologies. His research has appeared in *Early Popular Visual Culture*, *Strategies*, *Convergence*, *The Journal of Film and Video* plus the anthologies *Arret Sur Image* and *The Routledge Companion to Remix Studies*. Professor Faden also creates film, video, and multimedia works that imagine how scholarly research might appear as visual media. These experimental films are distributed commercially by Third World Newsreel and The Media Education Foundation and also in the on-line journals *Vectors* (USC), *Mediascape* (UCLA), and *The Cine-Files* (Savannah School of Art and Design).

Thursday 5:00pm-6:00pm

Authors Appreciation Reception

Location: Atrium

Meet Georgia's current bestselling authors while enjoying hors d'oeuvres.

Thursday 6:00pm-7:00pm

All-Conference Awards Ceremony

Location: Atrium

The annual All-Conference Awards celebrate the best in our libraries this year! Join us as we recognize achievement from libraries and librarians from across the south.

Thursday 7:30pm-9:30pm

New Member Round Table and Interest Group Dinner (Dutch Treat)

Location: Rook and Pawn Board Game Café [294 W Washington St, Suite 300, Athens, GA]

Please join GLA's New Members Round Table and Interest Group Council for their annual get-together. This year's event will be an evening of board games, tasty snacks, and mingling. Appetizers and sodas will be provided by NMRT and Atlanta Emerging Librarians, with alcoholic beverages and additional food available for individual purchase.

Friday 7:30-9:00am

SELA Breakfast

Location: Olympia 2

Presenter(s): Gordon Baker

Contact: gordonbaker@clayton.edu

Friday 8:00am-11:00am

Coffee With The Vendors

Location: Grand Hall 7

Meet the COMO exhibitors and share a complimentary coffee!

Friday 8:00am-8:45am

First Meeting of the Local History & Genealogy Interest Group

Location: Olympia 1

Presenter(s): Angela Stanley, Muriel Jackson, Debra Fennell

Contact: astanley@athenslibrary.org

Friday 8:00am-8:45am

Research and Assessment Interest Group Meeting

Location: Parthenon 1

Presenter(s): Cristina Trotter

Contact: chtrotter@gmail.com

Friday 8:00am-8:45am

Government Information Interest Group Meeting

Location: Parthenon 2

Presenter(s): Emily Rogers

Contact: ecrogers@valdosta.edu

Friday 8:00am-8:45am

Interlibrary Loan Interest Group Meeting

Location: Grand Hall 1

Presenter(s): Janice Shipp, Susan Morris, Michelle Jones

Contact: jshipp@scad.edu

Friday 8:00am-8:45am

Technical Services Interest Group Meeting

Location: Grand Hall 2

Presenter(s): Jessica Lee, Elaine Hardy

Contact: jessicalee@valdosta.edu

Friday 8:00am-8:45am

Information Technology Interest Group Meeting

Location: Grand Hall 4

Presenter(s): John Stephens, Patricia Vlastnik

Contact: jstephens12@ggc.edu

Friday 8:00am-8:45am

Intellectual Freedom Interest Group Meeting

Location: Grand Hall 5

Presenter(s): John Mack Freeman

Contact: johnmackfreeman@gmail.com

Friday 8:00am-8:45am

PACE (Professional and Continuing Education) Interest Group Meeting

Location: Athena A

Presenter(s): Julia Huprich

Contact: jhuprich@georgialibraries.org

Friday 8:00am-8:45am

Distance Learning Interest Group meeting

Location: Athena B

Presenter(s): Michael Wilson

Contact: mwwilson@valdosta.edu

Friday 8:00am-8:45am

Reference and Instructional Services Interest Group Meeting

Location: Athena C

Presenter(s): Oscar Gittemeier

Contact: oscar.gittemeier@fultoncountygva.gov

Friday 8:00am-8:45am

Library Services for Patrons with Disabilities Interest Group Meeting

Location: Athena D

Presenter(s): Stephanie Irvin

Contact: sirvin@georgialibraries.org

Friday 8:00am-8:45am

Technical College Interest Group Meeting

Location: Athena G

Presenter(s): Wendy Wilmoth

Contact: wilmothw@gptc.edu

Friday 8:00am-8:45am

Facilities Interest Group Meeting

Location: Athena H

Presenter(s): Alan Lebish

Contact: alebish@kennesaw.edu

Friday 8:00am-8:45am

Collection Development Interest Group Meeting

Location: Athena I

Presenter(s): Benjamin Barton

Contact: bbarton@brenau.edu

Friday 9:00am-9:45am

2016-2017 Georgia Student Media Festival Update

Location: Olympia 1

Presenter(s): Gordon Baker, Michelle Lenderman

Contact: gordonbaker@clayton.edu

Sponsored by GAIT

The Georgia Student Media Festival has been a showcase for the works of Georgia students for over 40 years! This session will present any changes in guidelines and will introduce new participants to the "how-to's" for holding a local and system festival.

Intended Audience: Public Libraries; School Libraries

Track(s): Children's Services; Elementary School; Young Adult or Youth Services; Middle or High School; Technology

Friday 9:00am-9:45am

TROLLS! In the Dungeon!! (aka Teens in the Library)

Location: Olympia 2

Presenter(s): Devera Chandler

Contact: dchandler@prlib.org

So you have TROLLS (err...TEENS in your library). Now what? First—don't look them in the eye, they'll run out the door! Just kidding! Beginning with passive programming ideas (cheap!) to full-fledged community service volunteer programs, this discussion is perfect for those looking to get teens into the library and more importantly, keep them coming back.

Intended Audience: Public Libraries; School Libraries

Track(s): General Interest; Outreach/ Marketing/ Public Relations

Friday 9:00am-9:45am

Invigorate Your Library's Learning Culture: Tips and Free Tools

Location: Parthenon 1

Presenter(s): Julie Huprich

Contact: jhuprich@georgialibraries.org

During this session, attendees will learn how to re-imagine, reinvent, and rediscover their library's learning culture using fresh new (free!) tools and energizing instructional techniques. Appropriate for staff at all levels in all types of libraries.

Intended Audience: Multiple Library Types

Track(s): Professional Development

Friday 9:00am-9:45am

Half-Sessions Location: Parthenon 2

Chinese Students in KSU Libraries: Their Information Seeking Behavior

Presenter(s): Ying Chen, Li Chen, Yongli Ma

Contact: xchen8@kennesaw.edu

With the globalization in education, there has been an influx of Chinese students studying in the United States. The needs and challenges of understanding their backgrounds and resource-seeking patterns are becoming more present and urgent as we strive to serve this user group more effectively to enhance their academic success. To address the growing needs and challenges, a survey is designed to collect data about their ways of seeking information and resources. The study surveys 42 Chinese students and scholars in Kennesaw State University. The data collected will be analyzed to identify the characteristics of this user group and its information seeking behaviors. The ultimate goal is to use the research findings to develop and implement plans and practices to further enhance library services and resources for this particular group and for all University students.

Intended Audience: Multiple Library Types; Academic Libraries; Emerging Librarians/ MLIS Students; Public Libraries; Support Staff
Track(s): General Interest; Assessment; Instruction; Outreach/ Marketing/ Public Relations; Reference Services

Academic librarian outreach to special populations on campus what works what doesn't

Presenter(s): Anne Hudson
Contact: anne.hudson@usm.edu

Most if not all academic libraries require their public services librarians to participate in outreach activities but how do you decide what groups to focus on, how best to serve them, what activities to plan, and, how you can assess the value of your outreach activities? Come to this session to listen to the funny, sad, and interesting experiences of an academic outreach librarian and bring your own stories to share!

Intended Audience: Academic Libraries; Emerging Librarians/ MLIS Students

Track(s): Instruction; Outreach/ Marketing/ Public Relations

Friday 9:00am-9:45am

GLASS Update - New Tools, New Tips

Location: Grand Hall 1
Presenter(s): Stephanie Irvin
Contact: sirvin@georgialibraries.org

Georgia Libraries for Accessible Statewide Services (GLASS) is the talking book and braille library for readers of any age who cannot use standard print materials due to a disability. The program in Georgia has undergone changes in the past year: The national program has enhanced services, and Georgia Public Library Services (GPLS) has provided accessible technology to public libraries in Georgia. GLASS is here to update you on this valuable service, and to provide you with resources to share with your coworkers, customers or students.

Intended Audience: Multiple Library Types

Track(s): General Interest

Friday 9:00am-9:45am

Reimagine Resource Sharing with the New STAR Checklist

Location: Grand Hall 2
Presenter(s): Margaret Ellingson, Marie Hansen, Kathy Britt-Rogers
Contact: margaret.ellingson@emory.edu

A presentation and discussion about the Rethinking Resource Sharing

(RRS) Initiative's Manifesto and STAR Checklist, Version 2, which provide library staff with a framework in which to review, reflect on, and reimagine their resource sharing/interlibrary loan policies, procedures and services. Participants from libraries of all types and sizes will learn how they can use the RSS Manifesto and recently revised STAR Checklist to to inform conversations about ways to provide resource sharing services to meet the changing needs and expectations of library users.

Intended Audience: Multiple Library Types

Track(s): Administration; Interlibrary Loan/ Document Delivery/ Resource Sharing

Friday 9:00am-9:45am

Update on the Georgia State Copyright Lawsuit

Location: Grand Hall 4

Presenter(s): Laura Burtle

Contact: lburtle@gsu.edu

Update on the ongoing Georgia State University copyright lawsuit, and its implications for the use of copyrighted materials in instruction.

Intended Audience: Academic Libraries' Emerging Librarians/ MLIS Students

Track(s): Circulation; Professional Development; Reference Services; Technology

Friday 9:00am-9:45am

The Changing Typology of Library Buildings in an Information-Overload Environment

Location: Grand Hall 5

Presenter(s): Edward McCormack

Contact: Edward.mccormack@usm.edu

The 21st. century library is becoming less of a place and more of an experience. Presentation will include a discussion, with imageries, of the key changes in library building type; library design and service trends; and challenges for library planners. Libraries across the world are re-inventing themselves in ways unimaginable by increasingly becoming adaptive to the digital environment of today's learning, research, information, communication skills, etc.

Intended Audience: Multiple Library Types; Academic Libraries

Track(s): Administration; Physical Space

Friday 9:00am-9:45am

Demonstrating the Library's Value for University Students' RPG

Location: Athena A

Presenter(s): Dr. David Evans, Dr. Linda Golian-Lui

Kennesaw State University Library System has combined library EZProxy usage data with student demographic and GPA data, by College, School, and Department by semester. This is replicating part of a project initiated by the University of Wollongong in Australia. This data validates our belief that use of the library's resources can positively impact students' academic performance and the institution's Retention, Progression, and Graduation (RPG).

Intended Audience: Academic Libraries

Track(s): Administration; Assessment

Friday 9:00am-9:45am

Rediscover Your Institution's History: Using an Institutional Repository to Highlight Special Collections Materials

Location Athena B

Presenter(s): Autumn Johnson, Sarah Kirkley, Ann Ogden

Contact: johnsona@savannahstate.edu

The launch of Savannah State's Institutional Repository, Tiger Scholar Commons, coincided with the university's 125th anniversary. When launching this repository, librarians Autumn Johnson, Sarah Kirkley, and library assistant Ann Ogden, used the opportunity to highlight some of the university's Special Collections materials, such as photographs, yearbooks, newspapers, and faculty publications. These collections showcased the institution's unique history as the first public historically black college in Georgia and were used in publications, social media campaigns, and even undergraduate work. This exceptional response during the quasiquicentennial celebration led to renewed interest in Special Collections and established the repository as a valuable resource for the university.

Intended Audience: Academic Libraries; Archives

Track(s): Outreach/ Marketing/ Public Relations Special Collections/ Archives

Friday 9:00am-9:45am

Using Creative Commons Licenses

Location: Athena C

Presenter(s): Denise Dimsdale

Contact: mdimsdale@gsu.edu

In this session, we'll talk about how creative commons licenses are designed to provide options for sharing your original content and other openly licensed content that you may want to remix. Although creative commons licenses are meant to be simple to use, remixing content with various licenses can be a bit tricky. We'll use an online tool to help us determine which licenses are compatible. We'll also discuss whether the format of your content will influence your license choice. Lastly, we'll briefly discuss some court cases involving creative commons licenses that just might surprise you.

Intended Audience: Multiple Library Types; Academic Libraries

Track(s): General Interest; Instruction

Friday 9:00am-9:45am

Summer Reading-Going Beyond the Books

Location: Athena D

Presenter(s): Lindy Moore

Contact: lindy@wgrl.net

Summer Reading-Beyond the Books How one library system shook things up. For years, the public library summer reading program has pushed books books books. Schools have distributed required reading lists. Same lists, same books, same kids=boring! The Douglas County Public Libraries, in partnership with the Douglas County Board of Education decided to shake things up. Our Summer Literacy Challenge pushes students to read more than just books. From early literacy through high school students, the Douglas County Literacy Challenge provides students with hundreds of ways to get beyond the same old lists and get actively involved with

their reading across the curriculum. Read in a tree or read to friend.

Write a blog about a book or draw words with shaving cream. Find a recipe, shop for the supplies and cook. The possibilities are endless! Your summer reading program will never be the same.

Intended Audience: Public Libraries; School Libraries

Track(s): Children's Services; Elementary School; Young Adult or Youth Services; Middle or High School; Outreach/ Marketing/ Public Relations

Friday 9:00am-9:45am

Rediscover GALILEO: An Amazing Reference Resource

Location: Athena G

Presenter(s): Dianne Dees

Contact: ecdees@valdosta.edu

Rediscover GALILEO: An Amazing Reference Resource. Come rediscover the best kept secret in reference resources available to Georgia educators. Find out how you can use the resources in GALILEO to support, supplement, and enhance your library or classroom instruction.

Intended Audience: School Libraries

Track(s): Instruction; Reference Services

Friday 9:00am-9:45am

Look What's New at the DPLA!!!

Location: Athena H

Presenter(s): Trish Vlastnik

Contact: patricia.vlastnik@clayton.k12.ga.us

What's new at the Digital Public Library of America! A lot! School librarians and institutions that serve children-see over 100 Primary Source Sets for instructional use and hear more about the Open eBooks initiative, offering thousands of free eBooks to students! Representatives of cultural heritage institutions-learn more about RightStatements.org and their ability to help you convey the copyright and re-use status of your digitized objects.

Intended Audience: Multiple Library Types; Academic Libraries; Archives; Emerging Librarians/ MLIS Students; Public Libraries; School Libraries; Special Libraries

Track(s): General Interest; Children's Services; Elementary School; Young Adult or Youth Services; Middle or High School; Instruction; Copyright

Friday 9:00am-9:45am

Revitalizing Your Library's Health Information Services: An Overview of National Library of Medicine Consumer Health Resources

Location: Athena I

Presenter(s): Carolann Curry, Anna Krampfl

Contact: curry_cl@mercer.edu

Join medical librarians in a session highlighting consumer health and wellness resources for all patron types including: children & teens, seniors, LGBT, veterans, and Spanish-speaking populations. Presenters will provide an overview and live demo of several online consumer health websites including: MedlinePlus, NIHSeniorHealth, KidsHealth.org, and Drug Information Portal. Best practices for consumer health users in public libraries and a discussion of health literacy will also be provided.

Printed lists of resources and factsheets will be available for attendees to

reproduce, edit, and customize as needed for their libraries.

Intended Audience: Multiple Library Types; Public Libraries; School Libraries; Special Libraries; Support Staff

Track(s): Reference Services

Friday 9:00am-9:45am

Creating an Amazing Bookmobile on a Shoestring Budget

Location: Athena J

Presenter(s): Jacob Starks

Contact: jstarks@neshoba.lib.ms.us

This is a presentation of the Neshoba Library's Bookmobile project process, including conception, design, fundraising and execution and first year performance results. The program will provide attendees with templates for proposals and fundraising materials as well as ideas for service and public outreach.

Intended Audience: Emerging Librarians/ MLIS Students; Public Libraries; Special Libraries

Track(s): Circulation; Outreach/ Marketing/ Public Relations

Friday 10:00am-11:00am

Coffee With The Vendors

Location: Grand Hall 7

Meet the COMO exhibitors and share a complimentary coffee!

Friday 10:00am-11:00am

Poster Session B

Location: rear of Grand Hall 7

GIS Services in the Library, by Meagan Duever

You have tutorials? -- Assessing for Discoverability, by Jennifer Putnam Davis
Say YES, to a Fresh Environment for Your Library: Reinventing the Old to Be New Again!, by Jeff Simpson, Chris Shaffer, Rachel Hooper

Chavez Ravine: A rediscovery of our local history, by Veronica D-Aquino, Thomas Philo

Transformative Spaces: Art in the Library, by Alan Lebish, Rebecca Freeman
A Research Database as a Textbook Alternative: Comparing Student Outcomes in Freshman Science Classes, by Mary Ann Cullen

Friday 11:00am-11:45am

Half-Sessions Location: Olympia 1

Digitize Your To-Do List: A Librarian's Introduction to KanbanFlow

Presenter(s): Rachel Evans

Contact: rsevens@uga.edu

Most librarians and library staff are constantly multi-tasking. Despite the type of library, our tasks are endless and range from cataloging to working the reference desk and everything in between. Kanban Flow is an online project management tool that allows for categorizing your tasks and visualizing your priorities and accomplishments. It also supports real-time collaboration between team members and time-tracking of tasks. This session will demo Kanban Flow and give real-life examples of how it can be used in a library setting to keep track of your work flow and boost employee productivity.

Intended Audience: Multiple Library Types; Emerging Librarians/ MLIS Students; Support Staff

Track(s): General Interest; Professional Development; Technology

Managing Your Library Projects by Using Trello

Presenter(s): Li Chen, Xueying Chen, Yongli Ma

Contact: lchen12@kennesaw.edu

The growth of projects in libraries is so pervasive that the roles of librarian have changed towards project management. How to keep track overwhelmed projects and complete them on time? In this presentation, we will talk about how Trello (a project management tool) was utilized by Kennesaw State University librarians to manage their library instruction, liaison, research and new technologies implementation projects. With Trello, librarians could organize different projects in one place and visualize the projects, communicate with other team members, keep track and document the progress and they will be more efficient and effective managing their projects.

Intended Audience: Multiple Library Types

Track(s): General Interest, Technology

Friday 11:00am-11:45am

Peachy Keen - The Georgia Peach Book Award for Teen Readers

Location: Olympia 2

Presenter(s): Devera Chandler

Contact: dchandler@prlib.org

Current Georgia Peach Book Award for Teen Readers committee members will present on the 2016-2017 nomination titles for the award and discuss creative ways to promote these titles in any library. In addition, all in attendance will have an opportunity to win books!

Intended Audience: Public Libraries; School Libraries

Track(s): General Interest; Outreach/ Marketing/ Public Relations

Friday 11:00am-11:45am

Speed Mentoring: a new level of networking

Location: Parthenon 1

Presenter(s): Julie Walker, David Singleton

Contact: jwalker@georgialibraries.org

Julie Walker & David Singleton describe the combination of speed dating and business networking that allows experienced library professionals to share their knowledge and advice with new colleagues. We'll do a few lightning rounds to demonstrate this useful and fun exercise.

Intended Audience: Multiple Library Types; Emerging Librarians/ MLIS Students

Track(s): Career Advice; Professional Development

Friday 11:00am-11:45am

Getting the Word Out: Library Options for Captioning and CART

Location: Parthenon 2

Presenter(s): Patricia Herndon

Contact: pherndon@georgialibraries.org

Libraries are to provide inclusive services to its customers. This will include services to persons with hearing impairment or visual impairment. What options are out there to affordably provide this option?

Intended Audience: Multiple Library Types

Track(s): General Interest; Technology

Friday 11:00am-11:45am

Home Scholars: Integrating Home School Programs Into Your Library

Location: Grand Hall 1

Presenter(s): Tracy Ralston

Contact: ralstont@mail.henry.public.lib.ga.us

With the number of families leaning towards home learning for their children, it has brought more people into the library. I want to share the ideas I have used through programming, social media and outreach to turn home schooling families into home scholar families.

Intended Audience: Public Libraries

Track(s): Circulation; Children's Services; Elementary School

Friday 11:00am-11:45am

You Are Not Alone: A Forum for Librarians Grappling with Electronic Resources Issues

Location: Grand Hall 2

Presenter(s): Camille McCutcheon

Contact: CMCCUTCHEON@uscupstate.edu

Sponsored by SELA Electronic Resources Round Table

"My faculty members refuse to use eBooks. How can I get them to switch?"; "My e-journal disappeared from the (blank) platform, now what?"; "Why is this site asking me for a password?" etc. Do you ever feel as if the proverbial wolves are at your door? Do you ever wonder how your colleagues in other libraries address electronic resources issues like these? This forum is an opportunity for librarians who work with electronic resources to network with their colleagues from libraries around the Southeast, to focus on issues, to brainstorm, and to discuss possible solutions for those unique issues we encounter when dealing with electronic resources.

Intended Audience: Multiple Library Types; Emerging Librarians/ MLIS Students

Track(s): Collection Development; Technical Services/ Cataloging/ Acquisitions

Friday 11:00am-11:45am

Communicating Effectively During an LMS Migration: Hitting the Sweet Spot

Location: Grand Hall 4

Presenter(s): Heather Jeffcoat, Marlee Givens

Contact: heather.jeffcoat@library.gatech.edu

In the ever-changing library landscape effective communication is paramount, especially during a significant change like introducing a new library management system (LMS). During Georgia Tech's rapid implementation of a NextGen library system, our communications team had to quickly develop a strategy for internal and external communications. Focusing on the essential messages for both staff and users enabled us to hit the sweet spot between too much communication and too little. We will discuss best practices, challenges, successes and lessons learned as we underwent our recent LMS migration.

Intended Audience: Multiple Library Types; Academic Libraries

Track(s): General Interest; Outreach/ Marketing/ Public Relations

Friday 11:00am-11:45am

(Re)Discovering Genealogy in GALILEO

Location: Grand Hall 5

Presenter(s): Tamika Strong

Contact: tstrong@georgialibraries.org

Using Powerpoint with Screenshots and some live searching (as allowed by the internet connection), this presentation will provide attendees with a look at databases in GALILEO that can provide their users with information to help them research their family history. The presentation will also include searching tips to discover materials in the databases, including Ancestry Library Edition, HeritageQuest, ArchiveGrid, and the eBooks collections.

Intended Audience: Multiple Library Types; Archives

Track(s): General Interest; Reference Services; Special Collections; Archives

Friday 11:00am-11:45am

Connecting Concept Maps to Library Research

Location: Athena A

Presenter(s): Paul Luft

Contact: luft_paul@columbusstate.edu

Connecting Concept Maps to Library Research is reinventing an old, but familiar, idea involving concept maps (a.k.a. mind maps) with a twist - connecting the concept maps to library resources. Excerpts of this conference presentation were previously presented in a workshop for first-year-experience-student (FYES) instructors at Columbus State University. In this workshop, instructors were shown how to develop a teaching scaffold to aid students with developing research topics, search strategies, and links to library resources. Additionally, these instructors were able to learn how concept maps engage first-year-experience students in critical thinking, organization, outlining skills, and more. In this presentation, attendees will learn how to create their own scaffold piece on a free concept mapping app. While not necessary, attendees are more than welcome to bring their own personal devices for this activity, or they may simply follow along as we create a concept map.

Intended Audience: Academic Libraries; Emerging Librarians/ MLIS Students

Track(s): Instruction; Technology

Friday 11:00am-11:45am

Surveying the State of Library Assessment

Location: Athena B

Presenter(s): Emily Thornton, Cristina Trotter, Michael Holt, Louise Lowe

Contact: emily.thornton@ung.edu

"What is being assessed in libraries today? What tools and methods are being used? What should be assessed but is not? Why?" A national survey in Spring 2016 explored these pressing questions while investigating the current practice of assessment in libraries today. In this session, the researchers will present the survey results and discuss implications of the data. The discussion will not only consider current practice, but more importantly ask how the profession can help advance the practice of assessment. Where are the skill gaps? What data is needed, but seemingly inaccessible? Participants will be asked to consider these and other obstacles, and they will be encouraged to help identify ways to overcome them.

Intended Audience: Multiple Library Types

Track(s): Assessment

Friday 11:00am-11:45am

Spelunking the Internet: What Every Librarian Should Know About The Dark Web

Location: Athena C

Presenter(s): David Bunnell

Contact: dpbunnell@live.com

We have all heard about the Dark Web and what may be down below the surface. In this presentation we will take a trip down into the depths to show you what you need to know about the darkest part of the Internet using the tools of anonymity-the Tor Browser and the Onion Network.

Intended Audience: Multiple Library Types

Track(s): Professional Development; Reference Services; Technology

Friday 11:00am-11:45am

Demonstrating Your Professional Value

Location: Athena D

Presenter(s): Louise Lowe, Arlene Desselles

Contact: lowe_ll@mercer.edu

In a data-driven environment, librarians must define, improve, and track professional value through integrated assessment and documented successes.

Intended Audience: Multiple Library Types

Track(s): Career Advice; Outreach/ Marketing/ Public Relations

Friday 11:00am-11:45am

Lit-T3: Literature and Information Literacy through Technology, Teamwork, and Teaching

Location: Athena G

Presenter(s): Dianne Dees

Contact: ecdees@valdosta.edu

Lit-T3: Literature & Information Literacy through Technology, Teamwork, and Teaching The school library has changed dramatically over the last 10-15 years. No longer is it just a book repository and story time center. Technology integration, teamwork with other educators and teaching to promote information literacy as well as literature form part of the foundation for school library programs. Hear about some tools and resources you can use and also have an opportunity to share with others the resources you are using in your library or classroom.

Intended Audience: School Libraries

Track(s): General Interest; Instruction

Friday 11:00am-11:45am

STEM Programming @ Your Library: A How-to Approach

Location: Athena H

Presenter(s): Angiah Davis

Contact: angiah.davis@fultoncountygga.gov

Science, Technology, Engineering, and Math (STEM) are critical subject areas for today's economy. In fact, many studies show a projected increase in STEM jobs in the near future. How will students be prepared for these jobs if they are not exposed to and engaged in quality STEM programs?

Libraries have the opportunity to help solve this problem by providing youth with STEM educational activities inside and outside of school. In this presentation, participants will learn about low-cost STEM initiatives and how to develop and implement similar programming in their libraries.

Intended Audience: Multiple Library Types; Public Libraries

Track(s): General Interest; Young Adult or Youth Services; Middle or High School

Friday 11:00am-11:45am

Half-Sessions Location: Athena I

Self-Publishing and Collection Development in Public Libraries

Presenter(s): Vicki L. Gregory

Contact: gregory@usf.edu

Librarians in the past put self-publishing only in the vanity press category expecting bad poetry, memoirs, local history, etc. In today's digital world, there are many opportunities for librarians to encourage good self-publishing which can add valuable resources to their library collections. Software designed for digital self-publishing also allows the sharing of materials (with the author's permission) among libraries in a state, or even nationally and can lead to more materials being available for little cost to the library. Interest in open access has lead many excellent authors to venture into self-publishing so that their materials are not bound by the rules of a particular publisher as they want their materials available to and used by the public. Self-publishing allows an author to skip the middle man (a publisher) who generally takes the lion's share of the profit. Libraries participating in a self-publishing venture can gain much without a large investment.

Intended Audience: Archives; Public Libraries

Track(s): Collection Development; Technology

uCOLE! Ukulele Lending at Jacksonville State University's Houston Cole Library

Presenter(s): Kim Stevens, Carley Knight

Contact: weather@jsu.edu

Librarians Kim Stevens and Carley Knight will talk about initiating the new ukulele lending program at Jacksonville State University's Houston Cole Library.

Intended Audience: Academic Libraries; Emerging Librarians/ MLIS Students

Track(s): Circulation; Professional Development; Reference Services; Technology

Friday 12:00pm-1:30pm

Scholarship Raffle

Location: Atrium

Presenter(s): John Mack Freeman

Contact: johnmackfreeman@gmail.com

What a way to end a great conference! Come to the Scholarship Raffle to see if you or a friend of yours is a lucky winner. Some items are specifically designated without the requirement that participants must be present to win. For all the other items the presence of the winner during the program is required. For more information, check with one of the Raffle volunteers.

2016 EXHIBITORS

34 - A to Z Databases

Jordan LaBorde

877-428-0101

jordan@atozdatabases.com

<http://www.atozdatabases.com>

AtoZdatabases.com is the leading provider of premier reference and marketing databases to libraries across the US. We also offer free job search, background/criminal search, people search, business profiles and mailing list for your patrons. Free 30 day trial. No Cost. No Risk. No contracts to sign.

77 - ABC-CLIO

Kathryn Suarez, Lauren Thomas

805-968-1191

<http://www.abc-clio.com>

<http://www.facebook.com/ABCCLIO>

http://www.twitter.com/ABC_CLIO

Make a difference in learning achievement with tools for your students and for you. ABC-CLIO's 15 award-winning databases support social studies research and curriculum and our 22,000+ reference books provide resources from history's most trusted publisher. Libraries Unlimited and School Library Connection offer authoritative treatment of topics that matter most to your practice and cutting-edge professional development tools

73 - American Library Association (ALA)

81 - Baker and Taylor

Jill Blades, Michael Wilder, Scott Coning

704-998-3100

btinfo@btol.com

<http://www.btol.com>

Baker & Taylor, a Follett company, is the premier worldwide distributor of digital and print books and entertainment products. We love books and leverage our unsurpassed distribution network to deliver rich content in multiple formats, anytime and anywhere, to readers worldwide. Baker & Taylor offers cutting-edge digital media services and innovative technology platforms to thousands of publishers, libraries and retailers globally.

29 - Better World Books

Ben Walsh, La'Kita Anderson

888-510-7103

library@betterworldbooks.com

<http://www.betterworldbooks.com>

<http://www.facebook.com/betterworldbooks>

<http://www.twitter.com/BWBooks>

Better World Books is a certified B corporation social venture organization that collects new and used books and sells them on over 50 online marketplaces to fund libraries, literacy, and education. Our Library Discards and Donations Program offers a no-cost solution for your Library's surplus books.

76 - Brodart

Donna Massie

800-233-8467

donna.massie@brodart.com

<http://www.brodart.com>

Since 1939 Brodart has been perfecting the product and service mix to provide solutions for the ever-changing needs of libraries and educational institutions. From our Book Jacket Cover grew a robust and multifaceted business with product and service offerings in the area of books, supplies, and furniture making Brodart a single destination library's needs. We share your commitment to your community and pride ourselves on offering outstanding personalized services and support.

44 and 49 - Burrow Library Services

Martha Stockton, David Burrow

205-305-1511

david4books@aol.com

<http://www.duraboundbooks.com>

Digital and print books.

48 - Children's Plus, Inc.

Jack Rosenberg

770-315-4336

jackr@childrensplusinc.com

<http://www.childrensplusinc.com>

Children's Plus, Inc., offers nearly 300,000 titles in our K-12 children and young adult collection. We specialize in custom built lists, 100% guaranteed prebinds and service.

37 - Discovery Toys

Junith Koon

678-777-8697

junith@mindspring.com

<http://www.junithstoys.com>

Top quality, unconditionally guaranteed, educational toys, books, and games for children of all ages.

70 - EBSCO Information Services

David Putz, Lori McGill, Tim Turner

800-653-2726

information@ebSCO.com

<http://www.EBSCO.com>

<http://www.facebook.com/EBSCOInfoServices>

<http://www.twitter.com/EBSCO>

EBSCO offers premium content through databases, journals & magazines, e-books, and more, including subscription management for more than 360,000 serials, including more than 57,000 e-journals, and online access to 800,000+ e-books. EBSCO provides a versatile discovery tool for searching across all library resources and EBSCO's content and feature-rich technology platforms serve the needs of researchers at all levels.

35 - Education Networks of America

Brandon Calhoun, Jonathan Bain, Mark Smith

678-999-7773

bcalhoun@ena.com

<http://www.ena.com>

<http://www.facebook.com/ENACnects>

<http://www.twitter.com/enacnects>

ENA delivers high-capacity broadband, Wi-Fi/LAN, and communication solutions to K-12 schools, higher education institutions and libraries nationwide.

82 - ELM-USA Disc Repair

Keith McLaughlin

847-243-4150

kmclaughlin@elm-usa.com

<http://www.elm-usa.com>

<http://www.facebook.com/dvdrepair>

Affordable "pay per disc repair" is here! Free machine, free ongoing supplies, lifetime warranty. ELM-USA gives you a choice...get the service, support and pricing you deserve.

8 - Epsten Group

Michele Rall

404-577-0370

mrall@epstengroup.com

<http://www.epstengroup.com>

<http://www.facebook.com/TheEpstenGroup>

<http://www.twitter.com/EpstenGroup>

Epsten Group provides architecture, interior design, sustainable design, green building consulting, LEED consulting, and commissioning.

68 - Eschenbach Optik

Stacy Fortney

800-487-5389

sfortney@eschenbach.com

<http://www.eschenbach.com>

Eschenbach offers a complete line of video magnifiers and optical vision aids to help seniors and the visually impaired population read. Desktop and portable video magnifiers are available, plus our MagniLink Voice reading machine.

25 - Friends of Georgia Libraries (FOGL)

Keith Schuermann

kdschuermann@gmail.com

28 - Gale-Cengage Learning

George Duncan, Matt Hancox, Jackie Sullivan

678-215-6028

george.duncan@cengage.com

<http://www.gale.com>

For more than 60 years, Gale, a Cengage company has partnered with libraries around the world to empower the discovery of knowledge and insights by all people, for all purposes. Knowledge is power, and the act of learning is empowering. Access to knowledge offers learners an opportunity to discover the motivation and inspiration vital to making a positive contribution in not only their own lives, but the rest of the world. That's why Gale provides libraries with original and curated content, as well as the modern research tools that are crucial in connecting libraries to learning, and learners to libraries.

2016 EXHIBITORS

74 - GALILEO - Georgia's Virtual Library

Karen Minton
706-583-2141
karen.minton@usg.edu
<http://www.galileo.usg.edu>
<https://www.facebook.com/galileolibrary>
<http://www.twitter.com/galileolibrary>
GALILEO, Georgia's Virtual Library, provides premier electronic resources and services to Georgia citizens through their libraries and educational institutions.

1 - Garrett Book Company

Maria Almeida, Meri Lee Testa, Cal Conant
800-475-6884
mail@garrettbooks.com
<http://www.garrettbooks.com>
Garrett Book Company distributes PK-12 fiction and nonfiction library edition titles with the latest copyrights. We provide complete shelf-ready processing and excellent customer service.

50 - Georgia Association for Instructional Technology, Inc. (GAIT)

<http://www.gait-inc.org/>

38 - Georgia Library Association (GLA)

<http://gla.georgialibraries.org/>

85 - Georgia Public Library Service

David Baker, Dustin Landrum
404-235-7131
dbaker@georgialibraries.org
<http://www.georgialibraries.org>
<https://www.facebook.com/georgialibraries>
<http://www.twitter.com/georgialibs>

30 - Grey House & Financial Ratings Series

Donna Valletta
ratings@greyhouse.com
<http://www.greyhouse.com>
Authoritative reference works in print and online covering business, health, statistics, demographics and financial literacy tools.

61 - Imasoldes, LLC

Beth Fine, Chelsea Fine Watkinson
678-772-5596
beth@imapurple.net
<http://www.picaresqueofimaginepurple.com>
http://www.twitter.com/beth_fine
The Picaresque of Imagine Purple is a middle school mystery series set in the issues of 1969-70. Ima Purple, a teacher-turned-detective, meets many rascals who try to thwart her investigations. Written in the educational fiction genre but with a motto of "Have Fun-Get Smart," each adventure offers appendices to explore or ignore: character biographies, idioms/clichés/phrases explained, lookup suggestions to research, and PSAT level vocabulary defined.

27 - Ingram Content Group

Jamie Cutlip
813-508-6743
jamie.cutlip@ingramcontent.com
<http://www.ingramcontent.com/libraries>
<http://www.facebook.com/IngramContent>
<http://www.twitter.com/IngramContent>

78 - LIAT Furniture

Brent Mintz
770-973-0029
bmintz@liatfurniture.com
<http://www.liatfurniture.com>
Libraries, computer labs, media centers, training facilities, classrooms, public spaces.

75 - LYRASIS

Teddy Gray, Lisa Larson
800-999-8558
teddy.gray@lyrasis.org
<http://www.lyrasis.org>
<https://www.facebook.com/wearelyrasis>
<http://www.twitter.com/lyrasis>
LYRASIS, a 501(c)(3) non-profit membership organization, partners with member libraries, archives and museums to create, access and manage information with an emphasis on digital content, while building and sustain collaboration, enhancing operations and technology, and increasing buying power.

33 - Mango Languages

Amy Janczarek
248-254-7450
amy.janczarek@mangolanguages.com
<http://mangolanguages.com/>
<https://www.facebook.com/MangoLanguages>
<http://www.twitter.com/mangolanguages>
Mango Languages is the leading provider of language learning resources in North American libraries

6 - McMillan Pazdan Smith Architecture

Joe Alcock, David Moore
864-242-2033
dmoore@mcmillanpazdansmith.com
<http://www.mcmillanpazdansmith.com>
McMillan Pazdan Smith Architecture is a studio-based, award-winning firm supporting a southeastern clientele with full-series architecture, planning and interior design services. McMillan Pazdan Smith represents a collaborative group of dedicated and enthusiastic design professionals that believe function, beauty, constructability, and cost effectiveness are integral attributes of excellent design.

2 - Mergent, Inc.

Greg Sumner, Victoria Poole
800-664-2029
greg.sumner@mergent.com
<http://www.mergent.com>
<http://www.twitter.com/MergentInc>
For over 100 years, Mergent has been a leading provider of business and financial information on global, publically, and privately listed companies. Mergent is known as a trusted partner to academic, corporate and financial professionals and institutions globally.

43 - Middle Tennessee State University MLS Program

Kathryn Boudreau, Amy Cheatham, Frank Lambert
615-308-1440
kathryn.boudreau-henry@mtsu.edu
<http://www.mtsu.edu/programs/library-science-mls/MLSProgram>.

36 - Milner, Inc.

Steve Baker, Tom Tyler
770-734-5305
sbaker@milner.com
<http://www.milner.com>
Digital microfilm scanner and overhead book scanner.

63 - Mumford Library Books

Bryron Rocher, Doug McNamara
904-737-2649
dougmcn@mumford.fdn.com
Hands on book selection from our facility.

42 - P. V. Supa, Inc. / SmartBlock

Loren L. Pinkerman, Janne Orava
706-302-1871
loren.pinkerman@pv-supa.com
<http://www.pv-supa.com>
The SmartBlock provides a quiet, comfortable workspace for meetings, collaboration, or individual work. Self-contained and fully connected, the SmartBlock is easily repositioned or relocated. Insulated walls and interior walls covered with custom selected fabrics make for a quiet respite in an otherwise busy or noisy environment. SmartBlock is designed in Finland and recently introduced to the USA market.

66 - Patterson Pope, Inc.

Dick Beery, Victoria Campbell
770-955-5025, ext. 6513
dbeery@pattersonpope.com
www.pattersonpope.com
Patterson Pope specializes in records management, storage and filing systems, software, modular mill work, and active document management systems.

69 - Peachtree Publishers

Laura Palermo
404-876-8761
palmero@peachtree-online.com
<http://www.peachtree-online.com>
<http://www.facebook.com/PeachtreePub>
<http://www.twitter.com/PeachtreePub>
Peachtree Publishers is an independently-owned trade book publisher specializing in quality children's, middle readers, and young adult literature. We also maintain a line of adult backlist titles. Our mission is to create books that captivate and educate, with well-crafted words and pictures.

51 - Peak Ryzex/Manage Mobility

Tracy Srooks, Scott Bennett
941-539-0918
scott.bennett@managemobility.com
<http://www.managemobility.com>
Wireless services including internet access, internet hotspots, checkout programs.

2016 EXHIBITORS

58 - Quality Books, Inc.

John Higgins, Norma Higgins
800-323-4241
higgins4books@live.com
<http://www.qbibooks.com>
Quality Books Inc. specializes in distributing small press print and non-print materials to libraries. We offer approval, annotation, standing order plans, and shelf-ready library processing.

62 - Rainbow Book Company

Perri Dauge, Tim Carlmark
847-726-9930
sales@rainbowbookcompany.com
<http://www.rainbowbookcompany.com>
Distributor of children's books K through 12, offering bilingual and Spanish titles, easy readers, Accelerated Readers, and E-books. Processing and shelf ready available.

80 - Recorded Books

Brian Gilbert
800-638-1304
bgilbert@recordedbooks.com
<http://www.recordedbooks.com>
<http://www.facebook.com/recordedbooks>
<http://www.twitter.com/recordedbooks>
Recorded Books is the largest independent publisher of unabridged audiobooks and provider of digital media to the library market. The company owns an exclusive catalog of more than 27,000 audiobook titles and also provides digital audiobooks and eBooks, as well as other compelling third-party content, including digital magazines, comics and films.

84 - Robin Mellom Books

Fred Clarke, Carolyn Clarke
770-993-0219
librarybookdonations@gmail.com
<http://www.ourdaughterwrites.com>
<http://www.facebook.com/OurDaughterWrites>
<http://www.twitter.com/RobinMellomBks>
Robin Mellom is the best selling author of books for children, preteens, and teens, published by Disney-Hyperion, HarperCollins, and Houghton Mifflin Harcourt. Her father, Fred Clarke, has donated thousands of her books to public and school libraries in the southeast. Visit our booth to receive copies of Robin's latest books.

56 and 47 - Source Interiors, Inc

Mark Patterson
864-354-5093
markp@sourceinteriors.net
<http://www.sourceinteriors.net>
Library furniture, shelving, seating.

67 - Southeastern Library Association (SELA)

<http://selaonline.org/>

5 - Southern Mississippi School of Library and Information Science

Ashely Dees, Melissa Dennis
601-266-4228
slis@usm.edu
<http://www.usm.edu/library-information-science>
<http://www.facebook.com/SchoolofLibraryandInformationScienceofSouthernMiss>
<http://www.twitter.com/USMSLIS>
The Southern Miss School of Library and Information Science sponsors the Fay B. Kaigler Children's Book Festival and offers an online BS and MLIS program with no out of state fees. Certificate programs also offered online.

31 - Taylor and Francis

Corey Worthington
800-272-7737
corey.worthington@taylorandfrancis.com
<http://www.crcpress.com>
Publishing company.

32 - Teachers Retirement System of Georgia (TRS)

Michael Zarem
404-425-6616
mike.zarem@trsga.com
<http://www.trsga.com>
TRS provides the full range of pension benefit services for Georgia's public school teachers, covered employers, and related organizations.

4 - TEI Landmark Audio

Ke'el Edwards
800-850-1701
kedwards@teilandmarkaudio.com
<http://www.teilandmarkaudio.com>
<http://www.facebook.com/teilandmarkaudio>
<http://www.twitter.com/teilandmark>
CD, MP3 and Playaway audiobook sales and leasing plans, as well as children's literacy and "New" ESL learning tools.

26 - Thriftbooks Global, LLC

Patrick Stultz, Mike Martin
770-667-9911
pstultz@thriftbooks.com
<http://www.thriftbooks.com/library>
<http://www.facebook.com/thriftbooks>
<http://www.twitter.com/thriftbooksusa>
Thriftbooks works with libraries, friends groups foundations and charities to resell their used, weeded, discarded and donated books. Nobody sells more used books than Thriftbooks.

79 - TLC - The Library Corporation

Don West
304-229-0100
dwest@tlcdelivers.com
<http://www.tlcdelivers.com>
Family owned, The Library Corporation has operated without interruption since 1974 providing automation and cataloging solutions and unparalleled customer support and assistance to more than 4,500 libraries worldwide.

60 - Today's Business Solutions

David Parks, Nathan Handlon, Lou Flavio
630-537-1370
tradeshows@singlecard.com
<http://www.singlecard.com>
<http://www.facebook.com/Todaysbusinesssolutions>
http://www.twitter.com/TBS_Singlecard
TBS offers high-tech library solutions that enhance the patron experience including computer reservation, mobile printing, print management, scanning solutions and secure account based payment methods including Patron Web Portal for all Printing, Computer Management, Fees/ Fines Payment with Secure PCI Compliant Credit/Debit Card solutions.

3 - University of Kentucky School of Information Science

Ashley DeWitt
859-218-2290
ashdewitt@uky.edu
<http://ci.uky.edu/sis/libsci>
<https://www.facebook.com/UK.SLIS>
https://twitter.com/UK_SLIS
UK SIS offers two master's degrees: a highly-ranked ALA-accredited master's program in Library and Information Science and a new program in Information Communication Technology. The MLS program can be completed entirely online. Some of the tracks are health information, information systems, public libraries, academic libraries, and school librarianship. The ICT program is a residential program and includes tracks in policy and regulation, technology and analytics, and health.

83 - University of South Carolina School of Library and Information Science

Nonie Price
803-777-3858
nprice@sc.edu
<http://www.sc.edu/cic>
The School of Library and Information Science at the University of South Carolina offers bachelors, masters, and PhD degrees. Courses are offered both online and on-campus.

45 - Valdosta State University Dept of Library & Information Studies

Linda Most
229-333-5966
lrmmost@valdosta.edu
<http://www.valdosta.edu/mlis>
MLIS Degree Program

7 - Wolters Kluwer

Tommy Smith
615-332-4760
thomas.smith@wolterskluwer.com
<http://www.wolterskluwer.com>
Bates visual guide to physical examination, visible body, law health library, Acland's video atlas of human anatomy.



REINVENT
REIMAGINE
REDISCOVER

LIBRARIES

EXHIBIT HALL FLOOR PLAN

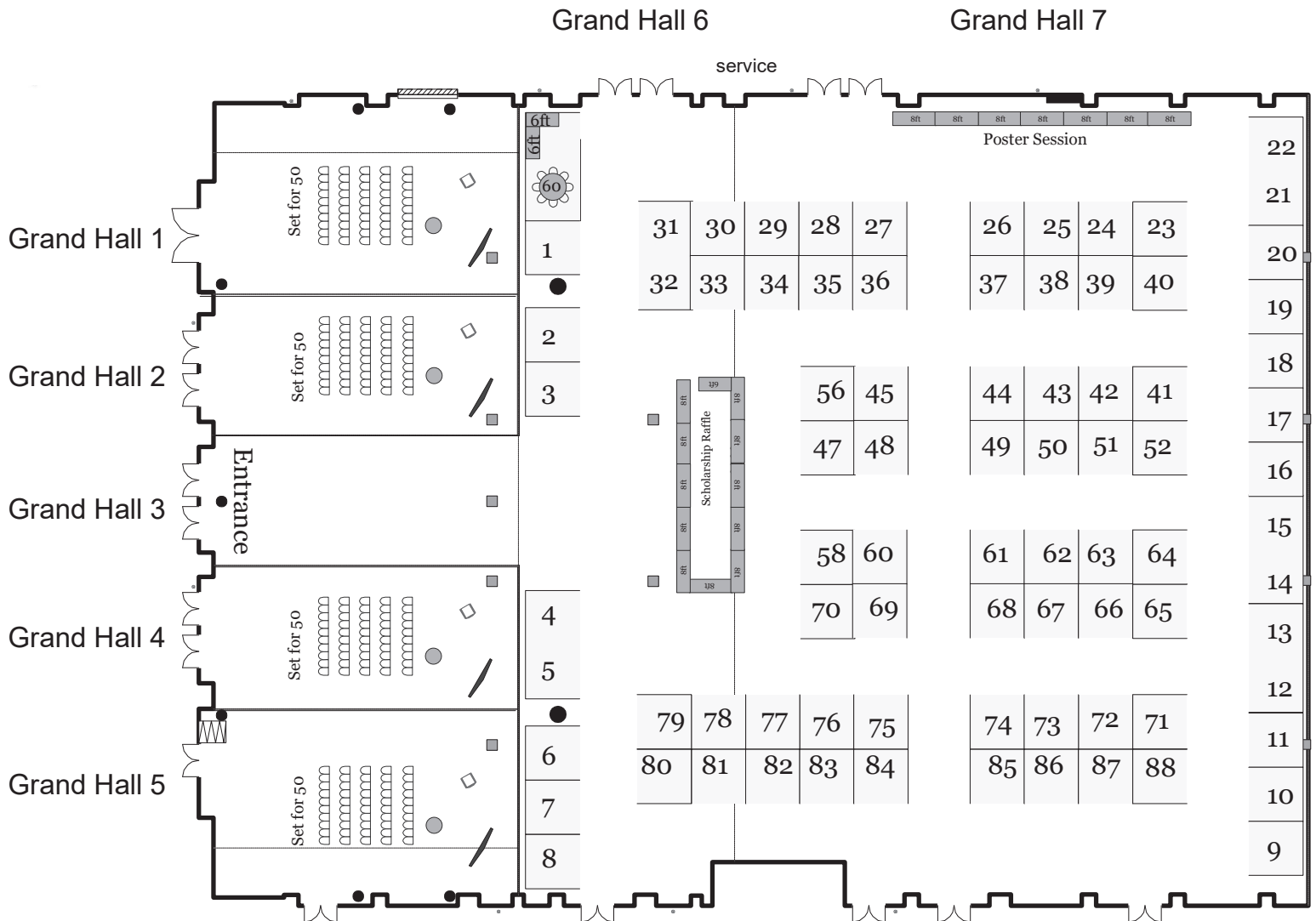



REINVENT
REIMAGINE
REDISCOVER

LIBRARIES

CONVENTION CENTER LAYOUT

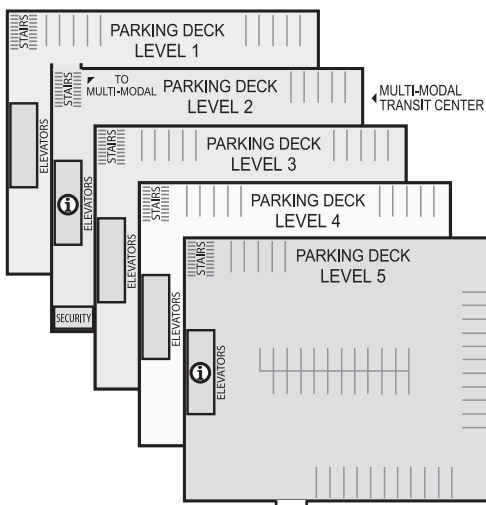
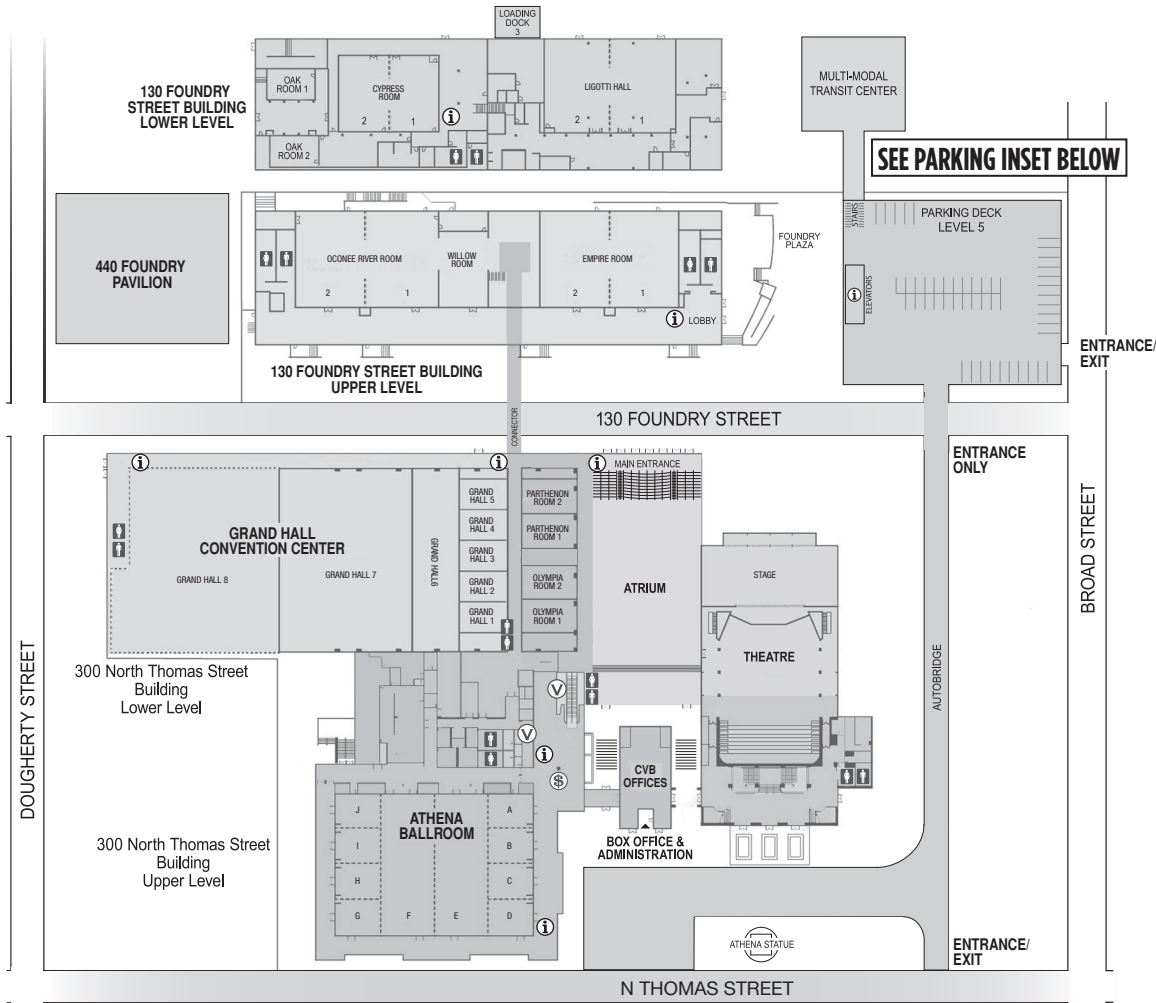

300 NORTH THOMAS STREET BUILDING - UPPER LEVEL

Theatre Lobby
Box Office & Administration
Parking Deck Level 5
Loading Dock 1

300 NORTH THOMAS STREET BUILDING - LOWER LEVEL

130 FOUNDRY STREET BUILDING - UPPER LEVEL
Theatre-Orchestra Level
Parking Deck Level 2
Loading Dock 2 & 4
Multi-Modal Transit Center

130 FOUNDRY STREET BUILDING - LOWER LEVEL

Parking Deck Level 1
Loading Dock 3

-  INFORMATION CENTER
-  ATM
-  RESTROOMS
-  VENDING



PLANNING COMMITTEE

GORDON BAKER

Conference Co-Chair, GAIT President, Clayton State University

CATHY JEFFREY

Conference Co-Chair, GLA President, Clayton State University, Retired

LAURA HERNDON

Conference Treasurer, GAIT Treasurer, Clayton State University

BETH MCINTYRE

Authors' Reception Chair, Piedmont Library System

MIRIAM NAUENBURG

Awards Chair, University of West Georgia

ELIZABETH MCKINNEY

Carterette Run Chair, GLA President-Elect,
Georgia Public Library Service

MICKI WALDROP

Catering & Local Arrangements Chair

PAOLO GUJILDE

Equipment Chair, Georgia Southern University

ELI ARNOLD

Exhibits Chair, Oglethorpe University

RU-STORY HUFFMAN

Keynote Speaker & Luncheon Speakers Co-Chair,
Georgia Southwestern State University

CAROL STANLEY

Movie Night Chair, Athens Technical College

CAMILLE MCCUTCHEON

Partnership/Sponsorship Co-Chair, SELA President,
University of South Carolina Upstate

JEAN COOK

Program Chair, University of West Georgia

AMY BURGER

Public Relations, Co-Chair, Dalton State College

ARIEL TURNER

Public Relations, Co-Chair, Kennesaw State University

ANGELA MEGAW

Registration Chair, University of North Georgia

RITA SPISAK

GLA SELA Representative, Kennesaw State University

LINDA HARRIS

SELA President-Elect, University of Alabama Birmingham, Retired

MELISSA DENNIS

SELA Secretary, University of Mississippi

BEVERLY JAMES

SELA Treasurer, Greenville County Public Library, South Carolina

KAT GREER

Georgia Gwinnett College

SOFIA SLUTSKAYA

Georgia Institute of Technology

CHRISTINA HOLM

Kennesaw State University

JILL PROUTY

Peachtree City Library

SARAH GOURLEY

University of West Georgia

MAKE PLANS NOW

To join us
for the 1st annual

GEORGIA LIBRARIES CONFERENCE

October 4-6, 2017

Columbus Convention & Trade Center
Columbus, GA